

amabhydraul.se

AMAB
Hydraul

Slangkoppling 2021

Slangkoppling 2021

AMAB
Hydraul

Malmö, Huvudkontor och lager, 040-615 50 00
Borlänge 0243-820 55 | Stockholm 08-121 582 00
Trollhättan 0520-42 61 00 | Umeå 090-13 02 80

AMAB
Hydraul

Med reservation för eventuella tryckfel och konstruktionsändringar © AMAB Hydraul AB 2021

INNEHÅLL

Sida	63	Inledning
	64	Presshylsor MF2000
	67	Pressnipplar, BSP gängor MF2000
	77	Pressnipplar, Metriska gängor MF2000
	90	Pressnipplar, JIC gängor MF2000
	96	Pressnipplar, ORFS gängor MF2000
	101	Pressnipplar, Flänsar MF2000 107 Flänshalvor, Helflänsar
	109	Pressnipplar, SAE, NPSM gängor MF2000
	112	Pressnipplar, JIS gängor MF2000
	114	Pressnipplar, Flänsar Komatsu MF2000
	115	Pressnipplar, Fransk metrisk MF2000
	117	Pressnipplar, Flänsar Supercat MF2000
	119	Pressnipplar, Banjo MF2000, Banjobult
	121	Pressnipplar, Övriga MF2000
	122	Pressnipplar, WEO
	126	Interlock Plus, Hylsor
	127	Interlock Plus, BSP gängor
	129	Interlock Plus, Metriska gängor
	131	Interlock Plus, JIC gängor
	133	Interlock Plus, ORFS gängor
	135	Interlock Plus, Flänsar 138 Flänshalvor, Helflänsar
	142	Spiralfit, Hylsor
	143	Spiralfit, BSP gängor
	145	Spiralfit, Metriska gängor
	147	Spiralfit, JIC gängor
	149	Spiralfit, ORFS gängor
	151	Spiralfit, Flänsar 155 Flänshalvor, Helflänsar
	159	Pushlock
	160	Rotofit
	163	Teknisk information

SLANGKOPPLINGAR



Inledning

Manuli Hydraulics är globalt respekterad för ett brett och mångsidigt program av slangkopplingar. Omfattande över 6000 artikelnummer finns det kopplingar som passar de flesta internationella standarder såväl som speciella behov efterfrågade av viktiga OEM kunder.

Manuli slangkopplings Sortiment består av: MF2000 och Innovativa kopplingslösningar.

MF2000 innehåller kärnan av produktprogram för tvådelade kopplingar och består av mer än 4000 artikelnummer.

MF2000 (MF) - Enkel och kostnadseffektiv universallösning för stålfletad och spiralarmerad slang.

Interlock Plus (IP) - Maximal pålitlighet för mycket höga tryck till spiralslangar med svåra applikationer.

Interlock Super (IS) - Högteknologisk presskoppling för stora dimensioner av spiralslangar.

Spiralfit (SP) - Skalfria kopplingar för spiralslangar och stora slangdimensioner.

Pushlock (PL) - Kopplingslösning för lågtrycksslangar utan behov av presshylsor.

Sortimentet av Innovativa kopplingslösningar innehåller:

RotoFit - Manulis patenterade lösning konstruerad för att eliminera slangvridningar som kan orsaka förtidiga slaghaverier.

WEO/ EasyFit - Manulis kopplingslösning utan gängor för snabb och enkel installation av slangenheter.

4710/ 3410 Skalhylsa, flätad slang

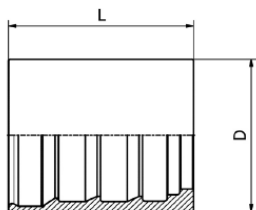

Art.nr.	Slangdim.		Dimensioner							
	DN	Tum			D	L				
4710-03	5	3/16"			17,0	23,9				
4710-04	6	1/4"			19,5	28,0				
4710-05	8	5/16"			20,0	28,6				
4710-06	10	3/8"			23,0	30,0				
4710-08	12	1/2"			26,7	32,0				
4710-10	16	5/8"			32,0	38,0				
4710-12	19	3/4"			35,8	41,7				
4710-16	25	1"			43,0	47,0				
3410-20	31	1.1/4"			50,5	59,0				
3410-24	38	1.1/2"			57,0	70,0				
3410-32	51	2"			70,0	72,0				

2410 Skalhylsa, flätad och spiralslang

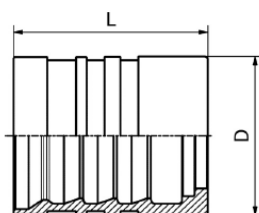

Art.nr.	Slangdim.		Dimensioner							
	DN	Tum			D	L				
2410-03	5	3/16"			20,6	26,0				
2410-04	6	1/4"			22,0	30,0				
2410-05	8	5/16"			24,0	31,0				
2410-06	10	3/8"			26,0	33,0				
2410-08	12	1/2"			30,0	34,0				
2410-10	16	5/8"			33,0	39,0				
2410-12	19	3/4"			38,0	40,0				
2410-16	25	1"			46,0	54,0				
2410-20	31	1.1/4"			57,0	60,0				
2410-24	38	1.1/2"			65,0	70,0				
2410-32	51	2"			79,0	72,0				
2415-12	19	3/4"			38,0	40,0				

4810 Skalfri hylsa, flätad slang

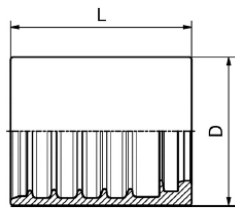

Art.nr.	Slangdim.		Dimensioner							
	DN	Tum			D	L				
4810-03	5	3/16"			19,2	22,0				
4810-04	6	1/4"			20,5	27,5				
4810-05	8	5/16"			22,8	28,5				
4810-06	10	3/8"			25,0	30,0				
4810-08	12	1/2"			28,0	33,0				

2610 Skalfri hylsa, flätad slang

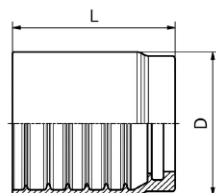

Art.nr.	Slangdim.		Dimensioner							
	DN	Tum			D	L				
2610-03	5	3/16"			21,0	23,0				
2610-04	6	1/4"			23,0	30,1				
2610-05	8	5/16"			24,0	30,0				
2610-06	10	3/8"			26,0	31,1				
2610-08	12	1/2"			29,0	34,0				
2615-08	12	1/2"			30,3	31,0				
2610-10	16	5/8"			33,0	37,0				
2610-12	19	3/4"			37,0	42,0				
2610-16	25	1"			46,0	50,7				
2610-20	31	1.1/4"			59,0	57,2				
2610-24	38	1.1/2"			67,0	64,8				
2610-32	51	2"			80,0	68,3				
2610-38	60	2.3/8"			82,5	69,0				
2610-40	63	2.1/2"			88,2	68,8				
2610-48	76	3"			103,0	75,0				
2610-56	89	3.1/2"			123,4	91,0				

3810 Skalfri hylsa för kompaktslangar

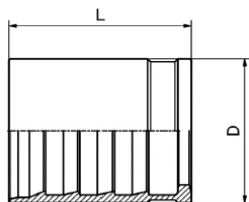

Art.nr.	Slangdim.		Dimensioner							
	DN	Tum			D	L				
3810-03	5	3/16"			14,0	26,4				
3810-04	6	1/4"			18,0	29,6				
3810-05	8	5/16"			19,0	31,9				
3810-06	10	3/8"			22,0	32,9				
3810-08	12	1/2"			26,0	33,9				
3810-10	16	5/8"			29,0	35,9				
3810-12	19	3/4"			33,0	41,7				
3810-16	25	1"			41,0	49,7				
3810-20	31	1.1/4"			48,0	57,0				
3810-24	38	1.1/2"			55,5	66,0				
3810-32	51	2"			68,6	70,0				

3710 Skalfri hylsa för textilarmerad slang

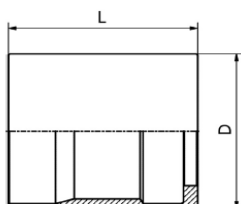

Art.nr.	Slangdim.		Dimensioner							
	DN	Tum			D	L				
3710-03	5	3/16"			17,5	27,0				
3710-04	6	1/4"			19,3	30,0				
3710-05	8	5/16"			21,0	32,0				
3710-06	10	3/8"			24,0	32,0				
3710-08	12	1/2"			28,4	34,0				
3710-10	16	5/8"			33,0	37,0				
3710-12	19	3/4"			37,0	43,0				
3710-16	25	1"			43,5	51,0				
3710-20	31	1.1/4"			50,0	59,0				

Invändig R-gänga 60° kona, BS5200 /ISO 12151-6

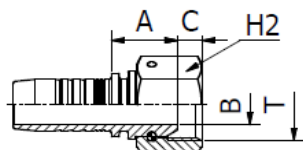

Stiftad mutter



Slip-on mutter

Art.nr.	Slangdim.		Gänga	Dimensioner							
	DN	Tum		T	B	A	C	H2	Mutter		
4501-02-03	5	3/16"	1/8"-28		3,0	16,0	4,4		14,0		ST
4501-04-03	5	3/16"	1/4"-19		4,0	16,5	5,4		19,0		SL
4501-02-04	6	1/4"	1/8"-28		3,1	16,5	4,4		14,0		ST
4501-04-04	6	1/4"	1/4"-19		4,0	17,0	5,4		19,0		SL
4501-06-04	6	1/4"	3/8"-19		7,0	19,0	6,0		22,0		SL
4501-08-04	6	1/4"	1/2"-14		9,5	19,5	6,3		27,0		SL
4501-04-05	8	5/16"	1/4"-19		4,1	17,5	4,2		19,0		ST
4501-06-05	8	5/16"	3/8"-19		7,0	19,0	6,0		22,0		SL
4501-08-05	8	5/16"	1/2"-14		9,3	20,5	6,3		27,0		SL
4501-04-06	10	3/8"	1/4"-19		4,1	18,0	4,2		19,0		ST
4501-06-06	10	3/8"	3/8"-19		7,0	19,5	6,0		22,0		SL
4501-08-06	10	3/8"	1/2"-14		9,3	20,0	6,3		27,0		SL
4501-06-08	12	1/2"	3/8"-19		7,1	21,0	6,0		22,0		ST
4501-08-08	12	1/2"	1/2"-14		9,3	20,5	6,3		27,0		SL
4501-10-08	12	1/2"	5/8"-14		12,1	22,0	10,2		28,0		ST
4501-12-08	12	1/2"	3/4"-14		15,0	24,5	9,0		32,0		ST
4501-08-10	16	5/8"	1/2"-14		9,8	24,0	6,5		27,0		ST
4501-10-10	16	5/8"	5/8"-14		12,5	21,5	10,2		28,0		ST
4501-12-10	16	5/8"	3/4"-14		15,0	23,0	9,0		32,0		ST
4501-08-12	19	3/4"	1/2"-14		9,8	25,0	6,5		27,0		ST
4501-12-12	19	3/4"	3/4"-14		15,0	24,5	9,0		32,0		ST
4501-16-12	19	3/4"	1"-11		19,8	26,0	10,5		38,0		ST
4501-12-16	25	1"	3/4"-14		15,0	25,5	9,0		32,0		ST
4501-16-16	25	1"	1"-11		19,8	27,5	10,5		38,0		ST

Muttertyp: ST = Stiftad, SL = Slip-on

90° invändig R-gänga 60° kona, BS5200 /ISO 12151-6

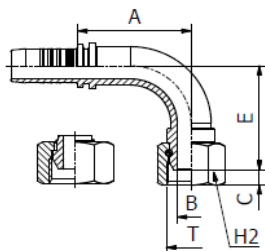

Art.nr.	Slangdim.		Gänga	Dimensioner							Mutter
	DN	Tum		T	B	A	C	E	H2		
4503-02-03	5	3/16"	1/8"-28		3,0	21,5	4,4	26,0	14,0		ST
4503-04-03	5	3/16"	1/4"-19		4,0	29,0	5,4	29,0	19,0		SL
4503-02-04	6	1/4"	1/8"-28		3,1	28,5	4,4	27,0	14,0		ST
4503-04-04	6	1/4"	1/4"-19		4,0	29,5	5,4	29,0	19,0		SL
4503-06-04	6	1/4"	3/8"-19		7,0	29,5	6,0	31,0	22,0		SL
4503-04-05	8	5/16"	1/4"-19		4,0	26,5	4,1	29,5	19,0		ST
4503-06-05	8	5/16"	3/8"-19		7,0	32,0	6,0	27,5	22,0		SL
4503-08-05	8	5/16"	1/2"-14		9,3	36,5	6,3	32,0	27,0		SL
4503-04-06	10	3/8"	1/4"-19		4,0	27,0	4,1	29,5	19,0		ST
4503-06-06	10	3/8"	3/8"-19		7,0	36,5	6,0	31,5	22,0		SL
4503-08-06	10	3/8"	1/2"-14		9,3	36,5	6,3	32,0	27,0		SL
4503-06-08	12	1/2"	3/8"-19		7,1	45,0	6,0	41,0	22,0		ST
4503-08-08	12	1/2"	1/2"-14		9,3	45,0	6,3	36,5	27,0		SL
4503-10-08	12	1/2"	5/8"-14		12,1	44,0	10,2	44,0	28,0		ST
4503-12-08	12	1/2"	3/4"-14		15,0	44,0	9,0	45,5	32,0		ST
4503-08-10	16	5/8"	1/2"-14		9,3	53,5	6,5	54,5	27,0		ST
4503-10-10	16	5/8"	5/8"-14		12,5	53,5	10,2	53,5	28,0		ST
4503-12-10	16	5/8"	3/4"-14		15,0	53,5	9,0	55,0	32,0		ST
4503-08-12	19	3/4"	1/2"-14		9,8	45,5	6,5	44,0	27,0		ST
4503-12-12	19	3/4"	3/4"-14		15,0	61,5	9,0	59,5	32,0		ST
4503-16-12	19	3/4"	1"-11		19,8	79,5	10,5	76,0	38,0		ST
4503-12-16	25	1"	3/4"-14		15,0	64,5	9,0	59,5	32,0		ST
4503-16-16	25	1"	1"-11		19,8	79,5	10,5	76,0	38,0		ST

Muttertyp: ST = Stiftad, SL = Slip-on

45° invändig R-gänga 60° kona, BS5200 /ISO 12151-6

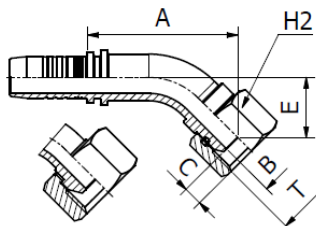

Art.nr.	Slangdim.		Gänga T	Dimensioner						Mutter
	DN	Tum		B	A	C	E	H2		
4504-02-03	5	3/16"	1/8"-28	3,0	31,0	4,4	15,0	14,0	ST	
4504-04-03	5	3/16"	1/4"-19	4,0	35,5	5,4	14,5	19,0	SL	
4504-02-04	6	1/4"	1/8"-28	3,1	35,5	4,4	14,5	14,0	ST	
4504-04-04	6	1/4"	1/4"-19	4,0	36,0	5,4	15,0	19,0	SL	
4504-06-04	6	1/4"	3/8"-19	7,0	37,5	6,0	16,0	22,0	SL	
4504-04-05	8	5/16"	1/4"-19	4,0	35,5	4,1	16,0	19,0	ST	
4504-06-05	8	5/16"	3/8"-19	7,0	38,0	6,0	13,5	22,0	SL	
4504-06-06	10	3/8"	3/8"-19	7,0	42,0	6,0	15,5	22,0	SL	
4504-08-06	10	3/8"	1/2"-14	9,3	42,5	6,3	16,0	27,0	SL	
4504-06-08	12	1/2"	3/8"-19	7,1	52,0	6,0	20,0	22,0	ST	
4504-08-08	12	1/2"	1/2"-14	9,3	49,5	6,3	17,0	27,0	SL	
4504-10-08	12	1/2"	5/8"-14	12,1	54,5	10,2	22,5	28,0	ST	
4504-12-08	12	1/2"	3/4"-14	15,0	57,0	9,0	25,0	32,0	ST	
4504-08-10	16	5/8"	1/2"-14	9,3	63,5	6,5	26,5	27,0	ST	
4504-10-10	16	5/8"	5/8"-14	12,5	63,0	10,2	26,0	28,0	ST	
4504-12-10	16	5/8"	3/4"-14	15,0	64,0	9,0	27,0	32,0	ST	
4504-08-12	19	3/4"	1/2"-14	9,3	55,5	6,5	22,5	27,0	ST	
4504-12-12	19	3/4"	3/4"-14	15,0	70,5	9,0	28,5	32,0	ST	
4504-16-12	19	3/4"	1"-11	19,8	72,5	10,5	30,0	38,0	ST	
4504-16-16	25	1"	1"-11	19,8	91,0	10,5	36,5	38,0	ST	

Muttertyp: ST = Stiftad, SL = Slip-on

Invändig R-gänga 60° kona, BS5200 /ISO 12151-6

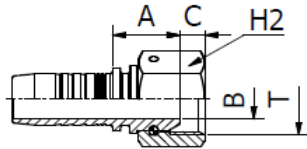

Stiftad mutter

Art.nr.	Slangdim.		Gänga T	Dimensioner						Mutter
	DN	Tum		B	A	C	H2			
4491-04-04	6	1/4"	1/4"-19	4,0	17,5	4,2		19,0		ST
4491-06-06	10	3/8"	3/8"-19	7,0	21,0	6,0		22,0		ST
4491-08-08	12	1/2"	1/2"-14	9,3	23,0	6,3		27,0		ST

90° invändig R-gänga 60° kona, BS5200 /ISO 12151-6

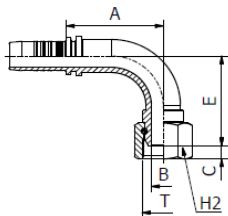

Stiftad mutter

Art.nr.	Slangdim.		Gänga T	Dimensioner						Mutter
	DN	Tum		B	A	C	E	H2		
4493-04-04	6	1/4"	1/4"-19	4,0	26,5	4,1	29,5	19,0		ST
4493-06-06	10	3/8"	3/8"-19	7,0	37,0	6,0	36,5	22,0		ST
4493-08-08	12	1/2"	1/2"-14	9,3	44,0	6,3	44,0	27,0		ST

45° invändig R-gänga 60° kona, BS5200 /ISO 12151-6

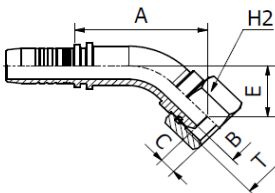

Stiftad mutter

Art.nr.	Slangdim.		Gänga T	Dimensioner						Mutter
	DN	Tum		B	A	C	E	H2		
4494-04-04	6	1/4"	1/4"-19	4,0	35,5	4,1	16,0	19,0		ST
4494-06-06	10	3/8"	3/8"-19	7,0	46,3	6,0	19,0	22,0		ST
4494-08-08	12	1/2"	1/2"-14	9,3	54,0	6,3	22,5	27,0		ST

Invändig R-gänga o-ring 60° kona, BS5200 /ISO 12151-6

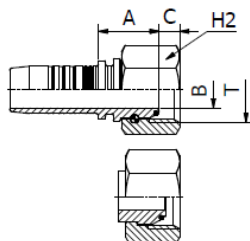

Art.nr.	Slangdim.		Gänga T	Dimensioner						Mutter
	DN	Tum		B	A	C	H2			
4511-04-03	5	3/16"	1/4"-19	4,0	16,5	5,4	19,0	SL		
4511-04-04	6	1/4"	1/4"-19	4,0	17,0	5,4	19,0	SL		
4511-06-04	6	1/4"	3/8"-19	7,0	19,0	6,0	22,0	SL		
4511-04-06	10	3/8"	1/4"-19	4,1	18,0	4,1	19,0	ST		
4511-06-06	10	3/8"	3/8"-19	7,0	19,5	6,0	22,0	SL		
4511-08-06	10	3/8"	1/2"-14	9,3	20,0	6,3	27,0	SL		
4511-08-08	12	1/2"	1/2"-14	9,3	20,5	6,3	27,0	SL		
4511-10-10	16	5/8"	5/8"-14	12,5	22,0	9,7	28,0	ST		
4511-12-12	19	3/4"	3/4"-14	15,0	25,0	8,5	32,0	ST		
4511-12-16	25	1"	3/4"-14	15,0	26,0	8,5	32,0	ST		
4511-16-16	25	1"	1"-11	19,8	27,5	10,6	38,0	ST		
4511-20-16	25	1"	1.1/4"-11	26,1	31,0	10,5	50,0	ST		
4511-16-20	31	1.1/4"	1"-11	19,8	29,0	10,5	38,0	ST		
4511-20-20	31	1.1/4"	1.1/4"-11	26,0	31,5	10,5	50,0	ST		
4511-24-20	31	1.1/4"	1.1/2"-11	32,1	29,5	12,5	60,0	ST		
4511-20-24	38	1.1/2"	1.1/4"-11	26,0	31,5	10,5	50,0	ST		
4511-24-24	38	1.1/2"	1.1/2"-11	32,0	30,5	12,5	60,0	ST		
4511-32-24	38	1.1/2"	2"-11	42,1	30,0	16,1	70,0	ST		
4511-32-32	51	2"	2"-11	42,0	32,0	16,1	70,0	ST		

Muttertyp: ST = Stiftad, SL = Slip-on

90° R-gänga o-ring 60° kona, BS5200 /ISO 12151-6

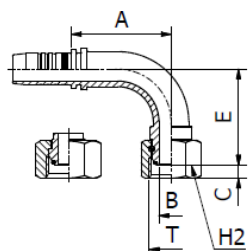

Art.nr.	Slangdim.		Gänga T	Dimensioner						Mutter
	DN	Tum		B	A	C	E	H2		
4512-04-03	5	3/16"	1/4"-19	4,0	29,0	5,4	29,0	19,0	SL	
4512-04-04	6	1/4"	1/4"-19	4,0	29,5	5,4	29,0	19,0	SL	
4512-04-06	10	3/8"	1/4"-19	4,1	35,5	4,1	33,0	19,0	ST	
4512-06-06	10	3/8"	3/8"-19	7,0	36,5	6,0	31,5	22,0	SL	
4512-08-08	12	1/2"	1/2"-14	9,3	45,0	6,3	36,5	27,0	SL	
4512-10-10	16	5/8"	5/8"-14	12,5	53,0	9,7	55,0	28,0	ST	
4512-12-12	19	3/4"	3/4"-14	15,0	61,5	8,5	60,0	32,0	ST	
4512-16-12	19	3/4"	1"-11	19,8	61,5	10,6	62,0	38,0	ST	
4512-12-16	25	1"	3/4"-14	15,0	79,5	8,5	60,0	32,0	ST	
4512-16-16	25	1"	1"-11	19,8	79,5	10,6	76,0	38,0	ST	
4512-20-16	25	1"	1.1/4"-11	26,1	79,5	10,5	78,5	50,0	ST	
4512-16-20	31	1.1/4"	1"-11	19,8	79,5	10,6	76,0	38,0	ST	
4512-20-20	31	1.1/4"	1.1/4"-11	26,0	90,5	10,5	83,5	50,0	ST	
4512-24-20	31	1.1/4"	1.1/2"-11	32,1	90,5	12,5	84,5	60,0	ST	
4512-20-24	38	1.1/2"	1.1/4"-11	26,0	95,0	10,5	90,5	50,0	ST	
4512-24-24	38	1.1/2"	1.1/2"-11	32,0	108,0	12,5	98,5	60,0	ST	
4512-32-24	38	1.1/2"	2"-11	42,1	108,0	16,1	98,0	70,0	ST	
4512-32-32	51	2"	2"-11	42,0	131,0	16,1	110,5	70,0	ST	

Muttertyp: ST = Stiftad, SL = Slip-on

45° R-gänga o-ring 60° kona, BS5200 /ISO 12151-6

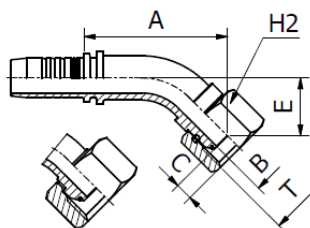

Art.nr.	Slangdim.		Gänga T	Dimensioner						Mutter
	DN	Tum		B	A	C	E	H2		
4508-04-04	6	1/4"	1/4"-19	4,0	36,0	5,4	14,6	19,0	SL	
4508-06-06	10	3/8"	3/8"-19	7,0	42,0	6,0	15,5	22,0	SL	
4508-08-08	12	1/2"	1/2"-14	9,3	49,5	6,3	17,0	27,0	SL	
4508-10-10	16	5/8"	5/8"-14	12,5	63,5	9,7	27,5	28,0	ST	
4508-12-12	19	3/4"	3/4"-14	15,0	71,0	8,5	29,0	32,0	ST	
4508-12-16	25	1"	3/4"-14	15,0	79,5	8,5	29,0	32,0	ST	
4508-16-16	25	1"	1"-11	19,8	90,5	10,6	35,5	38,0	ST	
4508-20-16	25	1"	1.1/4"-11	26,1	93,0	10,5	38,0	50,0	ST	
4508-20-20	31	1.1/4"	1.1/4"-11	26,0	101,5	10,5	39,0	50,0	ST	
4508-24-20	31	1.1/4"	1.1/2"-11	32,1	118,5	12,5	40,5	60,0	ST	
4508-20-24	38	1.1/2"	1.1/4"-11	26,0	106,0	10,5	42,0	50,0	ST	
4508-24-24	38	1.1/2"	1.1/2"-11	32,0	118,0	12,5	45,0	60,0	ST	
4508-32-24	38	1.1/2"	2"-11	42,1	117,5	16,1	44,5	70,0	ST	
4508-32-32	51	2"	2"-11	42,0	134,0	16,1	47,0	70,0	ST	

Muttertyp: ST = Stiftad, SL = Slip-on

90° R-gänga kompakt o-ring 60° kona, BS5200 /ISO 12151-6

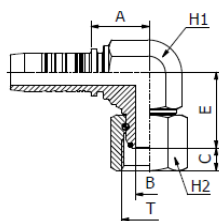

Art.nr.	Slangdim.		Gänga T	Dimensioner						Mutter
	DN	Tum		B	A	C	E	H1	H2	
4509-04-04	6	1/4"	1/4"-19	4,0	20,0	4,1	22,0	14,0	19,0	ST
4509-06-06	10	3/8"	3/8"-19	7,0	23,0	6,0	27,5	19,0	22,0	ST
4509-08-08	12	1/2"	1/2"-14	9,3	25,0	6,5	31,0	22,0	27,0	ST
4509-10-10	16	5/8"	5/8"-14	12,5	24,5	9,7	32,5	24,0	28,0	ST
4509-12-12	19	3/4"	3/4"-14	15,0	37,5	8,5	36,0	27,0	32,0	ST
4509-16-16	25	1"	1"-11	20,0	52,0	10,6	44,0	36,0	38,0	ST

Muttertyp: ST = Stiftad

Utvändig R-gänga 60° kona, BS5200/ ISO 8434-6

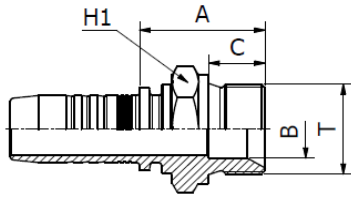

Art.nr.	Slangdim.		Gänga	Dimensioner						
	DN	Tum		T	B	A	C			
4502-02-03	5	3/16"	1/8"-28	3,5	22,5	10,0	14,0			
4502-04-03	5	3/16"	1/4"-19	5,0	25,0	11,0	19,0			
4502-02-04	6	1/4"	1/8"-28	3,5	22,5	10,0	14,0			
4502-04-04	6	1/4"	1/4"-19	5,0	25,5	11,0	19,0			
4502-06-04	6	1/4"	3/8"-19	8,0	27,0	12,0	22,0			
4502-08-04	6	1/4"	1/2"-14	11,0	30,0	14,0	27,0			
4502-04-05	8	5/16"	1/4"-19	5,0	26,0	11,0	19,0			
4502-06-05	8	5/16"	3/8"-19	8,0	27,5	12,0	22,0			
4502-04-06	10	3/8"	1/4"-19	5,0	26,0	11,0	19,0			
4502-06-06	10	3/8"	3/8"-19	8,0	28,0	12,0	22,0			
4502-08-06	10	3/8"	1/2"-14	11,0	30,5	14,0	27,0			
4502-06-08	12	1/2"	3/8"-19	8,0	28,0	12,0	22,0			
4502-08-08	12	1/2"	1/2"-14	11,0	31,0	14,0	27,0			
4502-10-08	12	1/2"	5/8"-14	14,5	33,0	16,0	30,0			
4502-12-08	12	1/2"	3/4"-14	17,0	34,0	16,0	32,0			
4502-10-10	16	5/8"	5/8"-14	14,5	33,0	16,0	30,0			
4502-12-10	16	5/8"	3/4"-14	17,0	35,5	16,0	32,0			
4502-08-12	19	3/4"	1/2"-14	11,0	32,0	14,0	27,0			
4502-12-12	19	3/4"	3/4"-14	17,0	35,5	16,0	32,0			
4502-16-12	19	3/4"	1"-11	22,5	39,5	19,0	41,0			
4502-12-16	25	1"	3/4"-14	17,0	36,5	16,0	32,0			
4502-16-16	25	1"	1"-11	22,5	41,0	19,0	41,0			
4502-20-16	25	1"	1.1/4"-11	28,5	45,0	20,0	50,0			
4502-20-20	31	1.1/4"	1.1/4"-11	28,5	46,5	20,0	50,0			
4502-24-20	31	1.1/4"	1.1/2"-11	33,5	48,5	22,0	55,0			
4502-24-24	38	1.1/2"	1.1/2"-11	33,5	49,5	22,0	55,0			
4502-32-32	51	2"	2"	46,0	54,0	25,0	70,0			

Invändig R-gänga plan tätyta

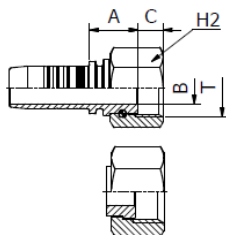

Art.nr.	Slangdim.		Gänga T	Dimensioner						Mutter
	DN	Tum		B	A	C	H2			
4505-04-04	6	1/4"	1/4"-19	4,0	14,5	7,9	19,0	SL		
4505-06-05	8	5/16"	3/8"-19	7,0	16,0	9,0	22,0	SL		
4505-06-06	10	3/8"	3/8"-19	7,0	16,5	9,0	22,0	SL		
4505-08-06	10	3/8"	1/2"-14	9,3	17,5	9,8	27,0	SL		
4505-08-08	12	1/2"	1/2"-14	9,3	18,0	9,8	27,0	SL		
4505-12-08	12	1/2"	3/4"-14	15,0	21,0	11,5	32,0	ST		
4505-12-10	16	5/8"	3/4"-14	15,0	20,5	11,5	32,0	ST		
4505-12-12	19	3/4"	3/4"-14	15,0	22,0	11,5	32,0	ST		
4505-16-12	19	3/4"	1"-11	19,8	23,5	13,0	38,0	ST		
4505-16-16	25	1"	1"-11	19,8	25,0	13,0	38,0	ST		
4505-20-20	31	1.1/4"	1.1/4"-11	26,0	26,0	15,0	50,0	ST		

Mutter: ST = stiftad, SL = slip-on

Utvändig R-gänga plan tätyta

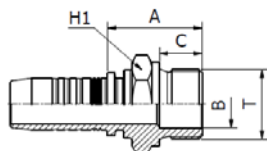

Art.nr.	Slangdim.		Gänga T	Dimensioner					Mutter
	DN	Tum		B	A	C	H1		
4595-04-04	6	1/4"	1/4"-19	6,0	25,5	11,0	19,0		
4595-06-06	10	3/8"	3/8"-19	9,5	28,0	12,0	22,0		
4595-08-06	10	3/8"	1/2"-14	13,0	30,5	14,0	27,0		
4595-08-08	12	1/2"	1/2"-14	13,0	31,0	14,0	27,0		
4595-08-10	16	5/8"	1/2"-14	13,0	31,0	14,0	27,0		
4595-12-12	19	3/4"	3/4"-14	18,0	35,5	16,0	32,0		

Utvändig BSP konisk (KR-gänga), ISO 7

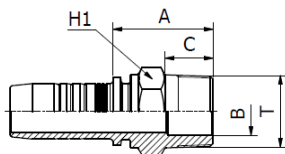

Art.nr.	Slangdim.		Gänga T	Dimensioner						
	DN	Tum		B	A	C	H1			
4506-02-03	5	3/16"	1/8"-28	4,5	20,5	8,0	12,0			
4506-04-03	5	3/16"	1/4"-19	4,5	24,5	12,0	14,0			
4506-02-04	6	1/4"	1/8"-28	4,5	21,0	8,0	12,0			
4506-04-04	6	1/4"	1/4"-19	4,5	25,0	12,0	14,0			
4506-06-04	6	1/4"	3/8"-19	7,0	26,0	12,0	19,0			
4506-08-04	6	1/4"	1/2"-14	10,0	29,5	15,0	22,0			
4506-04-05	8	5/16"	1/4"-14	5,5	25,0	12,0	14,0			
4506-06-05	8	5/16"	3/8"-19	7,0	26,5	12,0	19,0			
4506-08-05	8	5/16"	1/2"-14	10,0	30,0	15,0	22,0			
4506-06-06	10	3/8"	3/8"-19	7,0	27,0	12,0	19,0			
4506-08-06	10	3/8"	1/2"-14	10,0	30,5	15,0	22,0			
4506-04-08	12	1/2"	1/4"-19	4,5	26,0	12,0	19,0			
4506-08-08	12	1/2"	1/2"-14	10,0	31,0	15,0	22,0			
4506-08-10	16	5/8"	1/2"-14	10,0	31,0	15,0	22,0			
4506-12-10	16	5/8"	3/4"-14	17,0	34,0	17,0	27,0			
4506-12-12	19	3/4"	3/4"-14	17,0	35,5	17,0	27,0			
4506-12-16	25	1"	3/4"-14	17,0	38,0	17,0	32,0			
4506-16-16	25	1"	1"-11	22,5	42,0	21,0	36,0			
4506-20-20	31	1.1/4"	1.1/4"-11	28,5	47,5	23,0	46,0			
4506-24-24	38	1.1/2"	1.1/2"-11	32,0	50,0	23,0	50,0			
4506-32-32	51	2"	2"-11	44,0	55,5	27,0	65,0			

Invändig metrisk, DKOL, 24° kona, DIN 20066/ ISO 12151-2

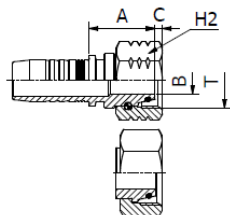

Art.nr.	Slangdim.		Gänga T	Rör mm	Dimensioner					Mutter
	DN	Tum			B	A	C	H2		
4553-06-03	5	3/16"	M 12x1,5	6	3,0	22,0	0,7		14,0	SL
4553-08-03	5	3/16"	M 14x1,5	8	4,0	24,5	1,3		17,0	SL
4553-06-04	6	1/4"	M 12x1,5	6	3,0	21,0	2,2		17,0	ST
4553-08-04	6	1/4"	M 14x1,5	8	4,0	22,0	1,3		17,0	SL
4553-10-04	6	1/4"	M 16x1,5	10	6,0	22,5	1,8		19,0	SL
4553-12-04	6	1/4"	M 18x1,5	12	7,0	22,0	2,0		22,0	SL
4553-08-05	8	5/16"	M 14x1,5	8	4,0	20,0	2,9		17,0	ST
4553-10-05	8	5/16"	M 16x1,5	10	7,0	22,5	1,8		19,0	SL
4553-12-05	8	5/16"	M 18x1,5	12	7,0	22,0	2,0		22,0	SL
4553-10-06	10	3/8"	M 16x1,5	10	6,0	23,0	3,0		19,0	ST
4553-12-06	10	3/8"	M 18x1,5	12	7,0	22,5	2,0		22,0	SL
4553-15-06	10	3/8"	M 22x1,5	15	9,3	25,0	1,5		27,0	SL
4553-12-08	12	1/2"	M 18x1,5	12	7,0	29,0	2,9		22,0	ST
4553-15-08	12	1/2"	M 22x1,5	15	9,3	25,5	1,5		27,0	SL
4553-18-08	12	1/2"	M 26x1,5	18	12,5	26,0	2,0		32,0	SL
4553-12-10	16	5/8"	M 18x1,5	12	7,0	29,0	2,9		22,0	ST
4553-15-10	16	5/8"	M 22x1,5	15	9,5	26,5	2,4		27,0	ST
4553-18-10	16	5/8"	M 26x1,5	18	12,5	26,0	2,0		32,0	SL
4553-22-10	16	5/8"	M 30x2	22	15,0	34,0	3,0		36,0	SL
4553-28-10	16	5/8"	M 36x2	28	20,0	30,5	3,7		41,0	SL
4553-15-12	19	3/4"	M 22x1,5	15	9,5	26,5	2,4		27,0	ST
4553-18-12	19	3/4"	M 26x1,5	18	12,5	31,0	2,3		32,0	ST
4553-22-12	19	3/4"	M 30x2	22	15,0	28,0	3,0		36,0	SL
4553-28-12	19	3/4"	M 36x2	28	20,0	28,5	3,7		41,0	SL
4553-22-16	25	1"	M 30x2	22	15,0	34,0	4,2		36,0	ST
4553-28-16	25	1"	M 36x2	28	19,8	29,5	3,7		41,0	SL
4553-35-16	25	1"	M 45x2	35	26,0	39,0	4,0		50,0	SL
4553-28-20	31	1.1/4"	M 36x2	28	19,8	35,5	5,0		41,0	ST
4553-35-20	31	1.1/4"	M 45x2	35	26,0	33,0	4,0		50,0	SL
4553-42-20	31	1.1/4"	M 52x2	42	32,0	32,5	4,5		60,0	SL
4553-35-24	38	1.1/2"	M 45x2	35	26,0	42,5	5,8		50,0	ST
4553-42-24	38	1.1/2"	M 52x2	42	32,0	33,0	4,5		60,0	SL
4553-42-32	51	2"	M 52x2	42	32,0	50,5	5,6		60,0	ST

Muttertyp: ST = Stiftad, SL = Slip-on

90° inv. metrisk, DKOL, 24° kona, DIN 20066/ ISO 12151-2

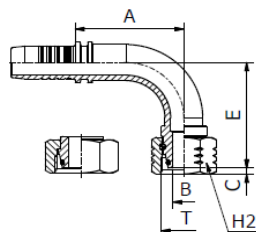

Art.nr.	Slangdim.		Gänga	Rör	Dimensioner					Mutter
	DN	Tum			T	mm	B	A	C	
4554-06-03	5	3/16"	M 12x1,5	6	3,0	26,0	0,7	30,0	14,0	SL
4554-08-03	5	3/16"	M 14x1,5	8	4,0	29,0	1,3	31,5	17,0	SL
4554-06-04	6	1/4"	M 12x1,5	6	3,0	28,5	2,2	32,5	17,0	ST
4554-08-04	6	1/4"	M 14x1,5	8	4,0	29,5	1,3	31,5	17,0	SL
4554-10-04	6	1/4"	M 16x1,5	10	6,0	29,5	1,8	32,0	19,0	SL
4554-12-04	6	1/4"	M 18x1,5	12	7,0	29,5	2,0	33,0	22,0	SL
4554-08-05	8	5/16"	M 14x1,5	8	4,0	31,0	2,9	33,0	17,0	ST
4554-10-05	8	5/16"	M 16x1,5	10	6,0	32,0	1,8	32,5	19,0	SL
4554-12-05	8	5/16"	M 18x1,5	12	7,0	32,0	2,0	32,5	22,0	SL
4554-15-05	8	5/16"	M 22x1,5	15	9,3	36,0	1,5	35,0	27,0	SL
4554-10-06	10	3/8"	M 16x1,5	10	6,0	35,5	3,0	40,0	19,0	ST
4554-12-06	10	3/8"	M 18x1,5	12	7,0	36,5	2,0	33,5	22,0	SL
4554-15-06	10	3/8"	M 22x1,5	15	9,3	36,5	1,5	35,0	27,0	SL
4554-12-08	12	1/2"	M 18x1,5	12	7,0	44,0	2,9	48,0	22,0	ST
4554-15-08	12	1/2"	M 22x1,5	15	9,3	45,0	1,5	39,5	27,0	SL
4554-18-08	12	1/2"	M 26x1,5	18	12,5	45,0	2,0	40,0	32,0	SL
4554-15-10	16	5/8"	M 22x1,5	15	9,3	53,5	3,0	57,5	27,0	ST
4554-18-10	16	5/8"	M 26x1,5	18	12,5	51,5	2,0	53,0	32,0	SL
4554-22-10	16	5/8"	M 30x2	22	15,0	51,5	3,0	54,0	36,0	SL
4554-18-12	19	3/4"	M 26x1,5	18	12,5	61,5	2,3	63,0	32,0	ST
4554-22-12	19	3/4"	M 30x2	22	15,0	61,5	3,0	59,5	36,0	SL
4554-28-12	19	3/4"	M 36x2	28	19,8	61,5	3,7	61,0	41,0	SL
4554-22-16	25	1"	M 30x2	22	15,0	79,5	4,2	80,5	36,0	ST
4554-28-16	25	1"	M 36x2	28	19,8	76,5	3,7	69,5	41,0	SL
4554-35-16	25	1"	M 45x2	35	26,0	79,0	4,0	72,0	50,0	SL
4554-28-20	31	1.1/4"	M 36x2	28	19,8	93,5	5,0	92,0	41,0	ST
4554-35-20	31	1.1/4"	M 45x2	35	26,0	93,5	4,0	81,0	50,0	SL
4554-35-24	38	1.1/2"	M 45x2	28	19,8	93,5	5,0	92,0	41,0	ST
4554-42-24	38	1.1/2"	M 52x2	42	32,0	107,5	4,5	98,0	60,0	SL
4554-42-32	51	2"	M 52x2	42	32,0	131,0	5,6	119,0	60,0	ST

Muttertyp: ST = Stiftad, SL = Slip-on

45° inv. metrisk, DKOL, 24° kona, DIN 20066/ ISO 12151-2

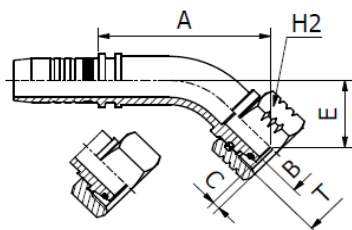

Art.nr.	Slangdim.		Gänga	Rör	Dimensioner						Mutter
	DN	Tum			T	mm	B	A	C	E	
4555-06-03	5	3/16"	M 12x1,5	6	3,0	35,0	0,7	16,0	14,0		SL
4555-06-04	6	1/4"	M 12x1,5	6	3,0	39,0	2,2	18,0	17,0		ST
4555-08-04	6	1/4"	M 14x1,5	8	4,0	38,0	1,3	16,5	17,0		SL
4555-10-04	6	1/4"	M 16x1,5	10	6,0	38,0	1,8	17,0	19,0		SL
4555-12-04	6	1/4"	M 18x1,5	12	7,0	38,5	2,0	17,5	22,0		SL
4555-10-05	8	5/16"	M 16x1,5	10	6,0	41,5	1,8	17,5	19,0		SL
4555-12-05	8	5/16"	M 18x1,5	12	7,0	41,5	2,0	17,0	22,0		SL
4555-10-06	10	3/8"	M 16 x1,5	10	6,0	47,5	3,0	21,5	19,0		ST
4555-12-06	10	3/8"	M 18x1,5	12	7,0	43,5	2,0	16,5	22,0		SL
4555-15-06	10	3/8"	M 22x1,5	15	9,3	45,0	1,5	18,0	27,0		SL
4555-12-08	12	1/2"	M 18x1,5	12	7,0	56,5	2,9	25,0	22,0		ST
4555-15-08	12	1/2"	M 22x1,5	15	9,3	52,0	1,5	19,0	27,0		SL
4555-18-08	12	1/2"	M 26x1,5	18	12,5	52,5	2,0	19,5	32,0		SL
4555-15-10	16	5/8"	M 22x1,5	15	9,3	65,5	3,0	29,0	27,0		ST
4555-18-10	16	5/8"	M 26x1,5	18	12,5	62,0	2,0	26,5	32,0		SL
4555-18-12	19	3/4"	M 26x1,5	18	12,5	73,0	2,3	31,0	32,0		ST
4555-22-12	19	3/4"	M 30x2	22	15,0	71,0	3,0	28,5	36,0		SL
4555-28-12	19	3/4"	M 36x2	28	19,8	72,0	3,7	30,0	41,0		SL
4555-28-16	25	1"	M 36x2	28	19,8	85,0	3,7	32,0	41,0		SL
4555-28-20	31	1.1/4"	M 36x2	28	19,8	107,5	5,0	44,0	41,0		ST
4555-35-20	31	1.1/4"	M 45x2	35	26,0	100,0	4,0	36,0	50,0		SL
4555-42-20	31	1.1/4"	M 52x2	42	32,0	100,0	4,5	42,0	60,0		SL
4555-28-24	38	1.1/2"	M 36x2	28	19,8	113,0	5,0	34,5	41,0		ST
4555-42-24	38	1.1/2"	M 52x2	42	32,0	117,0	4,5	44,5	60,0		SL

Muttertyp: ST = Stiftad, SL = Slip-on

Utvändig metrisk serie L, 24° kona, DIN 20066/ ISO 12151-2

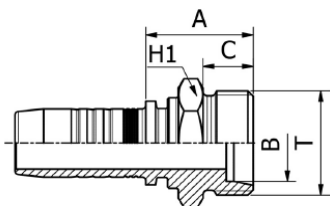

Art.nr.	Slangdim.		Gänga	Rör	Dimensioner						
	DN	Tum			T	mm	B	A			
4513-06-03	5	3/16"	M 12x1,5	6	3,0	21,0	10,0	14,0			
4513-06-04	6	1/4"	M 12x1,5	6	4,0	21,5	10,0	14,0			
4513-08-04	6	1/4"	M 14x1,5	8	4,0	21,5	10,0	14,0			
4513-10-04	6	1/4"	M 16x1,5	10	7,0	23,5	11,0	17,0			
4513-12-04	6	1/4"	M 18x1,5	12	9,0	23,5	11,0	19,0			
4513-10-05	8	5/16"	M 16x1,5	10	7,0	24,0	11,0	17,0			
4513-12-05	8	5/16"	M 18x1,5	12	9,0	24,0	11,0	19,0			
4513-10-06	10	3/8"	M 16x1,5	10	7,0	24,0	11,0	17,0			
4513-12-06	10	3/8"	M 18x1,5	12	9,0	24,5	11,0	19,0			
4513-15-06	10	3/8"	M 22x1,5	15	10,0	25,5	12,0	22,0			
4513-18-06	10	3/8"	M 26x1,5	18	12,5	26,5	12,0	27,0			
4513-10-08	12	1/2"	M 16x1,5	10	7,0	24,5	11,0	22,0			
4513-12-08	12	1/2"	M 18x1,5	12	9,3	24,5	11,0	22,0			
4513-15-08	12	1/2"	M 22x1,5	15	10,0	25,5	12,0	22,0			
4513-18-08	12	1/2"	M 26x1,5	18	12,5	26,5	12,0	27,0			
4513-15-10	16	5/8"	M 22x1,5	15	10,0	25,5	12,0	22,0			
4513-18-10	16	5/8"	M 26x1,5	18	12,5	26,5	12,0	27,0			
4513-22-10	16	5/8"	M 30x2	22	15,0	28,5	14,0	30,0			
4513-18-12	19	3/4"	M 26x1,5	18	15,0	28,0	12,0	27,0			
4513-22-12	19	3/4"	M 30x2	22	15,0	30,0	14,0	30,0			
4513-28-12	19	3/4"	M 36x2	28	19,8	31,0	14,0	36,0			
4513-28-16	25	1"	M 36x2	28	19,8	32,5	14,0	36,0			
4513-35-20	31	1.1/4"	M 45x2	35	26,0	40,5	16,0	46,0			
4513-42-24	38	1.1/2"	M 52x2	42	32,0	43,0	16,0	55,0			

Invändig metrisk, DKOS, 24° kona, DIN 20066/ ISO 12151-2

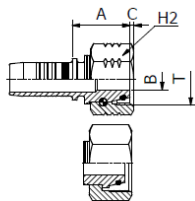

Art.nr.	Slangdim.		Gänga	Rör	Dimensioner			H2	Mutter
	DN	Tum			T	mm	B		
4519-06-03	5	3/16"	M 14x1,5	6	2,5	25,5	3,5	17,0	SL
4519-08-03	5	3/16"	M 16x1,5	8	3,0	21,5	3,4	19,0	SL
4519-06-04	6	1/4"	M 14x1,5	6	3,0	23,5	1,9	17,0	SL
4519-08-04	6	1/4"	M 16x1,5	8	4,0	22,0	3,5	19,0	SL
4519-10-04	6	1/4"	M 18x1,5	10	4,0	28,0	2,5	22,0	SL
4519-12-04	6	1/4"	M 20x1,5	12	7,0	26,0	2,0	24,0	SL
4519-10-05	8	5/16"	M 18x1,5	10	5,5	28,0	2,5	22,0	SL
4519-12-05	8	5/16"	M 20x1,5	12	5,5	25,0	2,0	24,0	SL
4519-10-06	10	3/8"	M 18x1,5	10	7,0	28,5	2,5	22,0	SL
4519-12-06	10	3/8"	M 20x1,5	12	7,0	25,5	2,0	24,0	SL
4519-14-06	10	3/8"	M 22x1,5	14	7,0	32,5	3,0	27,0	SL
4519-16-06	10	3/8"	M 24x1,5	16	7,0	32,0	4,0	30,0	SL
4519-12-08	12	1/2"	M 20x1,5	12	7,0	29,0	2,5	24,0	ST
4519-14-08	12	1/2"	M 22x1,5	14	7,0	27,0	2,5	27,0	ST
4519-16-08	12	1/2"	M 24x1,5	16	9,3	26,5	4,0	30,0	SL
4519-20-08	12	1/2"	M 30x2	20	12,5	37,0	3,5	36,0	SL
4519-16-10	16	5/8"	M 24x1,5	16	9,3	29,5	4,0	30,0	ST
4519-20-10	16	5/8"	M 30x2	20	12,5	30,5	3,5	36,0	SL
4519-25-10	16	5/8"	M 36x2	25	15,0	40,0	4,5	41,0	SL
4519-16-12	19	3/4"	M 24x1,5	16	9,3	30,5	4,0	30,0	ST
4519-20-12	19	3/4"	M 30x2	20	12,5	33,5	2,2	36,0	ST
4519-25-12	19	3/4"	M 36x2	25	15,0	34,0	4,5	41,0	SL
4519-20-16	25	1"	M 30x2	20	12,5	34,5	2,2	36,0	ST
4519-25-16	25	1"	M 36x2	25	15,0	35,5	1,7	41,0	ST
4519-30-16	25	1"	M 42x2	30	19,8	35,5	6,3	50,0	SL
4519-38-20	31	1.1/4"	M 52x2	38	26,0	37,5	8,0	60,0	SL
4519-38-24	38	1.1/2"	M 52x2	38	26,0	49,5	8,0	60,0	SL

Muttertyp: ST = Stiftad, SL = Slip-on

90° inv. metrisk, DKOS, 24° kona, DIN 20066/ ISO 12151-2

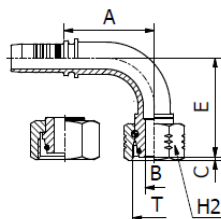

Art.nr.	Slangdim.		Gänga T	Rör mm	Dimensioner						Mutter
	DN	Tum			B	A	C	E	H2		
4548-06-03	5	3/16"	M 14x1,5	6	3,0	26,0	3,5	30,0	17,0		SL
4548-08-03	5	3/16"	M 16x1,5	8	3,0	26,0	3,4	29,5	19,0		SL
4548-06-04	6	1/4"	M 14x1,5	6	3,0	29,5	1,9	32,5	17,0		SL
4548-08-04	6	1/4"	M 16x1,5	8	4,0	29,5	3,4	29,5	19,0		SL
4548-10-04	6	1/4"	M 18x1,5	10	4,0	29,5	2,5	31,0	22,0		SL
4548-12-04	6	1/4"	M 20x1,5	12	5,5	29,5	2,0	34,5	24,0		SL
4548-10-05	8	5/16"	M 18x1,5	10	4,0	32,0	2,5	33,5	22,0		SL
4548-12-05	8	5/16"	M 20x1,5	12	5,5	32,0	2,0	34,0	24,0		SL
4548-10-06	10	3/8"	M 18x1,5	10	4,0	35,5	3,9	42,5	22,0		ST
4548-12-06	10	3/8"	M 20x1,5	12	7,0	36,5	2,0	35,0	24,0		SL
4548-14-06	10	3/8"	M 22x1,5	14	7,0	36,5	3,0	37,0	27,0		SL
4548-16-06	10	3/8"	M 24x1,5	16	9,3	36,5	4,0	36,0	30,0		SL
4548-14-08	12	1/2"	M 22x1,5	14	7,0	44,0	2,5	48,5	27,0		ST
4548-16-08	12	1/2"	M 24x1,5	16	9,3	45,0	4,0	40,5	30,0		SL
4548-20-08	12	1/2"	M 30x2	20	12,5	45,0	3,5	44,5	36,0		SL
4548-16-10	16	5/8"	M 24x1,5	16	9,3	53,5	4,0	58,5	30,0		ST
4548-20-10	16	5/8"	M 30x2	20	12,5	51,5	3,5	57,5	36,0		SL
4548-20-12	19	3/4"	M 30x2	20	12,5	61,5	2,2	67,5	36,0		ST
4548-25-12	19	3/4"	M 36x2	25	15,0	61,5	4,5	64,5	41,0		SL
4548-25-16	25	1"	M 36x2	25	15,0	79,5	1,7	86,0	41,0		ST
4548-30-16	25	1"	M 42x2	30	19,8	79,0	6,3	74,5	50,0		SL
4548-38-20	31	1.1/4"	M 52x2	38	26,0	93,5	8,0	85,5	60,0		SL
4548-38-24	38	1.1/2"	M 52x2	38	24,7	91,5	8,8	95,5	60,0		ST

Muttertyp: ST = Stiftad, SL = Slip-on

45° inv. metrisk, DKOS, 24° kona, DIN 20066/ ISO 12151-2

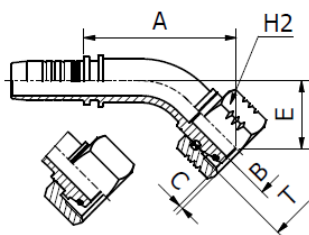

Art.nr.	Slangdim.		Gänga T	Rör mm	Dimensioner						Mutter
	DN	Tum			B	A	C	E	H2		
4549-06-04	6	1/4"	M 14x1,5	6	3,0	38,5	1,9	17,5	17,0	SL	
4549-08-04	6	1/4"	M 16x1,5	8	4,0	36,5	3,4	15,0	19,0	SL	
4549-10-04	6	1/4"	M 18x1,5	10	4,0	37,5	2,5	16,5	22,0	SL	
4549-10-05	8	5/16"	M 18x1,5	10	4,0	42,5	2,5	18,0	22,0	SL	
4549-12-05	8	5/16"	M 20x1,5	12	5,5	42,0	2,0	18,5	24,0	SL	
4549-10-06	10	3/8"	M 18x1,5	10	4,0	49,0	3,9	23,0	22,0	ST	
4549-12-06	10	3/8"	M 20x1,5	12	7,0	45,0	2,5	18,0	24,0	SL	
4549-14-06	10	3/8"	M 22x1,5	14	7,0	45,5	3,0	18,5	27,0	SL	
4549-14-08	12	1/2"	M 22x1,5	14	7,0	57,5	2,5	25,5	27,0	ST	
4549-16-08	12	1/2"	M 24x1,5	16	9,3	52,5	4,0	20,0	30,0	SL	
4549-20-10	16	5/8"	M 30x2	20	12,5	65,5	3,5	29,5	36,0	SL	
4549-20-12	19	3/4"	M 30x2	20	12,5	76,5	2,2	34,0	36,0	ST	
4549-25-12	19	3/4"	M 36x2	25	15,0	75,0	4,5	32,5	41,0	SL	
4549-25-16	25	1"	M 36x2	25	15,0	98,0	1,7	43,5	41,0	ST	
4549-30-16	25	1"	M 42x2	30	19,8	90,0	6,3	35,5	50,0	SL	
4549-38-20	31	1.1/4"	M 52x2	38	26,0	103,0	8,0	39,5	60,0	SL	
4549-38-24	38	1.1/2"	M 52x2	38	24,7	111,0	8,8	48,0	60,0	ST	

Muttertyp: ST = Stiftad, SL = Slip-on

Utvändig metrisk serie S, 24° kona, DIN 20066/ ISO 12151-2

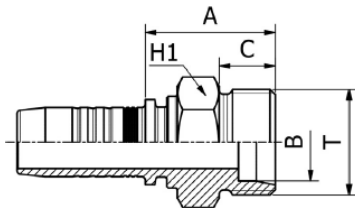

Art.nr.	Slangdim.		Gänga	Rör	Dimensioner						
	DN	Tum			T	mm	B	A	C	H1	
4514-08-04	6	1/4"	M 16x1,5	8	5,5	25,5	12,0	17,0			
4514-10-04	6	1/4"	M 18x1,5	10	6,0	26,5	12,0	19,0			
4514-12-04	6	1/4"	M 20x1,5	12	7,0	29,0	12,0	22,0			
4514-08-05	8	5/16"	M 16x1,5	8	5,5	26,0	12,0	17,0			
4514-10-05	8	5/16"	M 18x1,5	10	7,0	26,5	12,0	19,0			
4514-12-05	8	5/16"	M 20x1,5	12	7,0	29,0	12,0	22,0			
4514-10-06	10	3/8"	M 18 x1,5	10	7,0	27,0	12,0	19,0			
4514-12-06	10	3/8"	M 20x1,5	12	7,0	29,0	12,0	22,0			
4514-14-06	10	3/8"	M 22x1,5	14	8,0	31,0	14,0	22,0			
4514-12-08	12	1/2"	M 20x1,5	12	9,3	29,5	12,0	22,0			
4514-14-08	12	1/2"	M 22x1,5	14	9,3	31,5	14,0	22,0			
4514-16-08	12	1/2"	M 24x1,5	16	9,3	31,5	14,0	24,0			
4514-20-10	16	5/8"	M 30x2	20	15,0	35,5	16,0	30,0			
4514-25-10	16	5/8"	M 36x2	25	19,8	40,0	18,0	36,0			
4514-20-12	19	3/4"	M 30x2	20	15,0	37,0	16,0	30,0			
4514-25-12	19	3/4"	M 36x2	25	19,8	41,0	18,0	36,0			
4514-25-16	25	1"	M 36x2	25	19,8	42,5	18,0	36,0			
4514-30-16	25	1"	M 42x2	30	25,0	44,5	20,0	46,0			
4514-38-20	31	1.1/4"	M 52x2	38	30,0	51,0	22,0	55,0			

Rak rörstuds, DIN 2353/ ISO 8434-1

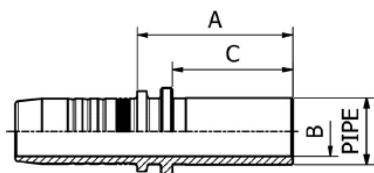

Art.nr.	Slangdim.		Rör	Dimensioner						Serie
	DN	Tum		mm	B	A				
4516-04-03	5	3/16"	4	2,0	29,5	22,0				L
4516-06-03	5	3/16"	6	3,0	19,5	22,0				L
4516-08-03	5	3/16"	8	3,0	31,0	24,0				S
4516-10-03	5	3/16"	10	3,0	29,5	22,0				S
4516-06-04	6	1/4"	6	3,0	30,0	22,0				L
4516-08-04	6	1/4"	8	4,0	32,0	24,0				S
4516-10-04	6	1/4"	10	4,0	34,0	26,0				S
4516-12-04	6	1/4"	12	7,0	34,0	26,0				S
4516-08-05	8	5/16"	8	5,5	30,0	22,0				L
4516-10-05	8	5/16"	10	7,0	31,0	23,0				L
4516-12-05	8	5/16"	12	7,0	34,0	26,0				S
4516-10-06	10	3/8"	10	7,0	31,5	23,0				L
4516-12-06	10	3/8"	12	8,0	31,5	23,0				L
4516-14-06	10	3/8"	14	8,0	37,5	29,0				S
4516-15-06	10	3/8"	15	10,5	33,5	25,0				L
4516-12-08	12	1/2"	12	8,0	32,0	23,0				L
4516-14-08	12	1/2"	14	8,0	37,5	29,0				S
4516-15-08	12	1/2"	15	10,5	34,0	25,0				L
4516-16-08	12	1/2"	16	10,5	39,0	30,0				S
4516-18-08	12	1/2"	18	12,5	35,0	26,0				L
4516-18-10	16	5/8"	18	12,5	35,0	26,0				L
4516-20-10	16	5/8"	20	12,5	45,0	36,0				S
4516-22-10	16	5/8"	22	15,0	37,0	28,0				L
4516-18-12	19	3/4"	18	12,5	36,5	26,0				L
4516-20-12	19	3/4"	20	15,0	46,5	36,0				S
4516-22-12	19	3/4"	22	15,0	38,5	28,0				L
4516-25-12	19	3/4"	25	15,0	50,5	40,0				S
4516-25-16	25	1"	25	15,0	50,5	40,0				S
4516-28-16	25	1"	28	19,8	41,5	30,0				L
4516-30-16	25	1"	30	19,8	55,5	44,0				S
4516-38-16	25	1"	38	26,0	61,5	50,0				S
4516-30-20	31	1.1/4"	30	20,5	56,5	44,0				S
4516-35-20	31	1.1/4"	35	26,0	48,5	36,0				L
4516-38-20	31	1.1/4"	38	26,0	62,5	50,0				S
4516-38-24	38	1.1/2"	38	26,0	62,5	50,0				S
4516-42-24	38	1.1/2"	42	32,0	52,5	40,0				L

90° rörstuds, DIN 2353/ ISO 8434-1

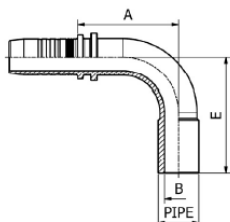

Art.nr.	Slangdim.		Rör	Dimensioner			Serie
	DN	Tum		mm	B	A	
4540-06-03	5	3/16"	6	3,0	22,5	34,0	L
4540-06-04	6	1/4"	6	3,0	23,0	34,0	L
4540-08-04	6	1/4"	8	4,0	27,0	38,0	S
4540-10-04	6	1/4"	10	6,0	27,0	41,0	S
4540-12-04	6	1/4"	12	7,0	27,0	44,0	S
4540-10-05	8	5/16"	10	7,0	29,5	40,0	L
4540-12-05	8	5/16"	12	7,0	30,5	44,0	S
4540-10-06	10	3/8"	10	7,0	33,0	42,5	L
4540-12-06	10	3/8"	12	8,0	34,0	45,0	L
4540-14-06	10	3/8"	14	9,3	35,0	51,0	S
4540-12-08	12	1/2"	12	8,0	34,5	45,0	L
4540-14-08	12	1/2"	14	9,3	42,0	53,5	S
4540-15-08	12	1/2"	15	10,5	42,0	52,0	L
4540-16-08	12	1/2"	16	10,5	43,0	55,0	S
4540-18-08	12	1/2"	18	12,5	42,0	55,0	L
4540-18-10	16	5/8"	18	12,5	49,0	59,0	L
4540-20-10	16	5/8"	20	12,5	49,0	66,5	S
4540-22-10	16	5/8"	22	15,0	53,5	63,0	L
4540-20-12	19	3/4"	20	15,0	54,5	69,0	S
4540-22-12	19	3/4"	22	15,0	54,5	63,0	L
4540-25-12	19	3/4"	25	15,0	57,5	75,0	S
4540-25-16	25	1"	25	15,0	61,5	76,5	S
4540-28-16	25	1"	28	19,8	67,5	75,0	L
4540-30-16	25	1"	30	19,8	69,5	87,0	S
4540-35-20	31	1.1/4"	35	26,0	80,5	94,0	L

45° rörstuds, DIN 2353/ ISO 8434-1

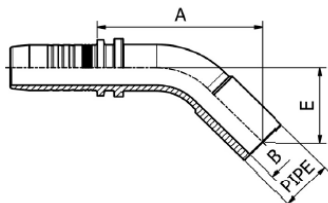

Art.nr.	Slangdim.		Rör	Dimensioner			Serie
	DN	Tum		mm	B	A	
4542-06-03	5	3/16"	6	3,0	37,5	20,5	L
4542-06-04	6	1/4"	6	3,0	38,0	20,5	L
4542-08-04	6	1/4"	8	4,0	42,0	22,0	S
4542-10-04	6	1/4"	10	6,0	44,0	24,0	S
4542-10-05	8	5/16"	10	7,0	44,5	22,5	L
4542-10-06	10	3/8"	10	7,0	47,5	23,0	L
4542-12-06	10	3/8"	12	8,0	49,5	25,0	L
4542-14-06	10	3/8"	14	9,3	54,5	29,0	S
4542-15-08	12	1/2"	15	10,5	58,0	28,0	L
4542-16-08	12	1/2"	16	10,5	61,0	30,0	S
4542-18-10	16	5/8"	18	12,5	63,5	30,5	L
4542-20-10	16	5/8"	20	12,5	69,0	36,0	S
4542-22-12	19	3/4"	22	15,0	69,0	32,0	L
4542-25-12	19	3/4"	25	15,0	80,5	40,5	S
4542-25-16	25	1"	25	15,0	82,0	41,0	S
4542-28-16	25	1"	28	19,8	81,5	37,0	L

Invändig metrisk universal kona, DIN 20078/ 3868

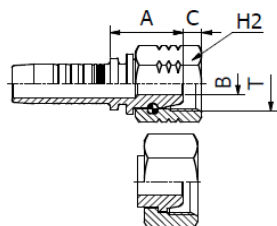

Art.nr.	Slangdim.		Gänga T	Rör mm	Dimensioner						
	DN	Tum			B	A	C	H2	Mutter		
4539-06-03	5	3/16"	M 12x1,5	6	3,0	18,5	3,2		14,0		SL
4539-06-04	6	1/4"	M 12x1,5	6	4,0	19,5	4,0		17,0		ST
4539-08-04	6	1/4"	M 14x1,5	8	4,0	19,5	3,0		17,0		SL
4539-10-04	6	1/4"	M 16 x1,5	10	4,0	19,5	4,0		19,0		SL
4539-10-05	8	5/16"	M 16x1,5	10	5,5	19,5	4,0		19,0		SL
4539-12-05	8	5/16"	M 18x1,5	12	5,5	19,5	4,0		22,0		SL
4539-08-06	10	3/8"	M 14x1,5	8	4,0	19,5	3,9		17,0		ST
4539-10-06	10	3/8"	M 16 x1,5	10	7,0	21,5	5,0		19,0		ST
4539-12-06	10	3/8"	M 18x1,5	12	7,0	20,0	4,0		22,0		SL
4539-15-06	10	3/8"	M 22x1,5	15	7,0	21,0	4,7		27,0		SL
4539-12-08	12	1/2"	M 18x1,5	12	7,0	23,0	5,9		22,0		ST
4539-15-08	12	1/2"	M 22x1,5	15	9,3	21,5	4,7		27,0		SL
4539-15-10	16	5/8"	M 22x1,5	15	9,3	23,5	5,5		27,0		ST
4539-18-10	16	5/8"	M 26x1,5	18	12,5	22,0	5,0		32,0		SL

Muttertyp: ST = Stiftad, SL = Slip-on

45° inv. metrisk universal kona, DIN 20078/ 3868

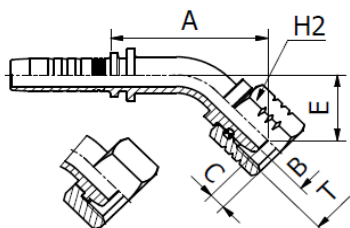

Art.nr.	Slangdim.		Gänga T	Rör mm	Dimensioner						
	DN	Tum			B	A	C	E	H2	Mutter	
4543-08-04	6	1/4"	M 14x1,5	8	4,0	36,5	3,0	15,0	17,0		SL
4543-10-04	6	1/4"	M 16x1,5	10	4,0	36,5	4,0	15,0	19,0		SL
4543-08-05	8	5/16"	M 14x1,5	8	4,0	40,0	3,9	19,5	17,0		ST
4543-10-05	8	5/16"	M 16x1,5	10	5,5	39,0	4,0	15,0	19,0		SL
4543-10-06	10	3/8"	M 16x1,5	10	7,0	46,0	5,0	20,0	19,0		ST
4543-12-06	10	3/8"	M 18x1,5	12	7,0	42,0	4,0	15,5	22,0		SL
4543-15-06	10	3/8"	M 22x1,5	15	7,0	42,5	4,7	15,5	27,0		SL
4543-15-08	12	1/2"	M 22x1,5	15	9,3	49,5	4,7	17,0	27,0		SL
4543-18-10	16	5/8"	M 26x1,5	18	12,5	60,0	5,0	24,0	32,0		SL

Muttertyp: ST = Stiftad, SL = Slip-on

90° inv. metrisk universal kona, DIN 20078/ 3868

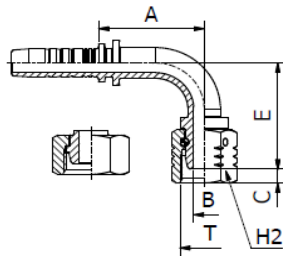

Art.nr.	Slangdim.		Gänga	Rör	Dimensioner						Mutter
	DN	Tum			T	mm	B	A	C	E	
4541-06-03	5	3/16"	M 12x1,5	6	3,0	26,0	3,2	27,0	14,0		SL
4541-06-04	6	1/4"	M 12x1,5	6	4,0	28,0	4,0	30,5	17,0		ST
4541-08-04	6	1/4"	M 14x1,5	8	4,0	29,5	3,0	29,5	17,0		SL
4541-10-04	6	1/4"	M 16x1,5	10	4,0	29,5	4,0	29,5	19,0		SL
4541-10-05	8	5/16"	M 16x1,5	10	5,5	32,0	4,0	29,0	19,0		SL
4541-12-05	8	5/16"	M 18x1,5	12	7,0	32,0	4,0	30,5	22,0		SL
4541-10-06	10	3/8"	M 16x1,5	10	7,0	35,5	5,0	38,0	19,0		ST
4541-12-06	10	3/8"	M 18x1,5	12	7,0	36,5	4,0	31,5	22,0		SL
4541-15-06	10	3/8"	M 22x1,5	15	7,0	36,5	4,7	32,0	27,0		SL
4541-15-08	12	1/2"	M 22x1,5	15	9,3	45,0	4,7	36,5	27,0		SL
4541-18-10	16	5/8"	M 26x1,5	18	12,5	51,5	5,0	50,0	32,0		SL
4541-18-12	19	3/4"	M 26x1,5	18	15,0	61,5	2,3	63,0	32,0		ST

Muttertyp: ST = Stiftad, SL = Slip-on

Invändig JIC 37° kona, SAE J516 /ISO 12151-5

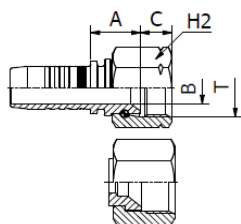

Art.nr.	Slangdim.		Gänga	Dimensioner						
	DN	Tum		T	B	A	C	H2	Mutter	
4521-04-03	5	3/16"	7/16"-20	3,0	15,0	8,0		15,0	SL	
4521-05-03	5	3/16"	1/2"-20	4,0	15,5	9,1		17,0	ST	
4521-04-04	6	1/4"	7/16"-20	4,0	15,5	8,7		17,0	ST	
4521-05-04	6	1/4"	1/2"-20	4,0	16,0	9,1		17,0	ST	
4521-06-04	6	1/4"	9/16"-18	4,0	16,5	9,8		19,0	SL	
4521-04-05	8	5/16"	7/16"-20	4,0	15,5	8,7		17,0	ST	
4521-05-05	8	5/16"	1/2"-20	5,5	16,0	9,1		17,0	ST	
4521-06-05	8	5/16"	9/16"-18	7,0	15,5	9,2		19,0	ST	
4521-08-05	8	5/16"	3/4"-16	5,5	17,0	10,1		22,0	SL	
4521-05-06	10	3/8"	1/2"-20	5,5	16,5	9,1		17,0	ST	
4521-06-06	10	3/8"	9/16"-18	7,0	16,0	9,2		19,0	ST	
4521-08-06	10	3/8"	3/4"-16	7,0	17,5	10,1		22,0	SL	
4521-10-06	10	3/8"	7/8"-14	9,3	18,0	12,4		27,0	SL	
4521-08-08	12	1/2"	3/4"-16	9,3	20,0	10,2		22,0	ST	
4521-10-08	12	1/2"	7/8"-14	9,3	18,5	12,4		27,0	SL	
4521-12-08	12	1/2"	1.1/16"-12	12,5	22,0	14,1		32,0	SL	
4521-10-10	16	5/8"	7/8"-14	12,5	20,0	12,3		27,0	ST	
4521-12-10	16	5/8"	1.1/16"-12	12,5	21,5	14,1		32,0	SL	
4521-08-12	19	3/4"	3/4"-14	9,3	21,5	10,2		22,0	ST	
4521-10-12	19	3/4"	7/8"-14	12,5	21,5	12,3		27,0	ST	
4521-12-12	19	3/4"	1.1/16"-12	15,0	22,5	14,2		32,0	ST	
4521-14-12	19	3/4"	1.3/16"-12	15,0	23,0	14,3		36,0	ST	
4521-16-12	19	3/4"	1.5/16"-12	19,8	23,0	15,0		38,0	ST	
4521-12-16	25	1"	1.1/16"-12	15,0	23,5	14,2		32,0	ST	
4521-16-16	25	1"	1.5/16"-12	19,8	24,0	15,0		38,0	ST	
4521-20-16	25	1"	1.5/8"-12	26,0	30,0	16,2		50,0	ST	
4521-20-20	31	1.1/4"	1.5/8"-12	26,0	30,0	16,2		50,0	ST	
4521-24-20	31	1.1/4"	1.7/8"-12	32,0	35,0	18,8		60,0	ST	
4521-24-24	38	1.1/2"	1.7/8"-12	32,0	35,0	18,8		60,0	ST	
4521-24-32	51	2"	1.7/8"-12	32,0	37,0	18,8		60,0	ST	
4521-32-32	51	2"	2.1/2"-12	44,0	35,5	24,0		75,0	ST	

Muttertyp: ST = Stiftad, SL = Slip-on

JIC nipplar med dubbla sexkanter på förfrågan, (Art.nr. 4580)

90° invändig JIC-gänga, 37° kona, SAE J516/ ISO 12151-5

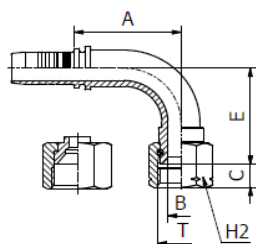

Art.nr.	Slangdim.		Gänga	Dimensioner						Mutter
	DN	Tum	T	B	A	C	E	H2		
4527-04-03	5	3/16"	7/16"-20	3,0	26,0	8,5	23,5	15,0	SL	
4527-04-04	6	1/4"	7/16"-20	4,0	28,5	8,7	27,0	17,0	ST	
4527-05-04	6	1/4"	1/2"-20	4,0	28,5	9,1	27,5	17,0	ST	
4527-06-04	6	1/4"	9/16"-18	4,0	29,5	9,8	28,0	19,0	SL	
4527-08-04	6	1/4"	3/4"-16	7,0	29,5	10,0	30,5	22,0	SL	
4527-05-05	8	5/16"	1/2"-20	5,5	31,0	9,1	28,0	17,0	ST	
4527-06-05	8	5/16"	9/16"-18	7,0	31,0	9,2	28,5	19,0	ST	
4527-05-06	10	3/8"	1/2"-20	5,5	30,0	9,1	26,5	17,0	ST	
4527-06-06	10	3/8"	9/16"-18	7,0	35,5	9,2	32,5	19,0	ST	
4527-08-06	10	3/8"	3/4"-16	7,0	36,5	10,1	29,5	22,0	SL	
4527-10-06	10	3/8"	7/8"-14	9,3	36,5	12,4	31,5	27,0	SL	
4527-06-08	12	1/2"	9/16"-18	7,0	37,0	9,2	33,0	19,0	ST	
4527-08-08	12	1/2"	3/4"-16	9,3	44,0	10,2	41,0	22,0	ST	
4527-10-08	12	1/2"	7/8"-14	9,3	45,0	12,4	36,0	27,0	SL	
4527-12-08	12	1/2"	1.1/16"-12	12,5	51,5	14,1	50,0	32,0	SL	
4527-10-10	16	5/8"	7/8"-14	12,5	53,5	12,3	52,5	27,0	ST	
4527-12-10	16	5/8"	1.1/16"-12	12,5	51,5	14,1	50,0	32,0	SL	
4527-10-12	19	3/4"	7/8"-14	12,5	55,0	12,3	52,5	27,0	ST	
4527-12-12	19	3/4"	1.1/16"-12	15,0	62,0	14,2	58,0	32,0	ST	
4527-14-12	19	3/4"	1.3/16"-12	15,0	63,0	14,3	58,0	36,0	ST	
4527-16-12	19	3/4"	1.5/16"-12	19,8	63,0	15,0	57,5	38,0	ST	
4527-16-16	25	1"	1.5/16"-12	19,8	77,0	15,0	68,5	38,0	ST	
4527-20-16	25	1"	1.5/8"-12	26,0	77,5	16,2	74,5	50,0	ST	
4527-20-20	31	1.1/4"	1.5/8"-12	26,0	90,5	16,2	86,5	50,0	ST	
4527-24-20	31	1.1/4"	1.7/8"-12	32,0	90,5	18,8	90,5	60,0	ST	
4527-24-24	38	1.1/2"	1.7/8"-12	32,0	108,0	18,8	100,5	60,0	ST	
4527-32-32	51	2"	2.1/2"-12	44,0	142,0	24,0	137,0	75,0	ST	

Muttertyp: ST = Stiftad, SL = Slip-on

45° invändig JIC-gänga, 37° kona, SAE J516/ ISO 12151-5

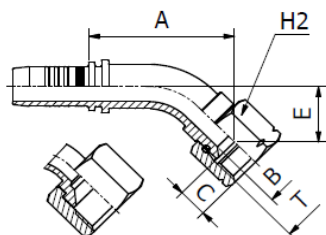

Art.nr.	Slangdim.		Gänga	T	Dimensioner						Mutter
	DN	Tum			B	A	C	E	H2		
4528-04-03	5	3/16"	7/16"-20		4,0	35,0	8,7	14,5	17,0		ST
4528-04-04	6	1/4"	7/16"-20		4,0	35,5	8,7	14,5	17,0		ST
4528-05-04	6	1/4"	1/2"-20		4,0	35,5	9,1	14,5	17,0		ST
4528-06-04	6	1/4"	9/16"-18		4,0	35,5	9,8	14,0	19,0		SL
4528-05-05	8	5/16"	1/2"-20		5,5	37,5	9,1	14,0	17,0		ST
4528-06-05	8	5/16"	9/16"-18		7,0	38,0	9,2	14,5	19,0		ST
4528-06-06	10	3/8"	9/16"-18		7,0	42,0	9,2	16,5	19,0		ST
4528-08-06	10	3/8"	3/4"-16		7,0	41,0	10,1	14,0	22,0		SL
4528-10-06	10	3/8"	7/8"-14		9,3	42,5	12,4	15,5	27,0		SL
4528-06-08	12	1/2"	9/16"-18		7,0	43,0	9,2	16,5	19,0		ST
4528-08-08	12	1/2"	3/4"-16		9,3	52,0	10,2	20,0	22,0		ST
4528-10-08	12	1/2"	7/8"-14		9,3	49,5	12,4	17,0	27,0		SL
4528-12-08	12	1/2"	1.1/16"-12		12,5	49,5	14,1	17,0	32,0		SL
4528-10-10	16	5/8"	7/8"-14		12,5	62,0	12,3	25,5	27,0		ST
4528-12-10	16	5/8"	1.1/16"-12		12,5	60,0	14,1	24,0	32,0		SL
4528-08-12	19	3/4"	3/4"-16		9,3	53,5	10,2	20,2	22,0		ST
4528-10-12	19	3/4"	7/8"-14		12,5	63,5	12,3	25,0	27,0		ST
4528-12-12	19	3/4"	1.1/16"-12		15,0	70,0	14,2	27,5	32,0		ST
4528-14-12	19	3/4"	1.3/16"-12		15,0	69,5	14,3	27,5	36,0		ST
4528-16-12	19	3/4"	1.5/16"-12		19,8	70,0	15,0	27,5	38,0		ST
4528-12-16	25	1"	1.1/16"-12		19,8	72,5	14,2	27,5	32,0		ST
4528-16-16	25	1"	1.5/16"-12		19,8	84,0	15,0	32,0	38,0		ST
4528-20-16	25	1"	1.5/8"-12		26,0	90,0	16,2	36,0	50,0		ST
4528-20-20	31	1.1/4"	1.5/8"-12		26,0	103,5	16,2	41,5	50,0		ST
4528-24-20	31	1.1/4"	1.7/8"-12		32,0	106,5	18,8	44,5	60,0		ST
4528-24-24	38	1.1/2"	1.7/8"-12		32,0	119,0	18,8	46,5	60,0		ST
4528-32-32	51	2"	2.1/2"-12		44,0	163,0	24,0	68,0	75,0		ST

Muttertyp: ST = Stiftad, SL = Slip-on

Utvändig JIC 37° kona, SAE J516 /ISO 12151-5

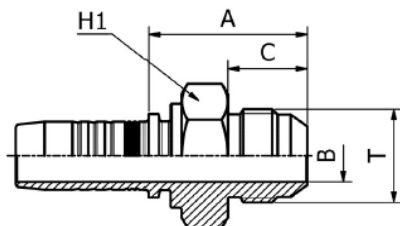

Art.nr.	Slangdim.		Gänga	Dimensioner						
	DN	Tum		T	B	A	C			
4522-04-04	6	1/4"	7/16"-20		4,0	28,0	14,0	12,0		
4522-05-04	6	1/4"	1/2"-20		5,5	29,0	14,0	14,0		
4522-06-04	6	1/4"	9/16"-18		7,0	29,0	14,0	17,0		
4522-04-05	8	5/16"	7/16"-20		4,0	29,0	14,0	14,0		
4522-05-05	8	5/16"	1/2"-20		5,5	29,0	14,0	14,0		
4522-06-05	8	5/16"	9/16"-18		7,0	29,0	14,0	17,0		
4522-05-06	10	3/8"	1/2"-20		5,5	29,5	14,0	17,0		
4522-06-06	10	3/8"	9/16"-18		7,0	29,5	14,0	17,0		
4522-08-06	10	3/8"	3/4"-16		9,3	34,0	16,5	19,0		
4522-10-06	10	3/8"	7/8"-14		12,5	38,5	19,5	24,0		
4522-06-08	12	1/2"	9/16"-18		7,0	32,0	14,0	19,0		
4522-08-08	12	1/2"	3/4"-16		9,3	34,5	16,5	19,0		
4522-10-08	12	1/2"	7/8"-14		12,5	39,0	19,5	24,0		
4522-12-08	12	1/2"	1.1/16"-12		15,0	43,0	22,0	27,0		
4522-10-10	16	5/8"	7/8"-14		12,5	39,0	19,5	24,0		
4522-12-10	16	5/8"	1.1/16"-12		15,0	42,5	22,0	27,0		
4522-10-12	19	3/4"	7/8"-14		12,5	41,5	19,5	27,0		
4522-12-12	19	3/4"	1.1/16"-12		15,0	44,0	22,0	27,0		
4522-14-12	19	3/4"	1.3/16"-12		15,0	44,5	22,5	32,0		
4522-16-12	19	3/4"	1.5/16"-12		19,8	47,0	23,0	34,0		
4522-12-16	25	1"	1.1/16"-12		15,0	45,0	22,0	32,0		
4522-16-16	25	1"	1.5/16"-12		19,8	48,0	23,0	34,0		
4522-20-16	25	1"	1.5/8"-12		26,0	53,0	24,3	42,0		
4522-20-20	31	1.1/4"	1.5/8"-12		26,0	53,5	24,3	42,0		
4522-24-20	31	1.1/4"	1.7/8"-12		32,0	60,5	27,5	50,0		
4522-24-24	38	1.1/2"	1.7/8"-12		32,0	60,5	27,5	50,0		
4522-32-32	51	2"	2.1/2"-12		42,0	72,0	34,0	65,0		

90° inv. JIC-gänga kompakt, 37° kona, SAE J516/ ISO 12151-5

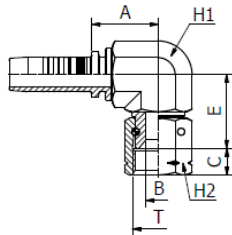

Art.nr.	Slangdim.		Gänga T	Dimensioner						
	DN	Tum		B	A	C	E	H1	H2	Mutter
4529-04-04	6	1/4"	7/16"-20	4,0	20,0	8,7	20,5	14,0	17,0	ST
4529-06-04	6	1/4"	9/16"-18	7,0	20,0	9,8	21,5	14,0	19,0	ST
4529-06-06	10	3/8"	9/16"-18	7,0	23,0	9,2	24,0	19,0	19,0	ST
4529-08-06	10	3/8"	3/4"-16	9,3	26,5	10,2	28,0	22,0	22,0	ST
4529-08-08	12	1/2"	3/4"-16	9,3	25,0	10,2	28,0	22,0	22,0	ST
4529-10-08	12	1/2"	7/8"-14	12,5	25,0	12,3	29,0	22,0	27,0	ST
4529-12-12	19	3/4"	1.1/16"-12	15,0	37,5	14,2	33,0	27,0	32,0	ST
4529-16-16	25	1"	1.5/16"-12	20,0	52,0	15,0	40,0	36,0	38,0	ST

Muttertyp: ST = Stiftad

90° inv. JIC-gänga, 37° kona, Long Drop, SAE J516/ ISO 12151-5

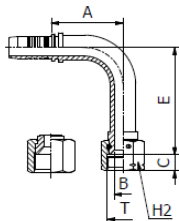

Art.nr.	Slangdim.		Gänga T	Dimensioner						
	DN	Tum		B	A	C	E	H2	Mutter	
4538-04-04	6	1/4"	7/16"-20	4,0	28,5	8,7	45,0		17,0	ST
4538-05-04	6	1/4"	1/2"-20	4,0	28,5	9,1	45,0		17,0	ST
4538-06-04	6	1/4"	9/16"-18	4,0	29,5	9,8	55,5		19,0	SL
4538-06-06	10	3/8"	9/16"-18	7,0	35,5	9,2	55,0		19,0	ST
4538-08-06	10	3/8"	3/4"-16	7,0	36,5	10,1	61,5		22,0	SL
4538-08-08	12	1/2"	3/4"-16	9,3	44,0	10,2	61,5		22,0	ST
4538-10-08	12	1/2"	7/8"-14	9,3	45,0	12,4	65,0		27,0	SL
4538-10-10	16	5/8"	7/8"-14	12,5	53,5	12,3	65,5		27,0	ST
4538-12-12	19	3/4"	1.1/16"-12	15,0	62,0	14,2	94,5		32,0	ST
4538-16-16	25	1"	1.5/16"-12	19,8	77,5	15,0	110,0		38,0	ST
4538-20-20	31	1.1/4"	1.5/8"-12	26,0	90,5	16,2	129,0		50,0	ST

Muttertyp: ST = Stiftad, SL = Slip-on

Utvändig NPTF-gänga 60° kona, SAE J516/J514

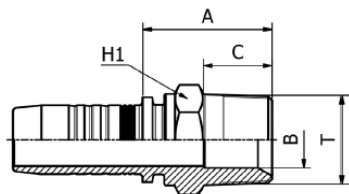

Art.nr.	Slangdim.		Gänga	Dimensioner							
	DN	Tum		T	B	A	C	H1			
4520-02-03	5	3/16"	1/8"-27		3,0	23,5	10,0	12,0			
4520-04-03	5	3/16"	1/4"-18		5,5	29,0	14,5	14,0			
4520-02-04	6	1/4"	1/8"-27		4,0	24,0	10,0	12,0			
4520-04-04	6	1/4"	1/4"-18		5,5	29,0	14,5	14,0			
4520-06-04	6	1/4"	3/8"-18		9,3	27,5	14,5	19,0			
4520-08-04	6	1/4"	1/2"-14		9,3	33,5	19,2	24,0			
4520-04-05	8	5/16"	1/4"-18		5,5	29,5	14,5	14,0			
4520-06-05	8	5/16"	3/8"-18		9,3	32,0	14,5	19,0			
4520-04-06	10	3/8"	1/4"-18		9,3	28,5	14,5	19,0			
4520-06-06	10	3/8"	3/8"-18		9,3	28,5	14,5	19,0			
4520-08-06	10	3/8"	1/2"-14		12,5	34,5	19,2	24,0			
4520-06-08	12	1/2"	3/8"-18		9,3	29,0	14,5	19,0			
4520-08-08	12	1/2"	1/2"-14		12,5	35,0	19,2	24,0			
4520-12-08	12	1/2"	3/4"-14		15,5	35,5	19,2	27,0			
4520-08-10	16	5/8"	1/2"-14		12,5	28,5	19,2	24,0			
4520-12-10	16	5/8"	3/4"-14		16,0	40,0	19,2	27,0			
4520-08-12	19	3/4"	1/2"-14		12,5	36,5	19,2	27,0			
4520-12-12	19	3/4"	3/4"-14		16,0	36,5	19,2	27,0			
4520-16-12	19	3/4"	1"-11,5		19,8	46,0	24,2	36,0			
4520-12-16	25	1"	3/4"-14		15,5	39,0	19,2	32,0			
4520-16-16	25	1"	1"-11,5		19,8	44,0	24,2	36,0			
4520-20-16	25	1"	1.1/4"-11,5		26,0	56,6	25,0	46,0			
4520-20-20	31	1.1/4"	1.1/4"-11,5		26,0	56,5	25,0	46,0			
4520-24-24	38	1.1/2"	1.1/2"-11,5		32,0	57,5	26,0	50,0			
4520-32-32	51	2"	2"-11,5		45,0	64,5	26,5	65,0			
4520-40-40	63	2 1/2"	2 1/2"-8		55,4	78,0	39,0	80,0			
4520-48-48	76	3"	3"-8		68,9	86,0	41,5	100,0			

Invändig ORFS, SAE J516 /ISO 12151-1

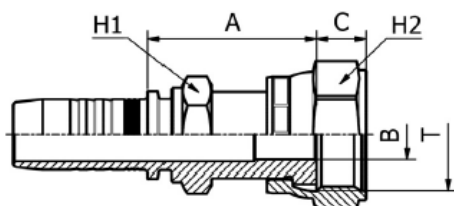

Art.nr.	Slangdim.		Gänga	Dimensioner						Mutter
	DN	Tum		T	B	A	C	H1	H2	
4560-04-04	6	1/4"	9/16"-18	4,0	27,5	8,0	13,0	19,0		PB
4560-06-04	6	1/4"	11/16"-16	7,0	30,0	9,5	16,0	22,0		PB
4560-08-04	6	1/4"	13/16"-16	9,3	35,5	11,0	19,0	24,0		PB
4560-04-05	8	5/16"	9/16"-18	4,0	28,5	8,0	16,0	19,0		PB
4560-06-05	8	5/16"	11/16"-16	7,0	30,5	9,5	16,0	22,0		PB
4560-04-06	10	3/8"	9/16"-18	4,0	29,0	8,0	16,0	19,0		PB
4560-06-06	10	3/8"	11/16"-16	7,0	31,0	9,5	16,0	22,0		PB
4560-08-06	10	3/8"	13/16"-16	9,3	36,5	11,0	19,0	24,0		PB
4560-06-08	12	1/2"	11/16"-16	7,0	32,0	9,5	19,0	22,0		PB
4560-08-08	12	1/2"	13/16"-16	9,3	37,0	11,0	19,0	24,0		PB
4560-10-08	12	1/2"	1"-14	11,5	39,0	13,5	24,0	30,0		PB
4560-12-08	12	1/2"	1.3/16"-12	13,9	44,0	14,5	28,0	36,0		PB
4560-08-10	16	5/8"	13/16"-16	9,3	37,0	11,0	24,0	24,0		PB
4560-10-10	16	5/8"	1"-14	11,5	39,0	13,5	24,0	30,0		PB
4560-12-10	16	5/8"	1.3/16"-12	13,9	44,0	14,5	28,0	36,0		PB
4560-10-12	19	3/4"	1"-14	11,5	41,5	13,5	28,0	30,0		PB
4560-12-12	19	3/4"	1.3/16"-12	13,9	45,5	14,5	28,0	36,0		PB
4560-16-12	19	3/4"	1.7/16"-12	19,8	48,5	15,0	36,0	41,0		PB
4560-12-16	25	1"	1.3/16"-12	13,9	48,0	13,5	36,0	36,0		PB
4560-16-16	25	1"	1.7/16"-12	19,8	49,5	15,0	36,0	41,0		PB
4560-20-16	25	1"	1.11/16"-12	26,0	52,0	13,6	41,0	50,0		PB
4560-20-20	31	1.1/4"	1.11/16"-12	26,0	52,0	14,8	41,0	50,0		PB
4560-24-20	31	1.1/4"	2"-12	32,0	56,5	14,2	50,0	60,0		PB
4560-24-24	38	1.1/2"	2"-12	32,0	56,5	14,2	50,0	60,0		PB

Muttertyp: PB = Pullback

90° invändig ORFS, SAE J516 /ISO 12151-1

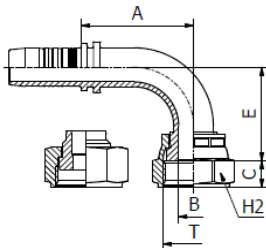

Art.nr.	Slangdim.		Gänga	Dimensioner						Mutter	
	DN	Tum		T	B	A	C	E	H2		
4559-04-04	6	1/4"	9/16"-18		4,0	27,5	8,2	22,0	17,0		PB
4559-06-04	6	1/4"	11/16"-16		7,0	27,5	9,5	22,0	22,0		PB
4559-06-05	8	5/16"	11/16"-16		7,0	32,0	9,5	23,0	22,0		PB
4559-04-06	10	3/8"	9/16"-18		4,0	28,9	8,0	23,0	19,0		PR
4559-06-06	10	3/8"	11/16"-16		6,0	30,0	9,5	24,0	22,0		PB
4559-08-06	10	3/8"	13/16"-16		9,3	30,0	11,0	26,5	24,0		PB
4559-06-08	12	1/2"	11/16"-16		7,0	30,0	9,5	24,5	22,0		PR
4559-08-08	12	1/2"	13/16"-16		9,0	40,5	11,0	30,0	24,0		PB
4559-10-08	12	1/2"	1"-14		11,5	40,0	13,5	30,5	30,0		PB
4559-12-08	12	1/2"	1.3/16"-12		13,9	39,5	14,5	37,5	36,0		PB
4559-08-10	16	5/8"	13/16"-16		9,3	41,0	11,0	34,0	24,0		PR
4559-10-10	16	5/8"	1"-14		11,5	48,0	13,5	37,5	30,0		PB
4559-12-10	16	5/8"	1.3/16"-12		13,9	48,0	14,5	41,0	36,0		PB
4559-10-12	19	3/4"	1"-14		11,5	49,0	12,5	38,5	30,0		PR
4559-12-12	19	3/4"	1.3/16"-12		13,9	56,5	14,5	48,0	36,0		PB
4559-16-12	19	3/4"	1.7/16"-12		19,8	56,5	14,8	47,5	41,0		PB
4559-12-16	25	1"	1.3/16"-12		13,9	57,5	13,5	48,0	36,0		PR
4559-16-16	25	1"	1.7/16"-12		19,8	71,5	14,8	56,0	41,0		PB
4559-20-16	25	1"	1.11/16"-12		26,0	71,5	14,8	58,5	50,0		PB
4559-20-20	31	1.1/4"	1.11/16"-12		26,0	83,0	14,8	66,0	50,0		PB
4559-24-24	38	1.1/2"	2"-12		32,0	102,0	14,8	79,5	60,0		PB

Muttertyp: PB = Pullback, PR = Pressad

45° invändig ORFS, SAE J516 /ISO 12151-1

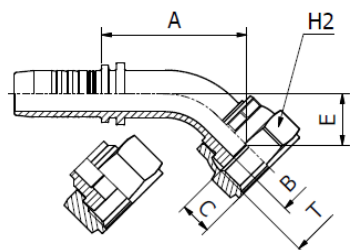

Art.nr.	Slangdim.		Gänga T	Dimensioner						Mutter
	DN	Tum		B	A	C	E	H2		
4558-04-04	6	1/4"	9/16"-18	4,0	31,0	8,2	10,5	17,0	PB	
4558-06-04	6	1/4"	11/16"-16	7,0	31,0	9,5	10,5	22,0	PB	
4558-06-05	8	5/16"	11/16"-16	7,0	34,0	9,5	10,5	22,0	PB	
4558-06-06	10	3/8"	11/16"-16	6,0	32,5	9,5	11,0	22,0	PB	
4558-08-06	10	3/8"	13/16"-16	9,3	34,0	11,0	12,5	24,0	PB	
4558-06-08	12	1/2"	11/16"-16	7,0	32,5	9,5	11,0	22,0	PR	
4558-08-08	12	1/2"	13/16"-16	9,0	42,0	11,0	13,0	24,0	PB	
4558-10-08	12	1/2"	1"-14	11,5	42,0	13,5	13,5	30,0	PB	
4558-12-08	12	1/2"	1.3/16"-12	13,9	46,5	14,5	18,5	36,0	PB	
4558-10-10	16	5/8"	1"-14	11,5	49,0	13,5	16,0	30,0	PB	
4558-12-10	16	5/8"	1.3/16"-12	13,9	51,5	14,5	18,5	36,0	PB	
4558-10-12	19	3/4"	1"-14	11,5	51,0	12,5	16,5	30,0	PR	
4558-12-12	19	3/4"	1.3/16"-12	13,9	60,5	14,5	21,5	36,0	PB	
4558-16-12	19	3/4"	1.7/16"-12	19,8	60,0	14,8	21,0	41,0	PB	
4558-12-16	25	1"	1.3/16"-12	13,9	66,0	13,5	21,5	36,0	PR	
4558-16-16	25	1"	1.7/16"-12	19,8	72,0	14,8	23,5	41,0	PB	
4558-20-16	25	1"	1.11/16"-12	26,0	74,0	14,8	25,0	50,0	PB	
4558-20-20	31	1.1/4"	1.11/16"-12	26,0	82,0	14,8	27,0	50,0	PB	
4558-24-24	38	1.1/2"	2"-12	32,0	98,0	14,8	31,5	60,0	PB	

Muttertyp: PB = Pullback, PR = Pressad

90° invändig ORFS, Long drop, SAE J516 /ISO 12151-1

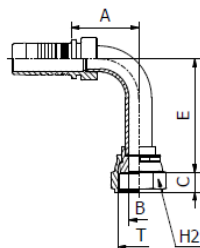

Art.nr.	Slangdim.		Gänga T	Dimensioner						Mutter
	DN	Tum		B	A	C	E	H2		
4547-04-04	6	1/4"	9/16"-18	4,4	25,0	8,0	46,0	17,0	PR	
4547-06-04	6	1/4"	11/16"-16	7,0	26,5	9,5	53,5	22,0	PR	
4547-06-05	8	5/16"	11/16"-16	6,7	31,5	9,5	54,0	22,0	PR	
4547-06-06	10	3/8"	11/16"-16	6,7	32,0	9,5	54,0	22,0	PR	
4547-08-06	10	3/8"	13/16"-16	6,7	32,0	11,0	54,0	24,0	PR	
4547-08-08	12	1/2"	13/16"-16	9,6	37,0	11,0	64,0	24,0	PR	
4547-10-08	12	1/2"	1"-14	9,6	37,0	12,5	64,5	30,0	PR	
4547-10-10	16	5/8"	1"-14	12,0	41,0	13,0	70,0	30,0	PR	
4547-12-10	16	5/8"	1.3/16"-12	12,7	41,0	13,5	73,0	36,0	PR	
4547-12-12	19	3/4"	1.3/16"-12	15,0	58,5	13,5	96,0	36,0	PR	
4547-16-16	25	1"	1.7/16"-12	19,8	71,5	13,5	114,0	41,0	PR	
4547-20-20	31	1.1/4"	1.11/16"-12	26,0	82,5	13,6	129,0	50,0	PR	

Muttertyp: PR = Pressad

Invändig ORFS, kort typ, SAE J516/ ISO 12151-1

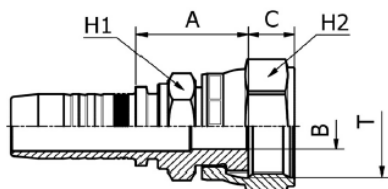

Art.nr.	Slangdim.		Gänga T	Dimensioner						Mutter
	DN	Tum		B	A	C	H1	H2		
4546-04-04	6	1/4"	9/16"-18	4,0	20,5	8,0	13,0	19,0	PR	
4546-06-04	6	1/4"	11/16"-16	7,0	22,0	9,5	16,0	22,0	PR	
4546-06-05	8	5/16"	11/16"-16	7,0	25,5	9,5	16,0	22,0	PR	
4546-06-06	10	3/8"	11/16"-16	7,0	26,0	9,5	16,0	22,0	PR	
4546-08-06	10	3/8"	13/16"-16	9,3	26,5	11,0	19,0	24,0	PR	
4546-08-08	12	1/2"	13/16"-16	9,3	26,5	11,0	19,0	24,0	PR	
4546-10-08	12	1/2"	1"-14	11,5	27,5	12,5	24,0	30,0	PR	
4546-12-08	12	1/2"	1.3/16"-12	13,9	31,0	13,5	28,0	36,0	PR	
4546-10-10	16	5/8"	1"-14	11,5	28,0	12,5	24,0	30,0	PR	
4546-12-10	16	5/8"	1.3/16"-12	13,9	31,0	13,5	28,0	36,0	PR	
4546-12-12	19	3/4"	1.3/16"-12	13,9	32,5	13,5	28,0	36,0	PR	
4546-16-16	25	1"	1.7/16"-12	19,8	36,5	13,5	36,0	41,0	PR	

Muttertyp: PR = Pressad

Utvändig ORFS, SAE J515/ ISO 12151-1

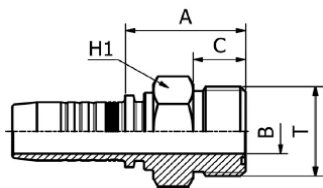

Art.nr.	Slangdim.		Gänga	Dimensioner						
	DN	Tum		T	B	A	C			
4557-04-04	6	1/4"	9/16"-18		4,0	24,0	9,8	16,0		
4557-06-04	6	1/4"	11/16"-16		6,7	26,5	11,2	19,0		
4557-06-05	8	5/16"	11/16"-16		6,7	27,0	11,2	19,0		
4557-06-06	10	3/8"	11/16"-16		6,7	27,5	11,2	19,0		
4557-08-06	10	3/8"	13/16"-16		9,3	30,0	12,8	22,0		
4557-06-08	12	1/2"	11/16"-16		6,7	29,0	11,2	22,0		
4557-08-08	12	1/2"	13/16"-16		9,3	30,5	12,8	22,0		
4557-10-08	12	1/2"	1"-14		12,5	35,0	15,5	27,0		
4557-12-08	12	1/2"	1.3/16"-12		15,0	37,5	17,0	32,0		
4557-08-10	16	5/8"	13/16"-16		9,3	30,5	12,8	22,0		
4557-10-10	16	5/8"	1"-14		12,5	34,5	15,5	27,0		
4557-12-10	16	5/8"	1.3/16"-12		15,0	37,5	17,0	32,0		
4557-12-12	19	3/4"	1.3/16"-12		15,0	39,0	17,0	32,0		
4557-16-12	19	3/4"	1.7/16"-12		19,8	40,5	17,5	38,0		
4557-16-16	25	1"	1.7/16"-12		19,8	42,0	17,5	38,0		
4557-20-16	25	1"	1.11/16"-12		26,0	44,0	17,5	46,0		
4557-20-20	31	1.1/4"	1.11/16"-12		26,0	46,5	17,5	46,0		
4557-24-24	38	1.1/2"	2"-12		32,0	48,5	17,5	55,0		

Rak SAE-fläns, 3000 PSI, SAE J516/ ISO 12151-3

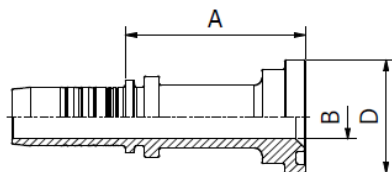

Art.nr.	Slangdim.		Fläns Tum	Dimensioner						
	DN	Tum		B	A	D				
4524-08-08	12	1/2"	1/2"	9,3	51,0	30,3				
4524-12-08	12	1/2"	3/4"	15,1	58,0	38,0				
4524-08-10	16	5/8"	1/2"	9,3	51,0	30,3				
4524-12-10	16	5/8"	3/4"	15,0	65,5	38,0				
4524-24-10	16	5/8"	1.1/2"	32,0	69,5	60,5				
4524-12-12	19	3/4"	3/4"	15,0	58,0	38,0				
4524-16-12	19	3/4"	1"	20,0	58,0	44,6				
4524-20-12	19	3/4"	1.1/4"	26,0	69,5	51,0				
4524-12-16	25	1"	3/4"	15,0	60,5	38,0				
4524-16-16	25	1"	1"	19,8	64,5	44,6				
4524-20-16	25	1"	1.1/4"	26,0	70,5	51,0				
4524-12-20	31	1.1/4"	3/4"	15,0	61,0	38,0				
4524-16-20	31	1.1/4"	1"	19,8	64,5	44,6				
4524-20-20	31	1.1/4"	1.1/4"	26,0	70,5	51,0				
4524-24-20	31	1.1/4"	1.1/2"	32,0	72,5	60,5				
4524-32-20	31	1.1/4"	2"	42,0	75,5	71,6				
4524-24-24	38	1.1/2"	1.1/2"	32,0	75,5	60,5				
4524-32-24	38	1.1/2"	2"	42,0	75,5	71,6				
4524-32-32	51	2"	2"	42,0	79,0	71,6				
4524-40-32	51	2"	2.1/2"	56,0	81,0	84,3				
4524-40-38	60	2.3/8"	2.1/2"	50,5	84,0	84,3				
4524-32-40	63	2.1/2"	2"	42,0	78,5	71,6				
4524-40-40	63	2.1/2"	2.1/2"	55,4	84,0	84,3				
4524-48-40	63	2.1/2"	3"	68,9	79,0	101,6				
4524-56-40	63	2.1/2"	3.1/2"	79,0	90,5	114,3				
4524-64-40	63	2.1/2"	4"	90,0	96,5	127,0				
4524-48-48	76	3"	3"	68,9	85,5	101,6				
4524-56-56	89	3.1/2"	3.1/2"	79,0	94,5	114,3				
4524-64-64	102	4"	4"	90,0	100,5	127,0				

90° SAE-fläns, 3000 PSI, SAE J516/ ISO 12151-3

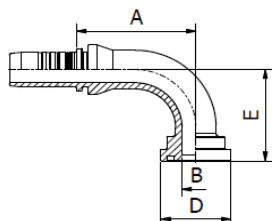

Art.nr.	Slangdim.		Fläns		Dimensioner				Utf.
	DN	Tum	Tum		B	A	D	E	
4525-08-06	10	3/8"	1/2"		9,3	44,5	30,0	34,5	
4525-08-08	12	1/2"	1/2"		9,3	54,5	30,3	40,0	
4525-12-08	12	1/2"	3/4"		15,0	54,5	38,0	41,0	
4525-16-08	12	1/2"	1"		19,8	54,5	44,6	66,0	
4525-08-10	16	5/8"	1/2"		9,3	56,0	30,3	46,5	
4525-12-10	16	5/8"	3/4"		15,0	56,0	38,0	47,5	
4525-12-12	19	3/4"	3/4"		15,0	64,5	38,0	52,0	
4525-16-12	19	3/4"	1"		20,0	64,5	44,6	52,0	
4525-20-12	19	3/4"	1.1/4"		26,0	64,5	51,0	52,0	
4525-12-16	25	1"	3/4"		15,0	71,0	38,0	52,0	
4525-16-16	25	1"	1"		19,8	77,5	44,6	62,0	
4525-20-16	25	1"	1.1/4"		26,0	77,5	51,0	62,0	
4425-20-16	25	1"	1.1/4"		26,0	77,5	51,0	117,0	LD
4525-24-16	25	1"	1.1/2"		32,0	77,0	60,5	64,0	
4525-16-20	31	1.1/4"	1"		19,8	80,0	44,6	66,0	
4525-20-20	31	1.1/4"	1.1/4"		26,0	90,5	51,0	70,0	
4425-20-20	31	1.1/4"	1.1/4"		26,0	90,5	51,0	130,0	LD
4525-24-20	31	1.1/4"	1.1/2"		32,0	90,5	60,5	72,0	
4525-32-20	31	1.1/4"	2"		42,0	93,5	71,6	76,0	
4525-20-24	38	1.1/2"	1.1/4"		26,0	104,5	51,0	75,0	
4525-24-24	38	1.1/2"	1.1/2"		32,0	108,0	60,5	84,0	
4525-32-24	38	1.1/2"	2"		42,0	108,0	71,6	84,0	
4525-24-32	51	2"	1.1/2"		32,0	136,0	60,5	89,0	
4525-32-32	51	2"	2"		42,0	129,0	71,6	99,0	
4525-40-32	51	2"	2.1/2"		56,0	132,5	84,3	116,0	
4525-32-40	63	2.1/2"	2"		42,0	149,5	71,6	114,0	
4525-40-40	63	2.1/2"	2.1/2"		52,0	88,0	84,3	119,0	L
4525-48-40	63	2.1/2"	3"		61,0	120,0	101,6	140,0	L
4525-48-48	76	3"	3"		58,0	123,0	101,6	140,0	L
4525-56-48	76	3"	3.1/2"		61,0	123,0	114,3	115,0	L
4525-56-56	89	3.1/2"	3.1/2"		79,0	134,5	114,3	160,0	L
4525-64-64	102	4"	4"		90,0	153,5	127,0	158,5	L

Utförande: L = Lött utförande

LD = Long drop. Andra dimensioner på förfrågan, kontakta Kundservice

45° SAE-fläns, 3000 PSI, SAE J516/ ISO 12151-3

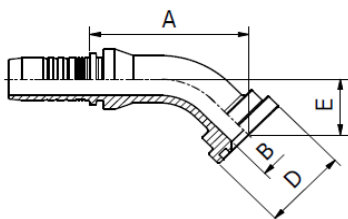

Art.nr.	Slangdim.		Fläns		Dimensioner				Utf.
	DN	Tum	Tum		B	A	D	E	
4526-08-06	10	3/8"	1/2"		9,3	52,5	30,0	17,5	
4526-08-08	12	1/2"	1/2"		9,3	58,5	30,3	18,5	
4526-12-08	12	1/2"	3/4"		15,0	59,5	38,0	19,0	
4526-16-08	12	1/2"	1"		19,8	59,5	44,6	19,0	
4526-12-10	16	5/8"	3/4"		15,0	61,0	38,0	22,0	
4526-12-12	19	3/4"	3/4"		15,0	71,0	38,0	26,0	
4526-16-12	19	3/4"	1"		20,0	68,5	44,6	23,0	
4526-12-16	25	1"	3/4"		15,0	74,5	38,0	23,0	
4526-16-16	25	1"	1"		19,8	81,5	44,6	27,5	
4526-20-16	25	1"	1.1/4"		26,0	81,5	51,0	27,5	
4526-16-20	31	1.1/4"	1"		19,8	84,5	44,6	29,5	
4526-20-20	31	1.1/4"	1.1/4"		26,0	92,0	51,0	29,5	
4526-24-20	31	1.1/4"	1.1/2"		32,0	93,5	60,5	31,0	
4526-24-24	38	1.1/2"	1.1/2"		32,0	107,5	60,5	34,5	
4526-32-24	38	1.1/2"	2"		42,0	107,5	71,6	34,5	
4526-20-32	51	2"	1.1/4"		26,0	128,5	51,0	32,0	
4526-32-32	51	2"	2"		42,0	124,0	71,6	39,0	
4526-40-32	51	2"	2.1/2"		56,0	136,5	84,3	49,5	
4526-32-40	63	2.1/2"	2"		42,0	152,0	71,6	48,5	
4526-40-40	63	2.1/2"	2.1/2"		52,0	95,0	84,3	48,5	L
4526-48-40	63	2.1/2"	3"		61,0	117,5	101,6	53,5	L
4526-48-48	76	3"	3"		58,0	125,5	101,6	53,5	L
4526-56-56	89	3.1/2"	3.1/2"		79,0	139,0	114,3	68,0	L
4526-64-56	89	3.1/2"	4"		79,0	124,5	127,0	53,5	L
4526-64-64	102	4"	4"		90,0	132,0	127,0	56,5	L

Utförande: L = Lött utförande

OBS! Andra vinkelställningar på förfrågan, kontakta Kundservice

Rak SAE-fläns, 6000 PSI, SAE J516/ ISO 12151-3

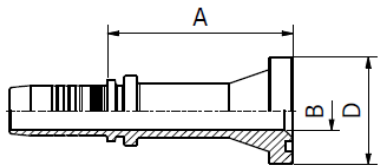

Art.nr.	Slangdim.		Fläns	Dimensioner						
	DN	Tum		Tum	B	A				
4530-08-08	12	1/2"	1/2"	9,3	52,0	31,8				
4530-12-08	12	1/2"	3/4"	15,0	68,5	41,5				
4530-08-10	16	5/8"	1/2"	9,3	52,0	31,8				
4530-12-10	16	5/8"	3/4"	15,0	70,0	41,5				
4530-16-10	16	5/8"	1"	20,0	80,0	47,7				
4530-12-12	19	3/4"	3/4"	15,0	69,0	41,5				
4530-16-12	19	3/4"	1"	20,0	81,0	47,7				
4530-16-16	25	1"	1"	19,8	82,5	47,7				
4530-20-16	25	1"	1.1/4"	26,0	90,0	54,2				
4530-16-20	31	1.1/4"	1"	19,8	82,5	47,7				
4530-20-20	31	1.1/4"	1.1/4"	26,0	84,5	54,2				
4530-24-20	31	1.1/4"	1.1/2"	32,0	90,5	63,7				
4530-24-24	38	1.1/2"	1.1/2"	32,0	92,5	63,6				
4530-32-32	51	2"	2"	42,0	109,0	79,5				

90° SAE-fläns, 6000 PSI, SAE J516/ ISO 12151-3

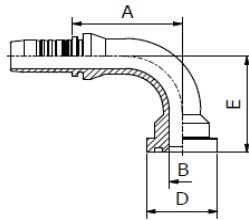

Art.nr.	Slangdim.		Fläns		Dimensioner						
	DN	Tum	Tum		B	A	D	E			
4531-08-08	12	1/2"	1/2"		9,3	54,5	31,8	45,0			
4531-12-08	12	1/2"	3/4"		15,0	54,5	41,5	53,0			
4531-08-10	16	5/8"	1/2"		9,3	57,5	31,8	45,0			
4531-12-10	16	5/8"	3/4"		15,0	53,5	41,5	60,5			
4531-16-10	16	5/8"	1"		19,8	56,0	47,7	64,0			
4531-08-12	19	3/4"	1/2"		9,3	60,6	31,8	57,5			
4531-12-12	19	3/4"	3/4"		15,0	64,0	41,5	59,0			
4531-16-12	19	3/4"	1"		20,0	64,5	47,7	65,0			
4531-12-16	25	1"	3/4"		15,0	74,5	41,5	67,0			
4531-16-16	25	1"	1"		19,8	73,5	47,7	68,0			
4531-20-16	25	1"	1.1/4"		26,0	73,5	54,2	75,0			
4531-16-20	31	1.1/4"	1"		19,8	82,5	47,7	68,0			
4531-20-20	31	1.1/4"	1.1/4"		26,0	85,5	54,2	81,0			
4531-24-20	31	1.1/4"	1.1/2"		32,0	85,5	63,7	91,5			
4531-20-24	38	1.1/2"	1.1/4"		26,0	105,0	54,2	91,0			
4531-24-24	38	1.1/2"	1.1/2"		32,0	106,0	63,7	94,5			
4531-32-24	38	1.1/2"	2"		42,0	106,0	79,6	110,5			
4531-32-32	51	2"	2"		42,0	138,0	79,6	132,0			

45° SAE-Fläns, 6000 PSI, SAE J516/ ISO 12151-3

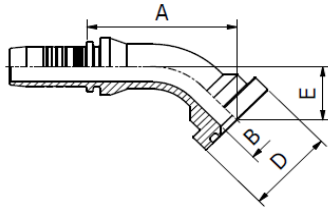

Art.nr.	Slangdim.		Fläns	Dimensioner						
	DN	Tum		Tum	B	A	D			
4532-08-08	12	1/2"	1/2"	9,3	59,0	31,7	19,0			
4532-12-08	12	1/2"	3/4"	15,0	68,0	41,5	27,5			
4532-08-10	16	5/8"	1/2"	9,3	62,5	31,8	23,5			
4532-12-10	16	5/8"	3/4"	15,0	67,5	41,5	31,0			
4532-12-12	19	3/4"	3/4"	15,0	72,5	41,5	28,0			
4532-16-12	19	3/4"	1"	20,0	77,0	47,7	32,5			
4532-12-16	25	1"	3/4"	15,0	80,0	41,5	30,0			
4532-16-16	25	1"	1"	19,8	83,5	47,7	32,5			
4532-20-16	25	1"	1.1/4"	26,0	88,5	54,2	37,5			
4532-20-20	31	1.1/4"	1.1/4"	26,0	95,0	54,2	37,5			
4532-24-20	31	1.1/4"	1.1/2"	32,0	102,5	63,7	45,0			
4532-24-24	38	1.1/2"	1.1/2"	32,0	118,0	63,7	44,0			
4532-32-24	38	1.1/2"	2"	42,0	129,0	79,6	55,5			
4532-32-32	51	2"	2"	42,0	151,5	79,6	132,0			

Flänshalvor 3000 PSI (code 61), SAE J518/ ISO 6162-1

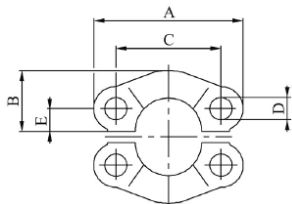

Art.nr.			Fläns	Dimensioner						
			Tum	B	A	C	D	E		
05004644-08			1/2"	22,8	54,0	38,1	8,75	8,7		
05004644-12			3/4"	25,9	65,0	47,6	10,75	11,1		
05004644-16			1"	29,2	70,0	52,4	10,75	13,1		
05004644-20			1.1/4"	36,3	79,0	58,7	12,00	15,1		
05004644-24			1.1/2"	41,1	94,0	69,8	13,50	17,9		
05004644-32			2"	48,2	102,0	77,8	13,50	21,4		
05004644-40			2.1/2"	54,1	114,0	88,9	13,50	25,4		
05004644-48			3"	65,3	135,0	106,4	16,75	31,0		
05004644-56			3.1/2"	70,0	152,0	120,65	17,00	34,85		
05004644-64			4"	75,0	160,0	130,2	17,00	38,9		

Flänshalvor 6000 PSI (code 62), SAE J518/ISO 6162-2

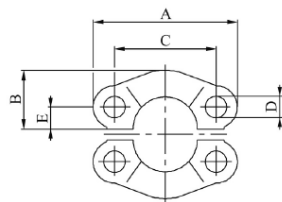

Art.nr.			Fläns	Dimensioner						
			Tum	B	A	C	D	E		
05003425-08			1/2"	23,6	56,0	40,5	8,75	9,1		
05003425-12			3/4"	30,0	71,0	50,8	11,00	11,9		
05003425-16			1"	34,8	81,0	57,1	13,00	13,9		
05003425-20			1.1/4"	38,6	95,0	66,7	15,00	15,9		
05003425-24			1.1/2"	47,5	113,0	79,4	17,00	18,3		
05003425-32			2"	56,9	133,0	96,8	21,00	22,2		

Halfläns 3000 PSI (code 61), SAE J518/ ISO 6162-1

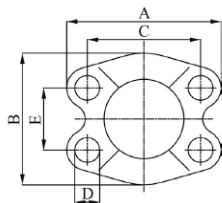

Art.nr.	Fläns		Dimensioner				
	Tum		B	A	C	D	E
058310-12-00	3/4"		51,8	65,0	47,6	10,75	22,2
058310-16-00	1"		58,4	70,0	52,4	10,75	26,2
058310-20-00	1.1/4"		72,6	79,0	58,7	12,00	30,2
058310-24-00	1.1/2"		82,2	94,0	69,8	13,50	35,7
058310-32-00	2"		96,4	102,0	77,8	13,50	42,9
058310-40-00	2.1/2"		108,2	114,0	88,9	13,50	50,8
058310-48-00	3"		130,6	135,0	106,4	16,75	61,9
058310-56-00	3.1/2"		139,0	152,0	120,6	17,00	69,8
058310-64-00	4"		152,0	162,0	130,2	17,00	77,8

Halfläns 6000 PSI (code 62), SAE J518/ ISO 6162-2

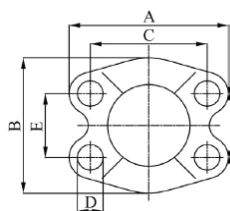

Art.nr.	Fläns		Dimensioner				
	Tum		B	A	C	D	E
058610-12-00	3/4"		60,0	72,0	50,8	10,5	23,8
058610-16-00	1"		70,0	81,0	57,2	13,0	27,8
058610-20-00	1.1/4"		78,0	96,0	66,7	15,0	31,8
058610-24-00	1.1/2"		96,0	113,0	79,4	17,0	36,5
058610-32-00	2"		114,0	134,0	96,8	21,0	44,4
058610-40-00	2.1/2"		150,0	175,0	123,8	25,0	58,7
058610-48-00	3"		178,0	210,0	152,4	32,0	71,4

Invändig SAE-gänga, 45° kona, SAE J516/ J512

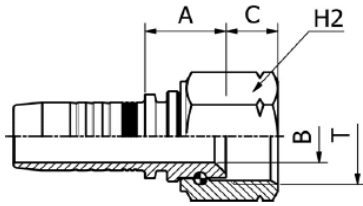

Art.nr.	Slangdim.		Gänga T	Dimensioner						
	DN	Tum		B	A	C	H2	Mutter		
4562-04-04	6	1/4"	7/16"-20	4,0	15,5	8,7	17,0	ST		
4562-06-05	8	5/16"	5/8"-18	7,0	16,0	10,8	22,0	ST		
4562-06-06	10	3/8"	5/8"-18	7,0	16,5	10,8	22,0	ST		
4562-12-12	19	3/4"	1.1/16"-14	15,0	22,5	14,4	32,0	ST		

Muttertyp: ST = Stiftad

90° invändig SAE-gänga, 45° kona, SAE J516/ J512

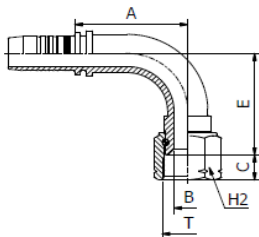

Art.nr.	Slangdim.		Gänga T	Dimensioner						
	DN	Tum		B	A	C	E	H2	Mutter	
4569-04-04	6	1/4"	7/16"-20	4,0	28,5	8,7	27,0	17,0	ST	
4569-06-06	10	3/8"	5/8"-18	7,0	35,5	10,8	33,0	22,0	ST	
4569-12-12	19	3/4"	1.1/16"-14	15,0	62,0	14,4	58,0	32,0	ST	

Muttertyp: ST = Stiftad

Utvändig SAE-gänga o-ring, SAE J516/ ISO 11926

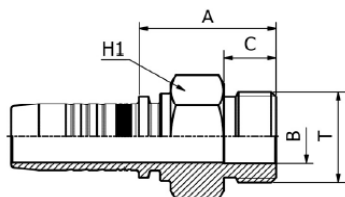

Art.nr.	Slangdim.		Gänga	Dimensioner							
	DN	Tum		T	B	A	C	H1			
4556-04-04	6	1/4"	7/16"-20		4,4	24,0	9,1	14,0			
4556-06-04	6	1/4"	9/16"-18		7,5	24,5	9,9	17,0			
4556-06-06	10	3/8"	9/16"-18		7,5	25,5	9,9	17,0			
4556-08-06	10	3/8"	3/4"-16		9,9	28,5	11,1	22,0			
4556-10-06	10	3/8"	7/8"-14		12,3	31,5	12,7	25,0			
4556-08-08	12	1/2"	3/4"-16		9,9	29,0	11,1	22,0			
4556-10-08	12	1/2"	7/8"-14		12,3	32,0	12,7	25,0			
4556-12-08	12	1/2"	1.1/16"-12		15,5	38,5	15,1	32,0			
4556-10-10	16	5/8"	7/8"-14		12,5	32,0	12,7	25,0			
4556-12-10	16	5/8"	1.1/16"-12		15,5	37,5	15,1	32,0			
4556-12-12	19	3/4"	1.1/16"-12		15,5	39,5	15,1	32,0			
4556-16-12	19	3/4"	1.5/16"-12		21,5	40,0	15,1	38,0			
4556-16-16	25	1"	1.5/16"-12		21,5	41,0	15,1	38,0			
4556-20-20	31	1.1/4"	1.5/8"-12		27,5	43,5	15,1	46,0			

Utv. SAE-gänga o-ring svivlande, SAE J516/ ISO 11926

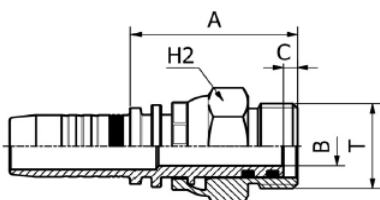

Art.nr.	Slangdim.		Gänga	Dimensioner							
	DN	Tum		T	B	A	C	H2			
4597-04-04	6	1/4"	7/16"-20		4,0	43,0	9,1	17,0			
4597-06-04	6	1/4"	9/16"-18		7,0	44,0	9,9	22,0			
4597-06-06	10	3/8"	9/16"-18		7,0	48,0	9,9	22,0			
4597-08-06	10	3/8"	3/4"-16		9,3	47,0	11,1	22,0			
4597-08-08	12	1/2"	3/4"-16		9,3	53,0	11,1	27,0			
4597-10-08	12	1/2"	7/8"-14		9,3	41,5	13,0	27,0			
4597-12-08	12	1/2"	1.1/6"-12		12,5	49,5	15,0	32,0			
4597-10-10	16	5/8"	7/8"-14		9,3	41,5	13,0	27,0			
4597-12-12	19	3/4"	1.1/16"-12		12,5	50,5	15,0	32,0			

90° utv. SAE-gänga o-ring svivlande, SAE J516/ ISO 11926

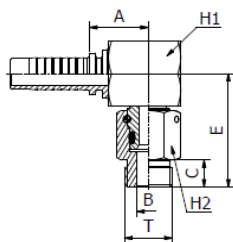

Art.nr.	Slangdim.		Gänga T	Dimensioner						
	DN	Tum		B	A	C	E	H1	H2	
4598-06-06	10	3/8"	9/16"-18	5,7	20,0	9,9	40,0	22,0	17,0	
4598-08-06	10	3/8"	3/4"-16	9,3	20,0	11,1	44,5	22,0	22,0	
4598-08-08	12	1/2"	3/4"-16	9,3	23,5	11,1	47,0	27,0	22,0	
4598-10-08	12	1/2"	7/8"-14	9,8	23,5	13,0	47,0	27,0	27,0	
4598-10-10	16	5/8"	7/8"-14	9,8	23,5	13,0	47,0	27,0	27,0	
4598-12-12	19	3/4"	1.1/16"-12	13,0	28,0	15,0	58,5	34,0	32,0	

Invändig NPSM-gänga 60° kona, SAE J516/ J514

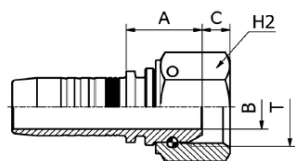

Art.nr.	Slangdim.		Gänga T	Dimensioner						
	DN	Tum		B	A	C	H2	Mutter		
4523-04-04	6	1/4"	1/4"-18	4,0	17,5	4,2	19,0	ST		
4523-04-06	10	3/8"	1/4"-18	4,1	18,0	4,2	19,0	ST		
4523-06-06	10	3/8"	3/8"-18	7,0	21,0	6,0	22,0	ST		
4523-08-08	12	1/2"	1/2"-14	9,3	23,0	6,5	27,0	ST		
4523-12-12	19	3/4"	3/4"-14	15,0	24,5	9,0	32,0	ST		
4523-16-16	25	1"	1"-11,5	19,8	27,5	10,5	38,0	ST		

JIS metrisk invändig 60° kona (Komatsu), JIS B 8363

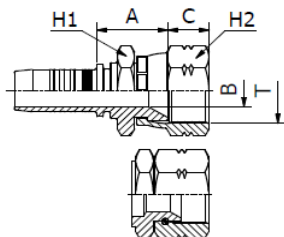

Art.nr.	Slangdim.		Gänga	Dimensioner							Mutter
	DN	Tum		T	B	A	C	H1	H2		
4561-14-04	6	1/4"	M 14x1,5	4,0	23,0	15,5	19,0	19,0		PR	
4561-18-04	6	1/4"	M 18x1,5	7,0	22,5	11,5	24,0	24,0		PR	
4561-16-05	8	5/16"	M 16x1,5	5,5	22,5	9,3	21,0	21,0		PR	
4561-14-06	10	3/8"	M 14x1,5	4,0	23,5	10,5	19,0	19,0		PR	
4561-18-06	10	3/8"	M 18x1,5	7,0	23,5	11,5	24,0	24,0		PR	
4561-22-08	12	1/2"	M 22x1,5	9,3	25,0	13,0	27,0	27,0		PR	
4561-24-10	16	5/8"	M 24x1,5	12,5	26,5	15,1	32,0	32,0		PR	
4561-30-12	19	3/4"	M 30x1,5	15,0	31,5	18,3	36,0	36,0		PR	
4561-33-16	25	1"	M 33x1,5	19,8	33,5	21,3	41,0	41,0		PR	
4561-36-20	31	1.1/4"	M 36x1,5	19,8	41,0	20,0	46,0	46,0		PR	
4561-42-24	38	1.1/2"	M 42x1,5	26,0	44,0	18,8	55,0	55,0		ST	

Muttertyp: PR = Pressad, ST = Stiftad

90° JIS invändig metrisk 60° kona

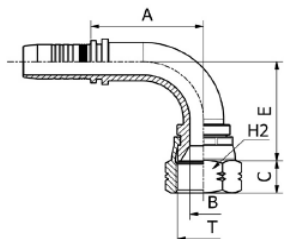

Art.nr.	Slangdim.		Gänga	Dimensioner							Mutter
	DN	Tum		T	B	A	C	E	H2		
4566-14-04	6	1/4"	M 14x1,5	4,0	29,0	10,5	28,5	19,0		PR	
4566-18-06	10	3/8"	M 18x1,5	7,0	35,5	11,5	34,0	24,0		PR	
4566-22-08	12	1/2"	M 22x1,5	9,3	44,0	13,0	40,0	27,0		PR	
4566-24-10	16	5/8"	M 24x1,5	12,5	53,5	15,2	47,0	32,0		PR	
4566-30-12	19	3/4"	M 30x1,5	15,0	61,5	18,3	56,5	36,0		PR	

Muttertyp: PR = Pressad

JIS invändig BSP 60° kona (Toyota), JIS B 8363

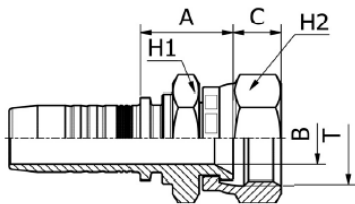

Art.nr.	Slangdim.		Gänga	Dimensioner							Mutter
	DN	Tum		T	B	A	C	H1	H2		
4564-04-04	6	1/4"	1/4"-19	4,0	18,5	8,3	19,0	19,0		PR	
4564-06-06	10	3/8"	3/8"-19	7,0	23,0	10,0	22,0	22,0		PR	
4564-08-08	12	1/2"	1/2"-14	9,3	22,0	11,5	27,0	27,0		PR	
4564-12-12	19	3/4"	3/4"-14	15,0	26,0	13,5	32,0	32,0		PR	
4564-16-16	25	1"	1"-11	19,8	30,5	14,5	38,0	38,0		PR	

Muttertyp: PR = Pressad

JIS invändig BSP 60° kona (Nissan), JIS B 8363

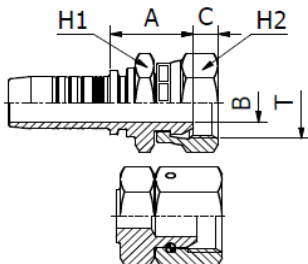

Art.nr.	Slangdim.		Gänga	Dimensioner							Mutter
	DN	Tum		T	B	A	C	H1	H2		
4565-04-04	6	1/4"	1/4"-19	4,0	22,5	4,5	19,0	19,0		PR	
4565-06-06	10	3/8"	3/8"-19	7,0	24,5	6,4	22,0	22,0		PR	
4565-08-08	12	1/2"	1/2"-14	9,3	26,5	6,7	27,0	27,0		PR	
4565-08-10	16	5/8"	1/2"-14	9,3	29,0	6,5	27,0	27,0		ST	
4565-12-10	16	5/8"	3/4"-14	15,0	30,5	9,0	32,0	32,0		ST	
4565-12-12	19	3/4"	3/4"-14	15,0	30,0	8,9	32,0	32,0		PR	
4565-16-16	25	1"	1"-11	19,8	35,5	10,5	38,0	38,0		ST	
4565-20-20	31	1.1/4"	1.1/4"-11	26,0	44,5	12,5	50,0	50,0		ST	

Muttertyp: PR = Pressad, ST = Stiftad

Rak Komatsu fläns

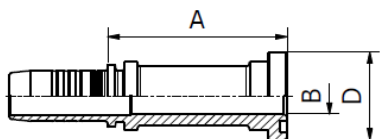

Art.nr.	Slangdim.		Fläns Tum	Dimensioner							
	DN	Tum		B	A	D					
4586-10-08	12	1/2"	5/8"	14,0	66,0	34,0					
4586-10-10	16	5/8"	5/8"	14,0	65,5	34,0					
4586-10-12	19	3/4"	5/8"	14,0	66,5	34,0					

90° Komatsu fläns

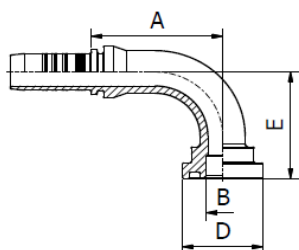

Art.nr.	Slangdim.		Fläns Tum	Dimensioner							
	DN	Tum		B	A	C	E				
4587-10-10	16	5/8"	5/8"	14,0	56,0	34,0	47,5				
4587-10-12	19	3/4"	5/8"	14,0	56,0	34,0	47,5				

45° Komatsu fläns

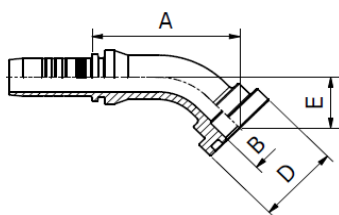

Art.nr.	Slangdim.		Fläns Tum	Dimensioner							
	DN	Tum		B	A	C	E				
4588-10-10	16	5/8"	5/8"	14,0	61,0	34,0	22,0				

Invändig fransk metrisk, typ Gaz

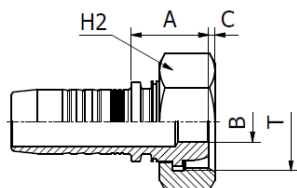

Art.nr.	Slangdim.		Gänga T	Rör mm	Dimensioner			H2	Mutter
	DN	Tum			B	A	C		
4571-20-04	6	1/4"	M 20x1,5	13,25	7,0	22,0	4,0	24,0	SL
4571-20-05	8	5/16"	M 20x1,5	13,25	7,0	22,0	4,0	24,0	SL
4571-20-06	10	3/8"	M 20x1,5	13,25	7,0	22,5	4,0	24,0	SL
4571-24-06	10	3/8"	M 24x1,5	16,75	9,3	25,5	3,5	30,0	SL
4571-24-08	12	1/2"	M 24x1,5	16,75	9,3	26,0	3,5	30,0	SL
4571-30-08	12	1/2"	M 30x1,5	21,25	12,5	23,5	2,0	36,0	SL
4571-30-10	16	5/8"	M 30x1,5	21,25	12,5	23,5	2,0	36,0	SL
4571-36-12	19	3/4"	M 36x1,5	26,75	15,0	27,0	4,7	41,0	SL
4571-45-16	25	1"	M 45x1,5	33,50	19,8	27,0	4,5	50,0	SL

Muttertyp: SL = Slip-on

90° invändig fransk metrisk, typ Gaz

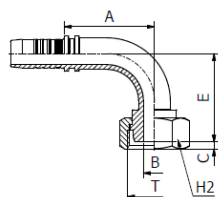

Art.nr.	Slangdim.		Gänga T	Rör mm	Dimensioner			E	H2	Mutter
	DN	Tum			B	A	C			
4573-20-05	8	5/16"	M 20x1,5	13,25	7,0	32,0	4,0	29,5	24,0	SL
4573-20-06	10	3/8"	M 20x1,5	13,25	7,0	36,5	4,0	33,5	24,0	SL
4573-24-08	12	1/2"	M 24x1,5	16,75	12,0	45,0	3,5	41,0	30,0	SL
4573-30-10	16	5/8"	M 30x1,5	21,25	12,5	51,5	2,0	53,5	36,0	SL
4573-36-12	19	3/4"	M 36x1,5	26,75	15,0	61,5	4,7	60,0	41,0	SL

Muttertyp: SL = Slip-on

Utvändig fransk metrisk, typ Gaz

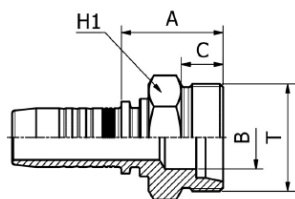

Art.nr.	Slangdim.		Gänga T	Rör mm	Dimensioner						
	DN	Tum			B	A	C	H1			
4572-20-05	8	5/16"	M 20x1,5	13,25	8,0	27,0	12,0	22,0			
4572-20-06	10	3/8"	M 20x1,5	13,25	8,0	27,5	12,0	22,0			
4572-24-06	10	3/8"	M 24x1,5	16,75	12,0	28,0	12,0	24,0			
4572-24-08	12	1/2"	M 24x1,5	16,75	12,0	28,5	12,0	24,0			
4572-30-10	16	5/8"	M 30x1,5	21,25	15,0	31,5	14,0	30,0			
4572-36-12	19	3/4"	M 36x1,5	26,75	21,0	34,0	14,0	36,0			
4572-45-16	25	1"	M 45x1,5	33,50	26,0	39,5	16,0	46,0			

Rak Supercat fläns

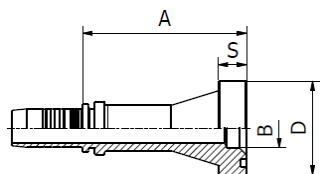

Art.nr.	Slangdim.		Fläns Tum	Dimensioner							
	DN	Tum		B	A	D	S				
4576-12-12	19	3/4"	3/4"	15,0	74,5	41,5	14,3				
4576-16-12	19	3/4"	1"	19,8	83,5	47,7	14,3				
4576-16-16	25	1"	1"	19,8	87,0	47,7	14,3				
4576-20-16	25	1"	1.1/4"	26,0	92,5	54,0	14,3				
4576-20-20	31	1.1/4"	1.1/4"	26,0	86,0	54,0	14,3				
4576-24-24	38	1.1/2"	1.1/2"	32,0	94,0	63,6	14,3				

90° Supercat fläns

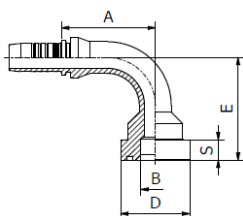

Art.nr.	Slangdim.		Fläns Tum	Dimensioner							
	DN	Tum		B	A	D	E	S			
4577-12-12	19	3/4"	3/4"	15,0	64,5	41,5	64,5	14,3			
4577-16-16	25	1"	1"	19,8	77,5	47,7	76,5	14,3			
4577-20-16	25	1"	1.1/4"	26,0	75,5	54,0	80,5	14,3			
4577-20-20	31	1.1/4"	1.1/4"	26,0	85,5	54,0	87,0	14,3			
4577-24-20	31	1.1/4"	1.1/2"	32,0	85,5	63,7	93,0	14,3			

45° Supercat fläns

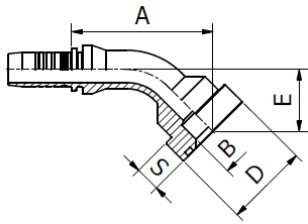

Art.nr.	Slangdim.		Fläns	Dimensioner						
	DN	Tum	Tum	B	A	D	E	S		
4578-12-12	19	3/4"	3/4"	15,0	77,0	41,5	32,0	14,3		
4578-16-16	25	1"	1"	19,8	89,5	47,7	36,5	14,3		
4578-20-16	25	1"	1.1/4"	26,0	92,5	54,0	40,5	14,3		
4578-20-20	31	1.1/4"	1.1/4"	26,0	99,0	54,0	41,5	14,3		
4578-24-24	38	1.1/2"	1.1/2"	32,0	119,0	63,6	45,5	14,3		

Banjo BSP

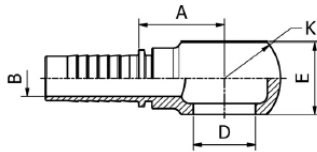

Art.nr.	Slangdim.		Gänga T	Dimensioner						
	DN	Tum		B	A	D	E	K		
4550-04-04	6	1/4"	1/4"-19	4,4	22,0	13,25	15,0	24,0		
4550-06-04	6	1/4"	3/8"-19	4,4	23,5	16,7	18,0	28,0		
4550-04-05	8	5/16"	1/4"-19	5,0	23,0	13,2	14,0	24,0		
4550-06-05	8	5/16"	3/8"-19	5,6	23,0	16,7	20,0	29,0		
4550-06-06	10	3/8"	3/8"-19	7,0	24,5	16,7	20,0	29,0		
4550-08-06	10	3/8"	1/2"-14	7,1	27,0	21,0	25,0	38,0		
4550-08-08	12	1/2"	1/2"-14	9,8	27,5	21,0	25,0	38,0		
4550-10-10	16	5/8"	5/8"-14	12,7	29,5	23,0	27,0	40,0		
4550-12-12	19	3/4"	3/4"-14	15,5	36,5	26,5	31,0	48,0		
4550-16-16	25	1"	1"-11	20,5	40,5	33,3	42,0	60,0		

Banjo metrisk, DIN 7642

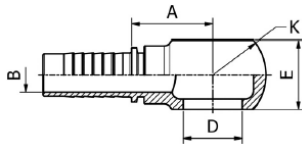

Art.nr.	Slangdim.		Gänga T	Dimensioner						
	DN	Tum		B	A	D	E	K		
4550-12-04	6	1/4"	M 12x1,5	4,4	22,5	12,0	12,0	20,0		
4550-14-04	6	1/4"	M 14x1,5	4,4	23,5	14,0	14,0	24,0		
4550-14-05	8	5/16"	M 14x1,5	5,6	23,5	14,0	14,0	24,0		
4550-14-06	10	3/8"	M 14x1,5	7,1	25,0	14,0	14,0	24,0		
4550-16-06	10	3/8"	M 16x1,5	7,1	25,0	16,0	16,0	28,0		
4550-18-06	10	3/8"	M 18x1,5	7,1	27,0	18,0	20,0	32,0		
4550-18-08	12	1/2"	M 18x1,5	9,8	28,0	18,0	20,0	32,0		
4550-22-08	12	1/2"	M 22x1,5	9,8	31,0	22,0	25,0	39,0		
4550-22-10	16	5/8"	M 22x1,5	12,7	31,0	22,0	25,0	39,0		
4550-26-12	19	3/4"	M 26x1,5	15,5	34,5	26,0	30,0	46,0		

Banjobult BSP

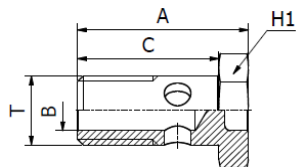

Art.nr.			Gänga	Dimensioner						
			T	B	A	C	H1			
4451-04-00			1/4"-19	6,0	34,5	28,5	17,0			
4451-06-00			3/8"-19	9,0	45,5	38,5	22,0			
4451-08-00			1/2"-14	13,0	52,0	44,0	27,0			
4451-10-00			5/8"-14	15,0	56,5	48,5	30,0			
4451-12-00			3/4"-14	18,0	64,0	54,0	32,0			
4451-16-00			1"-11	24,0	77,5	68,5	41,0			

Banjobult metrisk, DIN 7643

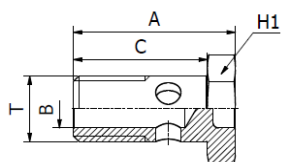

Art.nr.			Gänga	Dimensioner						
			T	B	A	C	H1			
4452-12-00			M 12x1,5	7,0	29,0	24,0	17,0			
4452-14-00			M 14x1,5	9,0	31,0	26,0	19,0			
4452-16-00			M 16x1,5	11,0	33,0	28,0	22,0			
4452-18-00			M 18x1,5	13,0	37,0	32,0	24,0			
4452-22-00			M 22x1,5	16,0	45,0	39,0	27,0			
4452-26-00			M 26x1,5	20,0	51,0	45,0	32,0			

Skarv, dubbel

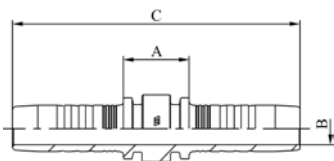

Art.nr.	Slangdim.		Dimensioner						
	DN	Tum	B	A	C				
4589-03-03	5	3/16"	3,0	15,5	58,2				
4589-04-04	6	1/4"	4,0	14,0	69,0				
4589-05-05	8	5/16"	5,5	14,0	70,0				
4589-06-06	10	3/8"	7,0	14,5	73,5				
4589-08-08	12	1/2"	9,3	15,5	77,9				
4589-10-10	16	5/8"	12,5	15,5	84,0				
4589-12-12	19	3/4"	15,0	18,5	91,5				
4589-16-16	25	1"	19,8	22,5	119,0				
4589-20-20	31	1.1/4"	26,0	23,0	128,1				
4589-24-24	38	1.1/2"	32,0	23,5	147,5				

Invändig metrisk gänga (typ Kärcher)

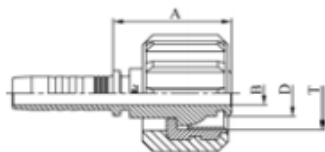

Art.nr.	Slangdim.		Gänga	Dimensioner						
	DN	Tum	T	B	A	D				
4599-22-04	6	1/4"	M 22x1,5	4,0	34,0	13,9				
4599-22-05	8	5/16"	M 22x1,5	5,5	34,0	13,9				
4599-22-06	10	3/8"	M 22x1,5	7,0	34,5	13,9				

Rak WEO/ Easyfit anslutning

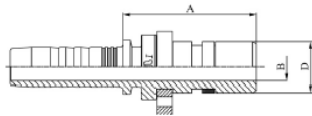

Art.nr.	Slangdim.		Arb. Tryck	Dimensioner							
	DN	Tum		Bar	B	A	D				
4462-04-04	6	1/4"	350		4,0	30,0	10,0				
4462-06-04	6	1/4"	350		7,0	34,0	13,0				
4462-06-05	8	5/16"	350		7,0	34,0	13,0				
4462-04-06	10	3/8"	350		4,0	30,5	10,0				
4462-06-06	10	3/8"	350		7,0	34,5	13,0				
4462-08-06	10	3/8"	350		9,3	34,5	16,0				
4462-06-08	12	1/2"	350		7,0	35,0	13,0				
4462-08-08	12	1/2"	350		9,3	35,0	16,0				
4462-08-10	16	5/8"	350		9,3	35,0	16,0				
4462-12-10	16	5/8"	280		15,0	44,5	23,0				
4462-12-12	19	3/4"	280		15,0	44,5	23,0				

90° WEO/ Easyfit anslutning

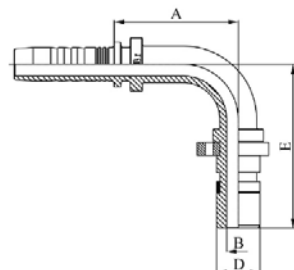

Art.nr.	Slangdim.		Arb. Tryck	Dimensioner							
	DN	Tum		Bar	B	A	D	E			
4463-04-04	6	1/4"	350		4,0	30,0	10,0	40,0			
4463-06-04	6	1/4"	350		7,0	32,0	13,0	45,0			
4463-06-05	8	5/16"	350		7,0	33,5	13,0	46,5			
4463-04-06	10	3/8"	350		4,0	30,5	10,0	40,0			
4463-06-06	10	3/8"	350		7,0	37,0	13,0	49,5			
4463-06-08	12	1/2"	350		7,0	37,5	13,0	49,5			
4463-08-08	12	1/2"	350		9,3	44,0	16,0	55,0			
4463-08-10	16	5/8"	350		9,3	47,0	16,0	55,0			
4463-12-10	16	5/8"	280		15,0	55,0	23,0	74,5			
4463-12-12	19	3/4"	280		15,0	62,5	23,0	79,0			

45° WEO/ Easyfit anslutning

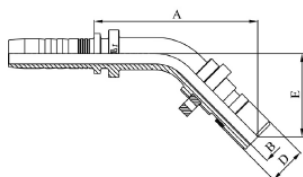

Art.nr.	Slangdim.		Arb. Tryck	Dimensioner							
	DN	Tum		Bar	B	A	D	E			
4464-04-04	6	1/4"	350		4,0	46,0	10,0	23,5			
4464-06-04	6	1/4"	350		7,0	52,0	13,0	27,0			
4464-06-05	8	5/16"	350		7,0	53,0	13,0	27,5			
4464-04-06	10	3/8"	350		4,0	47,0	10,0	23,5			
4464-06-06	10	3/8"	350		7,0	55,5	13,0	28,0			
4464-08-08	12	1/2"	350		9,3	61,5	16,0	30,0			
4464-08-10	16	5/8"	350		9,3	65,0	16,0	30,0			
4464-12-10	16	5/8"	280		15,0	79,0	23,0	41,0			
4464-12-12	19	3/4"	280		15,0	85,5	23,0	42,5			

Rak invändig WEO/ Easyfit anslutning

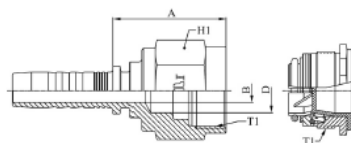

Art.nr.	Slangdim.		Gänga	Arb. Tryck	Dimensioner							
	DN	Tum			T1	Bar	B	A	D	H1		
4461-04-04	6	1/4"	M 18x1	350	4,0	30,0	10,0	22,0				
4461-06-06	10	3/8"	M 22x1	350	7,0	33,5	13,0	25,0				
4461-08-08	12	1/2"	M 25x1	350	9,3	34,0	16,0	28,0				
4461-08-10	16	5/8"	M 25x1	350	12,5	34,0	23,0	28,0				
4461-12-10	16	5/8"	M 33x1,5	280	12,5	45,5	23,0	38,0				
4461-12-12	19	3/4"	M 33x1,5	280	15,0	46,5	23,0	38,0				

WEO Hondel utv. BSP DIN 3852-2 typ A/ Easyfit anslutning

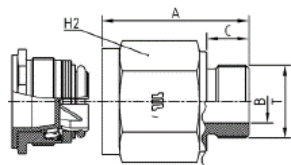

Art.nr.	Slangdim.		Gänga	Arb. Tryck	Dimensioner						
	DN	Tum	T	Bar	B	A	C	D	H2		
035810-04-04	6	1/4"	G 1/4"	350	4,5	34,0	12,0	10,0	22		
035810-06-06	10	3/8"	G 3/8"	350	7,0	36,5	12,0	13,0	25		
035810-08-08	12	1/2"	G 1/2"	350	9,5	40,0	14,0	16,0	28		
035810-12-12	19	3/4"	G 3/4"	280	15,0	50,5	16,0	23,0	38		

WEO Hondel utv. BSP ISO 1179-2 med ED-tätning/ Easyfit anslutning

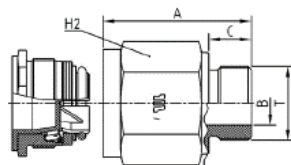

Art.nr.	Slangdim.		Gänga	Arb. Tryck	Dimensioner						
	DN	Tum	T	Bar	B	A	C	D	H2		
035830-04-04	6	1/4"	G 1/4"	350	4,5	34,0	12,0	10,0	22		
035830-06-06	10	3/8"	G 3/8"	350	7,0	36,5	12,0	13,0	25		
035830-08-08	12	1/2"	G 1/2"	350	9,5	40,0	14,0	16,0	28		
035830-12-12	19	3/4"	G 3/4"	280	15,0	50,5	16,0	23,0	38		

Andra adaptertyper på förfrågan

WEO Hanplugg/ Easyfit anslutning

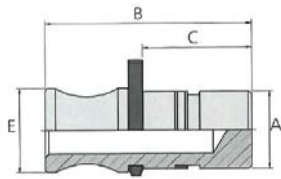

Art.nr.	Slangdim.		Arb. Tryck	Dimensioner							
	DN	Tum		Bar	B	A	C	E			
035723-04-00	6	1/4"	350	43,0	10,0	19,0	12,0				
035723-06-00	10	3/8"	350	50,0	13,0	22,0	16,0				
035723-08-00	12	1/2"	350	50,0	16,0	22,0	19,0				
035723-12-00	19	3/4"	280	59,0	23,0	31,0	25,0				

Andra varianter på förfrågan

6910 Presshysla Interlock Plus (4 wire)

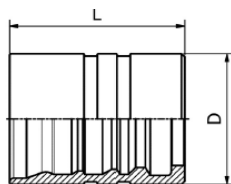

Art.nr.	Slangdim.		Dimensioner							
	DN	Tum			D	L				
6910-10	16	5/8"			35,0	40,9				
6910-12	19	3/4"			40,0	51,4				
6910-16	25	1"			48,0	64,5				
6910-20	31	1.1/4"			57,0	84,0				
6910-24	38	1.1/2"			64,3	94,0				
6910-32	51	2"			83,5	107,0				
6910-40	63	2 1/2"			100,0	135,0				
6910-48	76	3"			107,0	125,0				

6915 Presshysla Interlock Plus (6 wire)

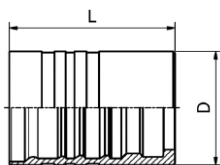

Art.nr.	Slangdim.		Dimensioner							
	DN	Tum			D	L				
6915-20	31	1.1/4"			60,0	85,0				
6915-24	38	1.1/2"			69,0	96,0				

6315 Presshysla Interlock Plus/ Interlock Super (6 wire)

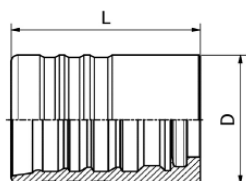

Art.nr.	Slangdim.		Dimensioner							
	DN	Tum			D	L				
6315-12	19	3/4"			45,1	51,4				
6315-16	25	1"			53,5	64,5				
6315-20	31	1.1/4"			65,0	88,2				
6315-32	51	2"			86,5	108,0				
6315-40	63	2 1/2"			103,0	135,0				
6315-48	76	3"			113,5	125,0				

IL Plus invändig BSP med o-ring, BS 5200/ ISO 12151-6

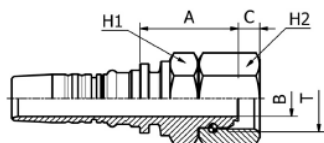

Art.nr.	Slangdim.		Gänga	Dimensioner							Mutter
	DN	Tum		T	B	A	C	H1	H2		
6901-12-12	19	3/4"	3/4"-14	14,5	39,0	8,5	32,0	32,0		ST	
6901-16-12	19	3/4"	1"-11	19,0	36,5	10,6	32,0	41,0		ST	
6901-12-16	25	1"	3/4"-14	15,0	35,0	8,5	41,0	32,0		ST	
6901-16-16	25	1"	1"-11	19,5	44,5	10,6	41,0	41,0		ST	
6901-20-16	25	1"	1.1/4"-11	26,1	41,0	10,5	41,0	50,0		ST	
6901-16-20	31	1.1/4"	1"-11	19,0	44,5	10,6	50,0	41,0		ST	
6901-20-20	31	1.1/4"	1.1/4"-11	26,1	52,5	10,5	50,0	50,0		ST	
6901-24-20	31	1.1/4"	1.1/2"-11	32,1	46,0	12,5	50,0	60,0		ST	
6901-20-24	38	1.1/2"	1.1/4"-11	26,1	48,5	10,5	60,0	50,0		ST	
6901-24-24	38	1.1/2"	1.1/2"-11	32,1	51,5	12,5	60,0	60,0		ST	
6901-32-32	51	2"	2"-11	42,0	51,5	16,1	71,0	70,0		ST	

Muttertyp: ST = Stiftad

IL Plus 90° invändig BSP med o-ring, BS5200/ ISO 12151-6

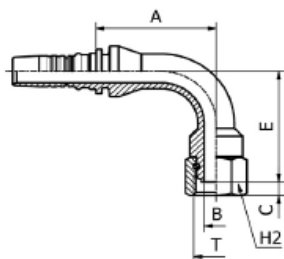

Art.nr.	Slangdim.		Gänga	Dimensioner							Mutter
	DN	Tum		T	B	A	C	E	H2		
6903-12-12	19	3/4"	3/4"-14	14,5	72,5	8,5	70,0	32,0		ST	
6903-16-12	19	3/4"	1"-11	19,0	72,5	10,6	71,0	41,0		ST	
6903-16-16	25	1"	1"-11	19,5	82,0	10,6	80,5	41,0		ST	
6903-20-16	25	1"	1.1/4"-11	26,1	95,0	10,5	78,5	50,0		ST	
6903-20-20	31	1.1/4"	1.1/4"-11	26,1	98,5	10,5	98,0	50,0		ST	
6903-24-20	31	1.1/4"	1.1/2"-11	32,1	98,5	12,5	84,5	60,0		ST	
6903-24-24	38	1.1/2"	1.1/2"-11	32,1	111,5	12,5	109,0	60,0		ST	
6903-32-32	51	2"	2"-11	42,0	143,0	16,1	140,5	70,0		ST	

Muttertyp: ST = Stiftad

IL Plus 45° invändig BSP med o-ring, BS5200/ ISO 12151-6

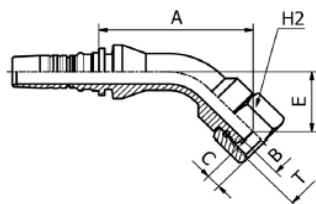

Art.nr.	Slangdim.		Gänga	Dimensioner							Mutter
	DN	Tum		T	B	A	C	E	H2		
6904-12-12	19	3/4"	3/4"-14	14,5	88,0	8,5	35,0	32,0	ST		
6904-16-12	19	3/4"	1"-11	19,0	89,5	10,6	36,5	41,0	ST		
6904-12-16	25	1"	3/4"-14	15,0	105,5	8,5	36,0	32,0	ST		
6904-16-16	25	1"	1"-11	19,5	97,0	10,6	40,0	41,0	ST		
6904-20-16	25	1"	1.1/4"-11	26,1	108,5	10,5	38,0	50,0	ST		
6904-16-20	31	1.1/4"	1"-11	19,0	118,0	10,6	47,5	41,0	ST		
6904-20-20	31	1.1/4"	1.1/4"-11	26,1	120,0	10,5	49,5	50,0	ST		
6904-24-20	31	1.1/4"	1.1/2"-11	32,1	114,5	12,5	40,0	60,0	ST		
6904-24-24	38	1.1/2"	1.1/2"-11	32,1	126,5	12,5	50,0	60,0	ST		
6904-32-32	51	2"	2"-11	42,0	162,5	16,1	66,5	70,0	ST		

Muttertyp: ST = Stiftad

IL Plus utvändig BSP 60° kona, BS5200/ ISO 8434-6

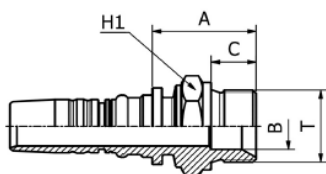

Art.nr.	Slangdim.		Gänga	Dimensioner						
	DN	Tum		T	B	A	C	H1		
6902-12-12	19	3/4"	3/4"-14	17,0	37,0	16,0	32,0			
6902-16-12	19	3/4"	1"-11	22,5	43,0	19,0	41,0			
6902-16-16	25	1"	1"-11	22,5	43,0	19,0	41,0			
6902-20-16	25	1"	1.1/4"-11	28,5	48,0	20,0	50,0			
6902-20-20	31	1.1/4"	1.1/4"-11	28,5	50,5	20,0	50,0			
6902-24-24	38	1.1/2"	1.1/2"-11	33,5	54,5	22,0	55,0			
6902-32-32	51	2"	2"-11	42,0	58,0	25,0	70,0			

IL Plus inv. metrisk DKOS 24° kona, DIN 20066/ ISO 12151-2

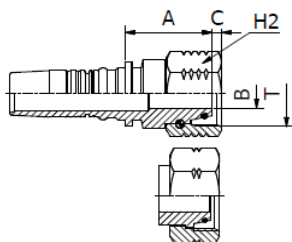

Art.nr.	Slangdim.		Gänga	Rör	Dimensioner					
	DN	Tum			T	mm	B	A	C	H2
6919-16-10	16	5/8"	M 24x1,5	16	9,3	31,0	4,0		30,0	ST
6919-20-10	16	5/8"	M 30x2	20	12,0	37,0	3,5		36,0	SL
6919-20-12	19	3/4"	M 30x2	20	12,5	44,0	3,2		36,0	ST
6919-25-12	19	3/4"	M 36x2	25	14,5	42,0	3,4		41,0	SL
6919-30-12	19	3/4"	M 42x2	30	19,0	36,0	6,3		50,0	SL
6919-25-16	25	1"	M 36x2	25	16,0	47,0	4,1		41,0	ST
6919-30-16	25	1"	M 42x2	30	19,5	46,5	5,3		50,0	SL
6919-38-16	25	1"	M 52x2	38	26,1	49,5	8,0		60,0	SL
6919-30-20	31	1.1/4"	M 42x2	30	19,0	47,5	6,0		50,0	ST
6919-38-20	31	1.1/4"	M 52x2	38	26,1	41,5	8,0		60,0	SL
6919-38-24	38	1.1/2"	M 52x2	38	29,0	52,5	8,8		60,0	ST

Muttertyp: ST = Stiftad, SL = Slip-on

IL Plus utv. Metrisk 24° kona, serie S, DIN 20066/ ISO 12151-2

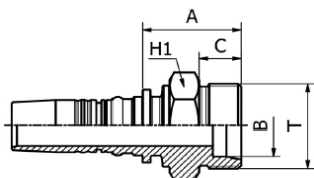

Art.nr.	Slangdim.		Gänga	Rör	Dimensioner					
	DN	Tum			T	mm	B	A	C	H1
6914-20-10	16	5/8"	M 30x2	20	12,0	37,0	16,0	30,0		
6914-20-12	19	3/4"	M 30x2	20	14,5	38,5	16,0	32,0		
6914-25-12	19	3/4"	M 36x2	25	14,5	43,5	18,0	36,0		
6914-25-16	25	1"	M 36x2	25	19,5	45,0	18,0	36,0		
6914-30-16	25	1"	M 42x2	30	19,5	47,0	20,0	46,0		
6914-38-20	31	1.1/4"	M 52x2	38	25,0	55,0	22,0	55,0		
6914-38-24	38	1.1/2"	M 52x2	38	31,0	55,5	22,0	55,0		

IL Plus 90° inv. metrisk DKOS 24° kona, DIN 20066/ ISO 12151-2

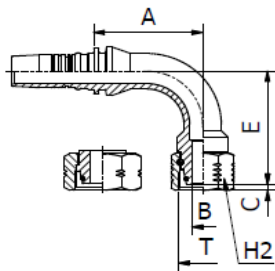

Art.nr.	Slangdim.		Gänga	Rör	Dimensioner						Mutter
	DN	Tum			T	mm	B	A	C	E	
6948-20-10	16	5/8"	M 30x2	20	12,0	52,5	3,5	57,5	36,0		SL
6948-20-12	19	3/4"	M 30x2	20	12,5	64,0	3,2	68,5	36,0		ST
6948-25-12	19	3/4"	M 36x2	25	14,5	67,0	3,4	67,5	41,0		SL
6948-25-16	25	1"	M 36x2	25	16,0	81,5	4,1	89,0	41,0		ST
6948-30-16	25	1"	M 42x2	30	19,5	81,5	5,3	75,5	50,0		SL
6948-30-20	31	1.1/4"	M 42x2	30	19,1	103,5	6,0	90,0	50,0		ST
6948-38-20	31	1.1/4"	M 52x2	38	26,1	100,0	8,0	86,5	60,0		SL

Muttertyp: ST = Stiftad, SL = Slip-on

Long drop på förfrågan, kontakta Kundservice

IL Plus 45° inv. metrisk DKOS 24° kona, DIN 20066/ ISO 12151-2

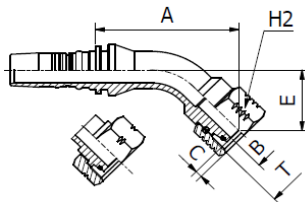

Art.nr.	Slangdim.		Gänga	Rör	Dimensioner						Mutter
	DN	Tum			T	mm	B	A	C	E	
6949-20-10	16	5/8"	M 30x2	20	12,0	66,5	3,5	29,5	36,0		SL
6949-20-12	19	3/4"	M 30x2	20	12,5	79,0	3,2	35,0	36,0		ST
6949-25-12	19	3/4"	M 36x2	25	14,5	81,0	3,4	33,5	41,0		SL
6949-25-16	25	1"	M 36x2	25	16,0	103,0	4,1	45,5	41,0		ST
6949-30-16	25	1"	M 42x2	30	19,5	93,0	5,3	36,0	50,0		SL
6949-30-20	31	1.1/4"	M 42x2	30	19,1	116,5	6,0	44,5	50,0		ST
6949-38-20	31	1.1/4"	M 52x2	38	26,1	110,0	8,0	40,0	60,0		SL
6949-38-24	38	1.1/2"	M 52x2	38	29,0	128,0	8,8	51,5	60,0		ST

Muttertyp: ST = Stiftad, SL = Slip-on

Long drop på förfrågan, kontakta Kundservice

IL Plus invändig JIC-gänga 37° kona, SAE J516/ ISO 12151-5

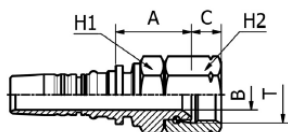

Art.nr.	Slangdim.		Gänga T	Dimensioner							Mutter
	DN	Tum		B	A	C	H1	H2			
6921-12-12	19	3/4"	1.1/16"-12	15,0	36,0	14,2	32,0	32,0		ST	
6921-16-12	19	3/4"	1.5/16"-12	21,7	32,5	15,2	41,0	41,0		ST	
6921-16-16	25	1"	1.5/16"-12	21,7	40,5	15,2	41,0	41,0		ST	
6921-20-16	25	1"	1.5/8"-12	26,1	44,0	16,2	50,0	50,0		ST	
6921-20-20	31	1.1/4"	1.5/8"-12	26,1	51,5	16,2	50,0	50,0		ST	
6921-24-20	31	1.1/4"	1.7/8"-12	30,5	51,0	18,8	55,0	60,0		ST	
6921-24-24	38	1.1/2"	1.7/8"-12	31,0	54,5	18,8	55,0	60,0		ST	
6921-32-32	51	2"	2.1/2"-12	42,0	54,0	24,0	70,0	75,0		ST	

Muttertyp: ST = Stiftad

IL Plus utvändig JIC-gänga 37° kona, SAE J516/ ISO -512151

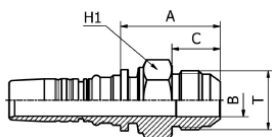

Art.nr.	Slangdim.		Gänga T	Dimensioner						
	DN	Tum		B	A	C	H1			
6922-10-10	16	5/8"	7/8"-14	12,0	41,0	19,5	27,0			
6922-12-12	19	3/4"	1.1/16"-12	15,0	45,5	22,0	32,0			
6922-16-16	25	1"	1.5/16"-12	20,0	50,5	23,0	38,0			
6922-20-16	25	1"	1.5/8"-12	26,0	57,0	24,3	42,0			
6922-20-20	31	1.1/4"	1.5/8"-12	26,1	66,0	24,3	46,0			
6922-24-24	38	1.1/2"	1.7/8"-12	32,1	64,0	27,5	50,0			
6922-32-32	51	2"	2.1/2"-12	42,0	81,0	34,0	70,0			

IL Plus 90° inv. JIC-gänga 37° kona, SAE J516/ ISO 12151-5

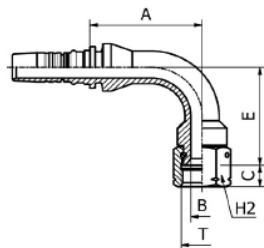

Art.nr.	Slangdim.		Gänga	Dimensioner						Mutter
	DN	Tum		T	B	A	C	E	H2	
6927-12-12	19	3/4"	1.1/16"-12	15,0	72,5	14,2	66,0	32,0	ST	
6927-16-12	19	3/4"	1.5/16"-12	21,7	72,5	15,2	71,5	41,0	ST	
6927-16-16	25	1"	1.5/16"-12	21,7	82,5	15,2	77,5	41,0	ST	
6927-20-16	25	1"	1.5/8"-12	26,1	90,5	16,2	76,5	50,0	ST	
6927-20-20	31	1.1/4"	1.5/8"-12	26,1	98,5	16,2	92,0	50,0	ST	
6927-24-20	31	1.1/4"	1.7/8"-12	32,1	101,5	18,8	108,0	60,0	ST	
6927-24-24	38	1.1/2"	1.7/8"-12	32,1	111,5	18,8	106,0	60,0	ST	
6927-32-32	51	2"	2.1/2"-12	42,0	144,5	24,0	137,0	75,0	ST	

Muttertyp: ST = Stiftad

IL Plus 45° inv. JIC-gänga 37° kona, SAE J516/ ISO 12151-5

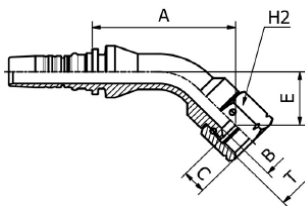

Art.nr.	Slangdim.		Gänga	Dimensioner						Mutter
	DN	Tum		T	B	A	C	E	H2	
6928-12-12	19	3/4"	1.1/16"-12	15,0	86,0	14,2	33,0	32,0	ST	
6928-16-16	25	1"	1.5/16"-12	21,7	95,0	15,2	37,0	41,0	ST	
6928-20-16	25	1"	1.5/8"-12	26,1	102,5	16,2	36,5	50,0	ST	
6928-20-20	31	1.1/4"	1.5/8"-12	26,1	115,5	16,2	45,0	50,0	ST	
6928-24-24	38	1.1/2"	1.7/8"-12	32,1	126,5	18,8	50,0	60,0	ST	
6928-32-32	51	2"	2.1/2"-12	42,0	161,5	24,0	63,5	75,0	ST	

Muttertyp: ST = Stiftad

IL Plus Rak invändig ORFS, SAE J516/ ISO 12151-1

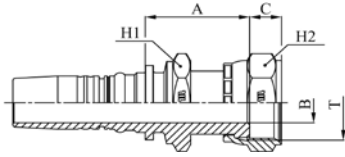

Art.nr.	Slangdim.		Gänga T	Dimensioner							Mutter
	DN	Tum		B	A	C	H1	H2			
6960-10-10	16	5/8"	1"-14	11,5	40,5	12,5	24,0	30,0		PR	
6960-12-12	19	3/4"	1.3/16"-12	14,5	48,0	13,5	32,0	36,0		PR	
6960-16-12	19	3/4"	1.7/16"-12	19,0	50,0	13,5	36,0	41,0		PR	
6960-12-16	25	1"	1.3/16"-12	14,3	50,0	13,5	41,0	36,0		PR	
6960-16-16	25	1"	1.7/16"-12	19,5	51,5	13,5	41,0	41,0		PR	
6960-20-16	25	1"	1.11/16"-12	26,0	51,5	13,6	41,0	50,0		PR	
6960-20-20	31	1.1/4"	1.11/16"-12	25,0	58,0	13,6	50,0	50,0		PR	
6960-24-24	38	1.1/2"	2"-12	31,0	60,5	14,2	60,0	60,0		PR	

Muttertyp: PR = Pressad/Pullback

IL Plus Rak invändig ORFS, SAE J516/ ISO 12151-1

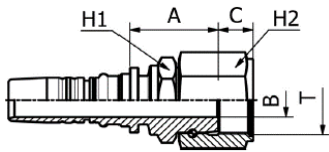

Art.nr.	Slangdim.		Gänga T	Dimensioner							Mutter
	DN	Tum		B	A	C	H1	H2			
6961-12-12	19	3/4"	1.3/16"-12	14,5	37,0	14,1	32,0	36,0		ST	
6961-16-12	19	3/4"	1.7/16"-12	19,8	41,0	15,0	41,0	46,0		ST	
6961-16-16	25	1"	1.7/16"-12	19,5	42,0	15,0	41,0	46,0		ST	
6961-20-16	25	1"	1.11/16"-12	26,0	50,0	15,1	46,0	55,0		ST	
6961-20-20	31	1.1/4"	1.11/16"-12	25,0	52,0	15,1	50,0	55,0		ST	
6961-24-20	31	1.1/4"	2"-12	31,0	53,0	15,0	55,0	60,0		ST	
6961-24-24	38	1.1/2"	2"-12	31,0	55,0	15,0	60,0	60,0		ST	

Muttertyp: ST = Stiftad

IL Plus 90° invändig ORFS, SAE J516/ ISO 12151-1

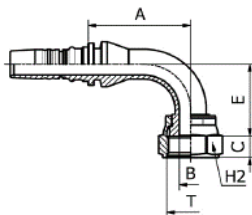

Art.nr.	Slangdim.		Gänga	Dimensioner						Mutter
	DN	Tum		T	B	A	C	E	H2	
6959-12-10	16	5/8"	1.3/16"-12	14,3	51,0	13,5	47,0	36,0	PR	
6959-12-12	19	3/4"	1.3/16"-12	14,5	65,0	13,5	48,0	36,0	PR	
6959-16-12	19	3/4"	1.7/16"-12	19,0	70,0	13,5	53,0	41,0	PR	
6959-16-16	25	1"	1.7/16"-12	19,5	85,0	13,5	57,0	41,0	PR	
6959-20-16	25	1"	1.11/16"-12	24,0	84,5	13,6	61,0	50,0	PR	
6959-20-20	31	1.1/4"	1.11/16"-12	25,0	98,5	13,6	66,0	50,0	PR	
6959-24-24	38	1.1/2"	2"-12	31,0	116,0	14,2	79,5	60,0	PR	

Muttertyp: PR = Pressad

IL Plus 45° invändig ORFS, SAE J316/ ISO 12151-1

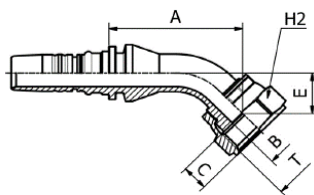

Art.nr.	Slangdim.		Gänga	Dimensioner						Mutter
	DN	Tum		T	B	A	C	E	H2	
6958-12-10	16	5/8"	1.3/16"-12	14,3	56,0	13,5	21,5	36,0	PR	
6958-12-12	19	3/4"	1.3/16"-12	14,5	69,0	13,5	21,5	36,0	PR	
6958-16-12	19	3/4"	1.7/16"-12	19,0	77,5	13,5	25,0	41,0	PR	
6958-16-16	25	1"	1.7/16"-12	19,5	86,0	13,5	24,0	41,0	PR	
6958-20-20	31	1.1/4"	1.11/16"-12	25,0	97,0	13,6	27,0	50,0	PR	
6958-24-24	38	1.1/2"	2"-12	31,0	112,0	14,2	31,5	60,0	PR	

Muttertyp: PR = Pressad

IL Plus Rak SAE fläns, 3000 PSI, SAE J516/ ISO 12151-3

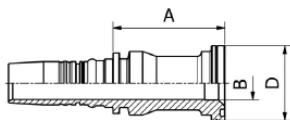

Art.nr.	Slangdim.		Fläns Tum	Fläns Tum	Dimensioner						
	DN	Tum			B	A	D				
6924-16-10	16	5/8"	1"	1"	20,0	64,0	44,6				
6924-12-12	19	3/4"	3/4"	3/4"	16,0	60,0	38,0				
6924-16-12	19	3/4"	1"	1"	20,0	65,5	44,6				
6924-12-16	25	1"	3/4"	3/4"	16,0	67,0	38,0				
6924-16-16	25	1"	1"	1"	20,0	66,5	44,6				
6924-20-16	25	1"	1.1/4"	1.1/4"	26,1	73,0	51,0				
6924-20-20	31	1.1/4"	1.1/4"	1.1/4"	26,1	75,0	51,0				
6924-24-20	31	1.1/4"	1.1/2"	1.1/2"	32,1	80,0	60,5				
6924-24-24	38	1.1/2"	1.1/2"	1.1/2"	32,1	80,5	60,5				
6924-32-24	38	1.1/2"	2"	2"	42,0	88,5	71,6				
6924-32-32	51	2"	2"	2"	42,0	82,5	71,6				
6924-48-48	76	3"	3"	3"	62,5	101,0	101,6				

IL Plus 90° Fläns, 3000 PSI, SAE J516/ ISO 12151-3

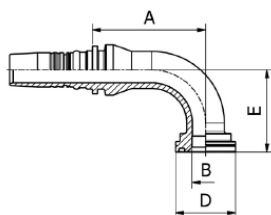

Art.nr.	Slangdim.		Fläns Tum	Fläns Tum	Dimensioner							
	DN	Tum			B	A	D	E				
6925-16-10	16	5/8"	1"	1"	20,0	71,0	44,6	52,0				
6925-12-12	19	3/4"	3/4"	3/4"	16,0	72,0	38,0	52,0				
6925-16-12	19	3/4"	1"	1"	20,0	72,5	44,6	52,0				
6925-16-16	25	1"	1"	1"	20,0	83,5	44,6	62,0				
6925-20-16	25	1"	1.1/4"	1.1/4"	26,0	83,5	51,0	62,0				
6925-20-20	31	1.1/4"	1.1/4"	1.1/4"	26,1	99,0	51,0	70,0				
6925-24-20	31	1.1/4"	1.1/2"	1.1/2"	32,1	98,5	60,5	72,0				
6925-24-24	38	1.1/2"	1.1/2"	1.1/2"	32,1	111,5	60,5	84,0				
6925-32-24	38	1.1/2"	2"	2"	42,0	111,5	71,6	84,0				
6925-32-32	51	2"	2"	2"	42,0	133,5	71,6	99,0				
6925-48-48	76	3"	3"	3"	59,0	145,0	101,6	140,0				

OBS! Andra vinkelställningar på förfrågan, kontakta Kundservice

IL Plus 45° SAE fläns, 3000 PSI, SAE J516/ ISO 12151-3

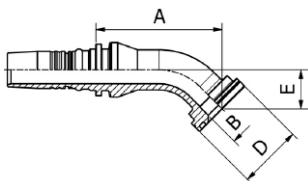

Art.nr.	Slangdim.		Fläns Tum	Dimensioner						
	DN	Tum		B	A	D	E			
6926-12-12	19	3/4"	3/4"	16,0	75,5	38,0	26,0			
6926-16-12	19	3/4"	1"	20,0	76,0	44,6	23,0			
6926-16-16	25	1"	1"	20,0	87,0	44,6	27,5			
6926-20-16	25	1"	1.1/4"	26,0	87,5	51,0	27,5			
6926-20-20	31	1.1/4"	1.1/4"	26,1	100,5	51,0	29,5			
6926-24-20	31	1.1/4"	1.1/2"	32,1	101,5	60,5	31,0			
6926-24-24	38	1.1/2"	1.1/2"	32,1	111,0	60,5	34,5			
6926-32-24	38	1.1/2"	2"	42,0	113,0	71,6	34,5			
6926-32-32	51	2"	2"	42,0	128,5	71,6	39,0			
6926-48-48	76	3"	3"	59,0	147,5	101,6	53,0			

IL Plus Rak SAE fläns, 6000 PSI, SAE J316/ ISO 12151-3

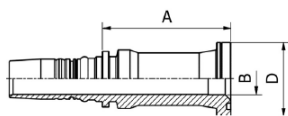

Art.nr.	Slangdim.		Fläns Tum	Dimensioner						
	DN	Tum		B	A	D	E			
6930-12-10	16	5/8"	3/4"	16,0	65,0	41,5				
6930-16-10	16	5/8"	1"	20,0	81,5	47,7				
6930-12-12	19	3/4"	3/4"	16,0	71,5	41,4				
6930-16-12	19	3/4"	1"	20,0	83,5	47,7				
6930-12-16	25	1"	3/4"	16,0	80,5	41,4				
6930-16-16	25	1"	1"	20,0	84,5	47,7				
6930-20-16	25	1"	1.1/4"	26,0	89,0	54,2				
6930-16-20	31	1.1/4"	1"	20,0	87,0	47,7				
6930-20-20	31	1.1/4"	1.1/4"	26,1	91,0	54,2				
6930-24-20	31	1.1/4"	1.1/2"	32,1	97,0	63,7				
6930-20-24	38	1.1/2"	1.1/4"	26,0	101,0	54,2				
6930-24-24	38	1.1/2"	1.1/2"	32,1	97,5	63,7				
6930-32-24	38	1.1/2"	2"	42,0	113,0	79,6				
6930-24-32	51	2"	1.1/2"	32,1	117,0	63,7				
6930-32-32	51	2"	2"	42,0	112,5	79,6				
6930-40-40	63	2.1/2"	2.1/2"	51,5	126,5	107,9				
6930-48-48	76	3"	3"	62,5	167,0	131,9				

IL Plus 90° SAE fläns 6000 PSI, SAE J516/ ISO 12151-3

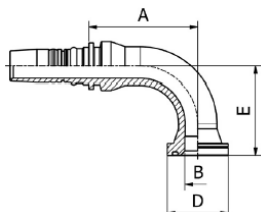

Art.nr.	Slangdim.		Fläns Tum	Dimensioner						
	DN	Tum		B	A	D	E			
6931-12-10	16	5/8"	3/4"	16,0	56,5	41,4	60,5			
6931-12-12	19	3/4"	3/4"	16,0	72,5	41,4	59,0			
6931-16-12	19	3/4"	1"	20,0	72,5	47,7	65,0			
6931-12-16	25	1"	3/4"	16,0	81,5	41,4	62,0			
6931-16-16	25	1"	1"	20,0	81,0	47,7	68,0			
6931-20-16	25	1"	1.1/4"	26,0	78,5	54,2	76,0			
6931-16-20	31	1.1/4"	1"	20,0	98,5	47,7	79,0			
6931-20-20	31	1.1/4"	1.1/4"	26,1	98,5	54,2	81,0			
6931-24-20	31	1.1/4"	1.1/2"	32,1	98,5	63,7	91,5			
6931-20-24	38	1.1/2"	1.1/4"	26,0	111,0	54,2	91,0			
6931-24-24	38	1.1/2"	1.1/2"	32,0	112,5	63,7	94,5			
6931-32-24	38	1.1/2"	2"	42,0	112,5	79,6	110,5			
6931-32-32	51	2"	2"	42,0	140,5	79,6	138,0			

IL Plus 45° SAE fläns, 6000 PSI, SAE J516/ ISO 12151-3

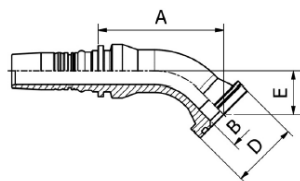

Art.nr.	Slangdim.		Fläns Tum	Dimensioner						
	DN	Tum		B	A	D	E			
6932-12-10	16	5/8"	3/4"	16,0	71,0	41,4	31,0			
6932-16-10	16	5/8"	1"	20,0	83,5	47,7	32,5			
6932-12-12	19	3/4"	3/4"	16,0	79,0	41,4	26,0			
6932-16-12	19	3/4"	1"	20,0	85,5	47,7	32,5			
6932-12-16	25	1"	3/4"	16,0	87,0	41,4	28,0			
6932-16-16	25	1"	1"	20,0	91,5	47,7	32,5			
6932-20-16	25	1"	1.1/4"	26,0	93,5	54,2	37,5			
6932-16-20	31	1.1/4"	1"	20,0	106,5	47,7	36,0			
6932-20-20	31	1.1/4"	1.1/4"	26,1	108,0	54,2	37,5			
6932-24-20	31	1.1/4"	1.1/2"	32,1	115,0	63,7	45,0			
6932-20-24	38	1.1/2"	1.1/4"	26,0	124,5	54,2	43,0			
6932-24-24	38	1.1/2"	1.1/2"	32,0	124,5	63,7	44,0			
6932-32-24	38	1.1/2"	2"	42,0	135,5	79,6	55,5			
6932-32-32	51	2"	2"	42,0	154,0	79,6	60,5			

Flänshalvor 3000 PSI (code 61), SAE J518/ ISO 6162-1

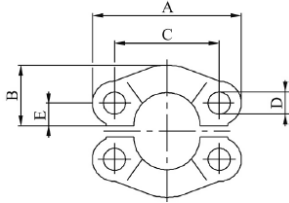

Art.nr.	Fläns		Dimensioner				
		Tum	B	A	C	D	E
05004644-08		1/2"	22,8	54,0	38,1	8,75	8,7
05004644-12		3/4"	25,9	65,0	47,6	10,75	11,1
05004644-16		1"	29,2	70,0	52,4	10,75	13,1
05004644-20		1.1/4"	36,3	79,0	58,7	12,00	15,1
05004644-24		1.1/2"	41,1	94,0	69,8	13,50	17,9
05004644-32		2"	48,2	102,0	77,8	13,50	21,4
05004644-40		2.1/2"	54,1	114,0	88,9	13,50	25,4
05004644-48		3"	65,3	135,0	106,4	16,75	31,0
05004644-56		3.1/2"	70,0	152,0	120,65	17,00	34,85
05004644-64		4"	75,0	160,0	130,2	17,00	38,9

Flänshalvor 6000 PSI (code 62), SAE J518/ISO 6162-2

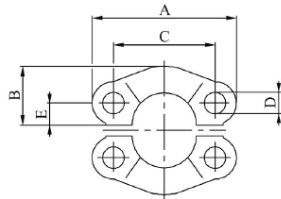

Art.nr.	Fläns		Dimensioner				
		Tum	B	A	C	D	E
05003425-08		1/2"	23,6	56,0	40,5	8,75	9,1
05003425-12		3/4"	30,0	71,0	50,8	11,00	11,9
05003425-16		1"	34,8	81,0	57,1	13,00	13,9
05003425-20		1.1/4"	38,6	95,0	66,7	15,00	15,9
05003425-24		1.1/2"	47,5	113,0	79,4	17,00	18,3
05003425-32		2"	56,9	133,0	96,8	21,00	22,2

Halfläns 3000 PSI (code 61), SAE J518/ ISO 6162-1

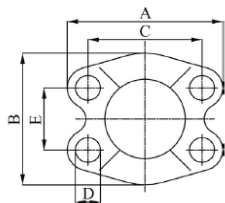

Art.nr.			Fläns	Dimensioner						
			Tum	B	A	C	D	E		
058310-12-00			3/4"	51,8	65,0	47,6	10,75	22,2		
058310-16-00			1"	58,4	70,0	52,4	10,75	26,2		
058310-20-00			1.1/4"	72,6	79,0	58,7	12,00	30,2		
058310-24-00			1.1/2"	82,2	94,0	69,8	13,50	35,7		
058310-32-00			2"	96,4	102,0	77,8	13,50	42,9		
058310-40-00			2.1/2"	108,2	114,0	88,9	13,50	50,8		
058310-48-00			3"	130,6	135,0	106,4	16,75	61,9		

Halfläns 6000 PSI (code 62), SAE J518/ ISO 6162-2

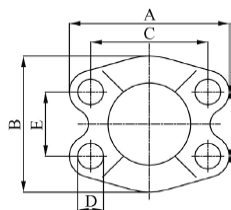

Art.nr.			Fläns	Dimensioner						
			Tum	B	A	C	D	E		
058610-12-00			3/4"	60,0	72,0	50,8	10,5	23,8		
058610-16-00			1"	70,0	81,0	57,2	13,0	27,8		
058610-20-00			1.1/4"	78,0	96,0	66,7	15,0	31,8		
058610-24-00			1.1/2"	96,0	113,0	79,4	17,0	36,5		
058610-32-00			2"	114,0	134,0	96,8	21,0	44,4		

IL Plus Rak Supercat fläns

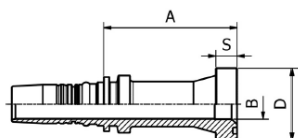

Art.nr.	Slangdim.		Fläns Tum	Dimensioner				
	DN	Tum		B	A	D	S	
6976-12-12	19	3/4"	3/4"	16,0	77,0	41,5	14,3	
6976-16-12	19	3/4"	1"	20,0	88,5	47,7	14,3	
6976-16-16	25	1"	1"	20,0	89,5	47,7	14,3	
6976-20-16	25	1"	1.1/4"	26,0	93,5	54,0	14,3	
6976-20-20	31	1.1/4"	1.1/4"	26,1	95,0	54,0	14,3	
6976-24-20	31	1.1/4"	1.1/2"	32,1	98,5	63,6	14,3	
6976-24-24	38	1.1/2"	1.1/2"	32,1	99,0	63,6	14,3	
6976-32-24	38	1.1/2"	2"	42,0	115,0	79,3	14,3	
6976-24-32	51	2"	1.1/2"	32,1	119,5	63,6	14,3	
6976-32-32	51	2"	2"	42,0	114,5	79,3	14,3	

IL Plus 90° Supercat fläns

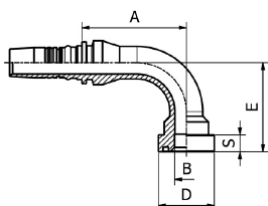

Art.nr.	Slangdim.		Fläns Tum	Dimensioner				
	DN	Tum		B	A	D	E	S
6977-12-12	19	3/4"	3/4"	16,0	72,5	41,5	64,5	14,3
6977-16-12	19	3/4"	1"	20,0	75,0	47,7	69,5	14,3
6977-16-16	25	1"	1"	20,0	88,5	47,7	76,5	14,3
6977-20-16	25	1"	1.1/4"	26,1	86,5	54,0	80,5	14,3
6977-20-20	31	1.1/4"	1.1/4"	26,1	98,5	54,0	85,0	14,3
6977-24-20	31	1.1/4"	1.1/2"	32,0	104,0	63,7	101,0	14,3
6977-24-24	38	1.1/2"	1.1/2"	32,0	112,5	63,7	96,0	14,3
6977-32-24	38	1.1/2"	2"	42,0	115,0	79,3	112,0	14,3
6977-32-32	51	2"	2"	42,0	144,0	79,3	133,5	14,3

IL Plus 45° Supercat fläns

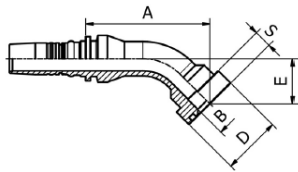

Art.nr.	Slangdim.		Fläns Tum	Dimensioner					
	DN	Tum		B	A	D	E	S	
6978-12-12	19	3/4"	3/4"	16,0	85,0	41,5	32,0	14,3	
6978-16-12	19	3/4"	1"	20,0	91,5	47,7	35,5	14,3	
6978-16-16	25	1"	1"	20,0	100,5	47,7	36,5	14,3	
6978-20-16	25	1"	1.1/4"	26,1	103,5	54,0	40,5	14,3	
6978-20-20	31	1.1/4"	1.1/4"	26,1	110,5	54,0	40,5	14,3	
6978-24-20	31	1.1/4"	1.1/2"	32,0	124,5	63,7	50,5	14,3	
6978-24-24	38	1.1/2"	1.1/2"	32,0	125,5	63,7	45,5	14,3	
6978-32-24	38	1.1/2"	2"	42,0	139,5	79,3	56,5	14,3	
6978-32-32	51	2"	2"	42,0	158,5	79,3	61,5	14,3	

SPIRALFIT skalfri presshylsa (4 inlägg)

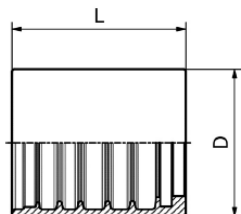

Art.nr.	Slangdim.		Dimensioner							
	DN	Tum			D	L				
6710-10	16	5/8"			40,0	44,3				
6710-12	19	3/4"			43,8	53,3				
6710-16	25	1"			52,0	64,3				
6710-20	31	1.1/4"			59,3	72,0				
6710-24	38	1.1/2"			68,5	78,0				
6710-32	51	2"			84,6	97,1				
6710-40	63	2 1/2"			97,0	116,0				
6710-48	76	3"			109,8	124,0				
6710-56	89	3.1/2"			127,7	123,5				
6710-64	102	4"			145,0	126,5				

SPIRALFIT skalfri presshylsa (4-6 inlägg)

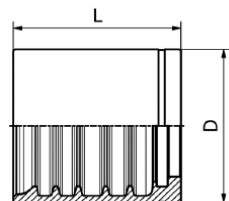

Art.nr.	Slangdim.		Dimensioner							
	DN	Tum			D	L				
6715-20	31	1.1/4"			66,0	70,0				
6715-24	38	1.1/2"			75,0	79,0				
6715-32	51	2"			90,0	98,1				

SPIRALFIT inv. BSP med o-ring, BS5200/ ISO 12151-6

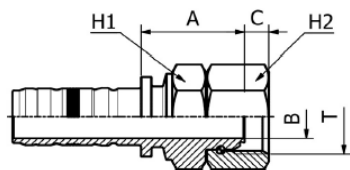

Art.nr.	Slangdim.		Gänga T	Dimensioner							Mutter
	DN	Tum		B	A	C	H1	H2			
6701-12-12	19	3/4"	3/4"-14	14,5	39,5	8,5	32,0	32,0		ST	
6701-16-12	19	3/4"	1"-11	19,5	44,0	10,6	41,0	41,0		ST	
6701-12-16	25	1"	3/4"-14	15,0	44,5	8,5	41,0	32,0		ST	
6701-16-16	25	1"	1"-11	19,5	45,5	10,6	41,0	41,0		ST	
6701-20-16	25	1"	1.1/4"-11	26,1	50,5	10,5	50,0	50,0		ST	
6701-16-20	31	1.1/4"	1"-11	19,0	48,0	10,6	50,0	41,0		ST	
6701-20-20	31	1.1/4"	1.1/4"-11	26,1	50,5	10,5	50,0	50,0		ST	
6701-24-20	31	1.1/4"	1.1/2"-11	32,1	50,0	12,5	50,0	60,0		ST	
6701-20-24	38	1.1/2"	1.1/4"-11	26,1	52,0	10,5	55,0	50,0		ST	
6701-24-24	38	1.1/2"	1.1/2"-11	32,1	52,0	12,5	60,0	60,0		ST	
6701-32-32	51	2"	2"-11	42,0	53,5	16,1	70,0	70,0		ST	

Muttertyp: Stiftad

SPIRALFIT utv. BSP 60° kona, BS5200/ ISO 12151-6

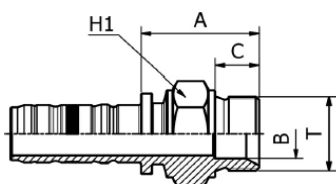

Art.nr.	Slangdim.		Gänga T	Dimensioner						
	DN	Tum		B	A	C	H1			
6702-12-12	19	3/4"	3/4"-14	16,8	43,5	16,0	32,0			
6702-16-12	19	3/4"	1"-11	22,2	49,5	19,0	41,0			
6702-16-16	25	1"	1"-11	22,2	51,0	19,0	41,0			
6702-20-16	25	1"	1.1/4"-11	28,5	56,0	20,0	50,0			
6702-20-20	31	1.1/4"	1.1/4"-11	28,5	56,5	20,0	50,0			
6702-24-24	38	1.1/2"	1.1/2"-11	33,5	60,5	22,0	55,0			
6702-32-32	51	2"	2"-11	42,0	64,0	25,0	70,0			

SPIRALFIT 90° inv. BSP med o-ring, BS5200/ ISO 12151-6

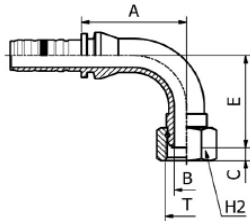

Art.nr.	Slangdim.		Gänga	Dimensioner						Mutter
	DN	Tum		T	B	A	C	E	H2	
6703-12-12	19	3/4"	3/4"-14	14,5	73,5	8,5	60,0	32,0	ST	
6703-16-12	19	3/4"	1"-11	19,5	73,5	10,6	62,0	41,0	ST	
6703-12-16	25	1"	3/4"-14	15,0	90,0	8,5	70,0	32,0	ST	
6703-16-16	25	1"	1"-11	19,5	83,0	10,6	76,0	41,0	ST	
6703-20-16	25	1"	1.1/4"-11	26,1	96,0	10,5	78,5	50,0	ST	
6703-16-20	31	1.1/4"	1"-11	19,5	90,0	10,6	76,0	41,0	ST	
6703-20-20	31	1.1/4"	1.1/4"-11	26,0	88,0	10,5	83,5	50,0	ST	
6703-24-20	31	1.1/4"	1.1/2"-11	32,0	88,0	12,5	92,0	60,0	ST	
6703-24-24	38	1.1/2"	1.1/2"-11	32,0	103,0	12,5	98,5	60,0	ST	
6703-32-32	51	2"	2"-11	42,0	135,9	16,1	140,5	70,0	ST	

Muttertyp: ST = Stiftad

SPIRALFIT 45° inv. BSP med o-ring, BS5200/ ISO 12151-6

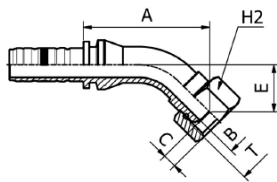

Art.nr.	Slangdim.		Gänga	Dimensioner						Mutter
	DN	Tum		T	B	A	C	E	H2	
6704-12-12	19	3/4"	3/4"-14	14,5	82,5	8,5	29,0	32,0	ST	
6704-16-12	19	3/4"	1"-11	19,5	84,0	10,6	30,0	41,0	ST	
6704-12-16	25	1"	3/4"-14	15,0	106,5	8,5	36,0	32,0	ST	
6704-16-16	25	1"	1"-11	19,5	95,0	10,6	36,5	41,0	ST	
6704-20-16	25	1"	1.1/4"-11	26,1	109,5	10,5	38,0	50,0	ST	
6704-16-20	31	1.1/4"	1"-11	19,5	102,0	10,6	36,5	41,0	ST	
6704-20-20	31	1.1/4"	1.1/4"-11	26,0	99,0	10,5	39,0	50,0	ST	
6704-24-20	31	1.1/4"	1.1/2"-11	32,0	114,0	12,5	54,0	60,0	ST	
6704-24-24	38	1.1/2"	1.1/2"-11	32,0	122,5	12,5	45,0	60,0	ST	
6704-32-32	51	2"	2"-11	42,0	155,0	16,1	66,0	70,0	ST	

Muttertyp: ST = Stiftad

SPIRALFIT Rak inv. metrisk DKOS, DIN 20066/ ISO 12151-2

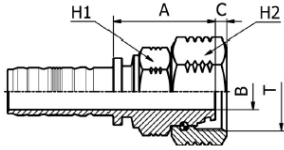

Art.nr.	Slangdim.		Gänga T	Rör mm	Dimensioner						Mutter
	DN	Tum			B	A	C	H1	H2		
6719-20-12	19	3/4"	M 30x2	20	12,5	49,5	3,2	32,0	36,0		ST
6719-25-12	19	3/4"	M 36x2	25	14,5	52,0	4,1	36,0	41,0		ST
6719-30-12	19	3/4"	M 42x2	30	19,5	52,5	6,0	41,0	50,0		ST
6719-25-16	25	1"	M 36x2	25	16,0	56,0	4,1	41,0	41,0		ST
6719-30-16	25	1"	M 42x2	30	19,5	54,5	6,0	41,0	50,0		ST
6719-38-16	25	1"	M 52x2	38	25,0	56,0	8,8	50,0	60,0		ST
6719-30-20	31	1.1/4"	M 42x2	30	19,5	56,0	6,1	46,0	50,0		ST
6719-38-20	31	1.1/4"	M 52x2	38	25,0	57,0	8,8	50,0	60,0		ST
6719-38-24	38	1.1/2"	M 52x2	38	26,1	58,0	8,8	55,0	60,0		ST

Muttertyp: ST = Stiftad

SPIRALFIT Utv. metrisk 24° kona, DIN 20066/ ISO 12151-2

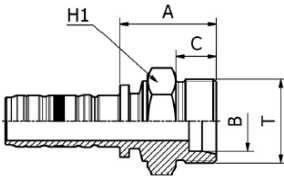

Art.nr.	Slangdim.		Gänga T	Rör mm	Dimensioner						
	DN	Tum			B	A	C	H1			
6714-20-12	19	3/4"	M 30x2	20	14,5	39,5	16,0	32,0			
6714-25-12	19	3/4"	M 36x2	25	14,5	44,5	18,0	36,0			
6714-25-16	25	1"	M 36x2	25	19,5	46,0	18,0	36,0			
6714-30-16	25	1"	M 42x2	30	19,5	47,5	20,0	46,0			
6714-38-20	31	1.1/4"	M 52x2	38	25,0	55,0	22,0	55,0			
6714-38-24	38	1.1/2"	M 52x2	38	30,5	55,5	22,0	55,0			

SPIRALFIT 90° inv. metrisk DKOS, DIN 20066/ ISO 12151-2

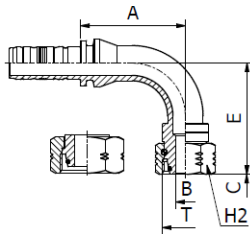

Art.nr.	Slangdim.		Gänga T	Rör mm	Dimensioner					Mutter
	DN	Tum			B	A	C	E	H2	
6748-20-12	19	3/4"	M 30x2	20	12,5	64,5	3,2	68,5	36,0	ST
6748-25-12	19	3/4"	M 36x2	25	14,5	68,0	3,4	67,5	41,0	SL
6748-25-16	25	1"	M 36x2	25	15,0	83,0	4,1	87,5	41,0	ST
6748-30-16	25	1"	M 42x2	30	19,5	82,5	5,3	75,5	50,0	SL
6748-30-20	31	1.1/4"	M 42x2	30	19,1	102,0	6,0	90,0	50,0	ST
6748-38-20	31	1.1/4"	M 52x2	38	26,1	101,0	8,0	86,5	60,0	SL

Muttertyp: ST = Stiftad, SL = Slip-on

SPIRALFIT 45° inv. metrisk DKOS, DIN 20066/ ISO 12151-2

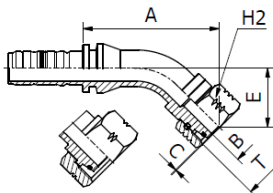

Art.nr.	Slangdim.		Gänga T	Rör mm	Dimensioner					Mutter
	DN	Tum			B	A	C	E	H2	
6749-20-12	19	3/4"	M 30x2	20	12,5	80,0	3,2	35,0	36,0	ST
6749-25-12	19	3/4"	M 36x2	25	14,5	82,0	3,4	33,5	41,0	SL
6749-25-16	25	1"	M 36x2	25	15,0	103,0	4,1	44,5	41,0	ST
6749-30-16	25	1"	M 42x2	30	19,5	94,0	5,3	36,0	50,0	SL
6749-30-20	31	1.1/4"	M 42x2	30	19,1	117,5	6,0	44,0	50,0	ST
6749-38-20	31	1.1/4"	M 52x2	38	26,1	111,0	8,0	40,0	60,0	SL

Muttertyp: ST = Stiftad, SL = Slip-on

SPIRALFIT Rak inv. JIC-gänga, SAE J516/ ISO 12151-5

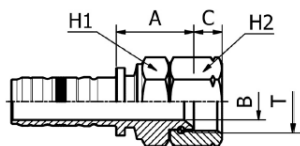

Art.nr.	Slangdim.		Gänga T	Dimensioner						Mutter
	DN	Tum		B	A	C	H1	H2		
6721-12-12	19	3/4"	1.1/16"-12	14,5	36,5	14,2	32,0	32,0	ST	
6721-16-12	19	3/4"	1.5/16"-12	19,5	36,5	15,2	32,0	41,0	ST	
6721-16-16	25	1"	1.5/16"-12	19,5	41,5	15,2	41,0	41,0	ST	
6721-20-16	25	1"	1.5/8"-12	26,1	46,5	16,2	41,0	50,0	ST	
6721-20-20	31	1.1/4"	1.5/8"-12	26,1	51,5	16,2	50,0	50,0	ST	
6721-24-20	31	1.1/4"	1.7/8"-12	32,0	54,5	18,8	55,0	60,0	ST	
6721-24-24	38	1.1/2"	1.7/8"-12	32,1	54,5	18,8	55,0	60,0	ST	
6721-32-32	51	2"	2.1/2"-12	42,0	56,0	24,0	65,0	70,0	ST	

Muttertyp: ST = Stiftad

SPIRALFIT utv. JIC-gänga, SAE J516/ ISO 12151-5

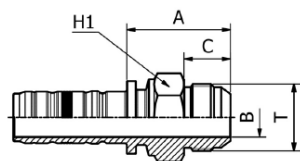

Art.nr.	Slangdim.		Gänga T	Dimensioner						
	DN	Tum		B	A	C	H1			
6722-12-12	19	3/4"	1.1/16"-12	14,5	44,5	22,0	30,0			
6722-16-16	25	1"	1.5/16"-12	19,5	51,5	23,0	38,0			
6722-20-20	31	1.1/4"	1.5/8"-12	26,1	56,0	24,3	46,0			
6722-24-24	38	1.1/2"	1.7/8"-12	32,1	60,0	27,5	50,0			
6722-32-32	51	2"	2.1/2"-12	42,0	75,5	34,0	65,0			

SPIRALFIT 90° inv. JIC-gänga, SAE J516/ ISO 12151-5

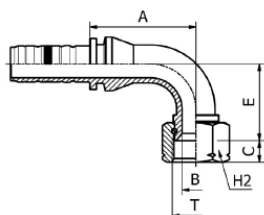

Art.nr.	Slangdim.		Gänga T	Dimensioner						Mutter
	DN	Tum		B	A	C	E	H2		
6727-12-12	19	3/4"	1.1/16"-12	14,5	67,5	14,2	47,5	32,0	ST	
6727-16-12	19	3/4"	1.5/16"-12	19,8	73,5	15,2	57,5	41,0	ST	
6727-12-16	25	1"	1.1/16"-12	14,5	76,5	14,2	47,5	32,0	ST	
6727-16-16	25	1"	1.5/16"-12	19,5	74,5	15,2	55,5	41,0	ST	
6727-20-20	31	1.1/4"	1.5/8"-12	26,0	88,0	16,2	86,5	50,0	ST	
6727-24-20	31	1.1/4"	1.7/8"-12	32,0	88,0	18,8	90,5	60,0	ST	
6727-24-24	38	1.1/2"	1.7/8"-12	32,1	105,0	18,8	101,0	60,0	ST	
6727-32-32	51	2"	2.1/2"-12	42,0	145,0	24,0	139,0	75,0	ST	

Muttertyp: ST = Stiftad

Long drop på förfrågan, kontakta Kundservice

SPIRALFIT 45° inv. JIC-gänga, SAE J516/ ISO 12151-5

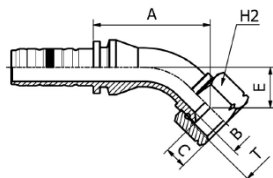

Art.nr.	Slangdim.		Gänga T	Dimensioner						Mutter
	DN	Tum		B	A	C	E	H2		
6728-12-12	19	3/4"	1.1/16"-12	14,5	75,0	14,2	22,5	32,0	ST	
6728-16-16	25	1"	1.5/16"-12	19,5	81,5	15,2	26,0	41,0	ST	
6728-20-20	31	1.1/4"	1.5/8"-12	26,0	101,0	16,2	41,4	50,0	ST	
6728-24-24	38	1.1/2"	1.7/8"-12	32,1	121,5	18,8	48,5	60,0	ST	
6728-32-32	51	2"	2.1/2"-12	42,0	162,0	24,0	63,5	75,0	ST	

Muttertyp: ST = Stiftad

SPIRALFIT Rak invändig ORFS, SAE J516/ ISO 12151-1

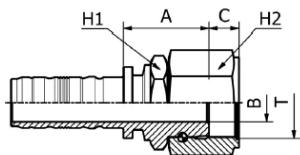

Art.nr.	Slangdim.		Gänga T	Dimensioner						Mutter
	DN	Tum		B	A	C	H1	H2		
6760-12-12	19	3/4"	1.3/16"-12	14,5	38,0	14,1	32,0	36,0	ST	
6760-16-12	19	3/4"	1.7/16"-12	19,5	42,0	15,0	41,0	46,0	ST	
6760-16-16	25	1"	1.7/16"-12	19,5	43,0	15,0	41,0	46,0	ST	
6760-20-20	31	1.1/4"	1.11/16"-12	25,0	52,5	15,1	50,0	55,0	ST	
6760-24-24	38	1.1/2"	2"-12	30,5	55,0	15,0	60,0	60,0	ST	

Muttertyp: ST= Stiftad

SPIRALFIT Rak invändig ORFS, SAE J516/ ISO 12151-1

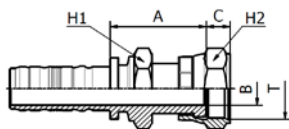

Art.nr.	Slangdim.		Gänga T	Dimensioner						Mutter
	DN	Tum		B	A	C	H1	H2		
6761-12-12	19	3/4"	1.3/16"-12	14,5	47,5	13,5	32,0	36,0	PR	
6761-16-12	19	3/4"	1.7/16"-12	19,5	49,5	13,5	36,0	41,0	PR	
6761-16-16	25	1"	1.7/16"-12	19,5	54,0	13,5	41,0	41,0	PR	
6761-20-20	31	1.1/4"	1.11/16"-12	25,0	60,0	15,3	50,0	50,0	PR	
6761-24-24	38	1.1/2"	2"-12	30,5	62,0	14,2	60,0	60,0	PR	

Muttertyp: PR = Pressad/Pullback

SPIRALFIT 90° invändig ORFS, SAE J516/ ISO 12151-1

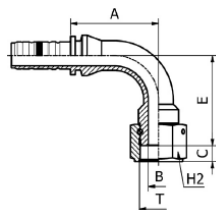

Art.nr.	Slangdim.		Gänga T	Dimensioner						Mutter
	DN	Tum		B	A	C	E	H2		
6759-12-12	19	3/4"	1.3/16"-12	14,5	73,5	14,1	70,5	36,0		ST
6759-16-12	19	3/4"	1.7/16"-12	19,5	86,0	15,0	71,0	46,0		ST
6759-12-16	25	1"	1.3/16"-12	14,5	89,5	14,1	70,5	36,0		ST
6759-16-16	25	1"	1.7/16"-12	19,5	83,0	15,0	84,5	46,0		ST
6759-20-20	31	1.1/4"	1.11/16"-12	25,0	99,0	15,1	98,0	55,0		ST
6759-24-24	38	1.1/2"	2"-12	32,0	105,0	15,0	104,0	60,0		ST
6763-12-12	19	3/4"	1.3/16"-12	14,5	58,0	9,5	48,0	36,0		PR
6763-16-16	25	1"	1.7/16"-12	19,5	86,5	13,5	63,0	41,0		PR
6763-20-20	31	1.1/4"	1.11/16"-12	25,0	95,5	15,3	66,0	50,0		PR

Muttertyp: ST = Stiftad, PR = Pressad/Pullback

Long drop på förfrågan, kontakta Kundservice

SPIRALFIT 45° invändig ORFS, SAE J516/ ISO 12151-1

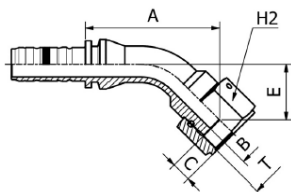

Art.nr.	Slangdim.		Gänga T	Dimensioner						Mutter
	DN	Tum		B	A	C	E	H2		
6758-12-12	19	3/4"	1.3/16"-12	14,5	90,0	14,1	36,0	36,0		ST
6758-16-12	19	3/4"	1.7/16"-12	19,5	90,5	15,0	36,5	46,0		ST
6758-16-16	25	1"	1.7/16"-12	19,5	101,0	15,0	42,5	46,0		ST
6758-20-20	31	1.1/4"	1.11/16"-12	25,0	120,0	15,1	49,5	55,0		ST
6758-24-24	38	1.1/2"	2"-12	32,0	123,5	15,0	50,5	60,0		ST
6764-12-12	19	3/4"	1.3/16"-12	14,5	70,0	13,5	21,5	36,0		PR
6764-16-16	25	1"	1.7/16"-12	19,5	89,0	13,5	27,0	41,0		PR
6764-20-20	31	1.1/4"	1.11/16"-12	25,0	94,0	15,3	27,0	50,0		PR

Muttertyp: ST = Stiftad, PR = Pressad/Pullback

SPIRALFIT Rak SAE-fläns 3000 PSI, SAE J516/ ISO 12151-3

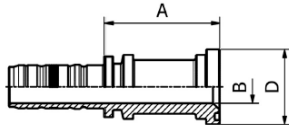

Art.nr.	Slangdim.		Fläns Tum	Dimensioner						
	DN	Tum		B	A	D				
6724-12-12	19	3/4"	3/4"	14,5	66,5	38,0				
6724-16-12	19	3/4"	1"	19,5	52,5	44,6				
6724-12-16	25	1"	3/4"	14,5	67,5	38,0				
6724-16-16	25	1"	1"	19,5	67,5	44,6				
6724-20-16	25	1"	1.1/4"	26,0	53,5	51,0				
6724-16-20	31	1.1/4"	1"	19,5	69,0	44,6				
6724-20-20	31	1.1/4"	1.1/4"	26,0	75,0	51,0				
6724-24-20	31	1.1/4"	1.1/2"	32,0	60,0	60,5				
6724-24-24	38	1.1/2"	1.1/2"	32,0	78,5	60,5				
6724-32-24	38	1.1/2"	2"	42,0	60,5	71,6				
6724-32-32	51	2"	2"	42,0	82,5	71,6				
6724-40-40	63	2.1/2"	2.1/2"	51,5	93,0	84,3				
6724-48-48	76	3"	3"	62,5	88,5	101,6				
6724-56-56	89	3.1/2"	3.1/2"	76,0	98,5	114,3				
6724-64-64	102	4"	4"	89,0	105,0	127,0				

SPIRALFIT utvärdig ORFS , SAE J516/ ISO 12151-1

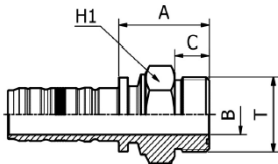

Art.nr.	Slangdim.		Gänga T	Dimensioner						
	DN	Tum		B	A	C	H1			
6757-12-12	19	3/4"	1.3/16"-12	14,5	41,0	17,0	32,0			
6757-16-16	25	1"	1.7/16"-12	19,5	46,0	17,5	41,0			
6757-20-20	31	1.1/4"	1.11/16"-12	26,0	50,5	17,5	46,0			
6757-24-24	38	1.1/2"	2"-12	32,0	53,0	17,5	55,0			

SPIRALFIT 90° SAE-fläns 3000 PSI, SAE J516/ ISO 12151-3

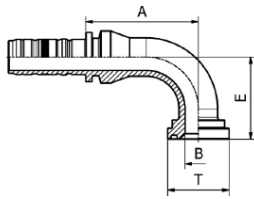

Art.nr.	Slangdim.		Fläns		Dimensioner						
	DN	Tum	Tum		B	A	T	E			
6725-12-12	19	3/4"	3/4"		16,0	72,5	38,0	58,0			
6725-16-12	19	3/4"	1"		19,5	72,5	44,6	70,0			
6725-12-16	25	1"	3/4"		16,0	85,0	38,0	58,0			
6725-16-16	25	1"	1"		19,5	82,0	44,6	60,0			
6725-20-16	25	1"	1.1/4"		26,0	82,0	51,0	68,0			
6725-16-20	31	1.1/4"	1"		19,5	86,0	44,6	60,0			
6725-20-20	31	1.1/4"	1.1/4"		26,0	85,0	51,0	67,0			
6725-24-20	31	1.1/4"	1.1/2"		32,0	85,0	60,5	69,0			
6725-24-24	38	1.1/2"	1.1/2"		32,0	96,5	60,5	81,0			
6725-32-24	38	1.1/2"	2"		42,0	101,5	71,6	84,0			
6725-32-32	51	2"	2"		42,0	135,5	71,6	120,0			
6725-40-40	63	2.1/2"	2.1/2"		49,2	128,0	84,3	118,0			
6725-48-48	76	3"	3"		59,0	144,5	101,6	140,0			
6725-56-56	89	3.1/2"	3.1/2"		73,7	164,0	114,3	160,0			

OBS! Alternativa vinkelställningar på förfrågan, kontakta Kundservice

SPIRALFIT 45° SAE-fläns 3000 PSI, SAE J516/ ISO 12151-3

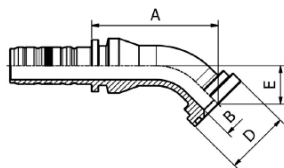

Art.nr.	Slangdim.		Fläns Tum	Dimensioner							
	DN	Tum		B	A	D	E				
6726-12-12	19	3/4"	3/4"	16,0	78,0	38,0	24,5				
6726-16-12	19	3/4"	1"	19,5	78,0	44,6	24,5				
6726-12-16	25	1"	3/4"	16,0	90,5	38,0	24,5				
6726-16-16	25	1"	1"	19,5	86,5	44,6	26,5				
6726-20-16	25	1"	1.1/4"	26,0	92,0	51,0	32,0				
6726-16-20	31	1.1/4"	1"	19,5	90,5	44,6	26,5				
6726-20-20	31	1.1/4"	1.1/4"	26,0	87,5	51,0	29,0				
6726-24-20	31	1.1/4"	1.1/2"	32,0	88,5	60,5	30,0				
6726-24-24	38	1.1/2"	1.1/2"	32,0	102,5	60,5	38,0				
6726-32-24	38	1.1/2"	2"	42,0	102,5	71,6	38,0				
6726-32-32	51	2"	2"	42,0	143,5	71,6	52,0				
6726-40-40	63	2.1/2"	2.1/2"	49,2	131,0	84,3	44,5				
6726-48-48	76	3"	3"	59,0	147,0	101,6	53,0				

SPIRALFIT Rak SAE-fläns 6000 PSI, SAE J516/ ISO 12151-3

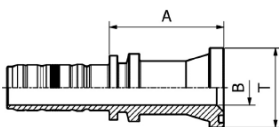

Art.nr.	Slangdim.		Fläns Tum	Dimensioner						
	DN	Tum		B	A	T				
6730-12-12	19	3/4"	3/4"	14,5	53,5	41,4				
6730-16-12	19	3/4"	1"	19,5	59,5	47,7				
6730-12-16	25	1"	3/4"	16,0	62,5	41,4				
6730-16-16	25	1"	1"	19,5	63,5	47,7				
6730-20-16	25	1"	1.1/4"	26,0	70,0	54,2				
6730-16-20	31	1.1/4"	1"	19,5	62,0	47,7				
6730-20-20	31	1.1/4"	1.1/4"	26,0	66,0	54,2				
6730-24-20	31	1.1/4"	1.1/2"	32,0	74,5	63,7				
6730-20-24	38	1.1/2"	1.1/4"	26,0	66,5	54,2				
6730-24-24	38	1.1/2"	1.1/2"	32,0	74,5	63,7				
6730-32-24	38	1.1/2"	2"	42,0	88,5	79,6				
6730-24-32	51	2"	1.1/2"	32,0	91,5	63,7				

SPIRALFIT 90° SAE-fläns 6000 PSI, SAE J516/ ISO 12151-3

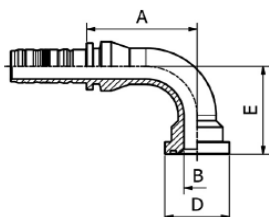

Art.nr.	Slangdim.		Fläns Tum	Fläns Tum	Dimensioner						
	DN	Tum			B	A	D	E			
6731-12-12	19	3/4"	3/4"		16,0	72,5	41,4	59,0			
6731-16-12	19	3/4"	1"		19,5	72,6	47,7	65,0			
6731-12-16	25	1"	3/4"		16,0	82,0	41,4	62,0			
6731-16-16	25	1"	1"		19,5	82,0	47,7	68,0			
6731-20-16	25	1"	1.1/4"		26,0	82,0	54,2	90,0			
6731-16-20	31	1.1/4"	1"		19,5	86,0	47,7	68,0			
6731-20-20	31	1.1/4"	1.1/4"		26,0	85,0	54,2	90,0			
6731-24-20	31	1.1/4"	1.1/2"		32,0	85,0	63,7	104,0			
6731-20-24	38	1.1/2"	1.1/4"		26,0	99,0	54,2	90,0			
6731-24-24	38	1.1/2"	1.1/2"		32,0	98,0	63,7	104,0			
6731-32-24	38	1.1/2"	2"		42,0	98,0	79,6	138,0			
6731-32-32	51	2"	2"		42,0	139,0	79,6	138,0			

SPIRALFIT 45° SAE-fläns 6000 PSI, SAE J516/ ISO 12151-3

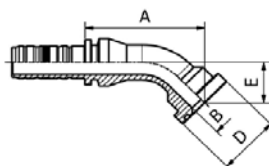

Art.nr.	Slangdim.		Fläns Tum	Fläns Tum	Dimensioner						
	DN	Tum			B	A	D	E			
6732-12-12	19	3/4"	3/4"		16,0	81,5	41,4	28,0			
6732-16-12	19	3/4"	1"		19,5	85,5	47,7	32,5			
6732-12-16	25	1"	3/4"		16,0	87,5	41,4	28,0			
6732-16-16	25	1"	1"		19,5	92,0	47,7	32,5			
6732-20-16	25	1"	1.1/4"		26,0	97,0	54,2	37,0			
6732-16-20	31	1.1/4"	1"		19,5	95,5	47,7	31,5			
6732-20-20	31	1.1/4"	1.1/4"		26,0	96,5	54,2	38,0			
6732-24-20	31	1.1/4"	1.1/2"		32,0	104,5	63,7	44,5			
6732-20-24	38	1.1/2"	1.1/4"		26,0	110,5	54,2	38,0			
6732-24-24	38	1.1/2"	1.1/2"		32,0	109,5	63,7	44,0			
6732-32-24	38	1.1/2"	2"		42,0	121,5	79,6	56,0			
6732-32-32	51	2"	2"		42,0	148,0	79,6	59,0			

OBS! Alternativa vinkelställningar på förfrågan, kontakta Kundservice

Flänshalvor 3000 PSI (code 61), SAE J518/ ISO 6162-1

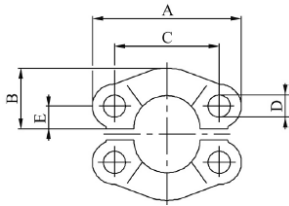

Art.nr.			Fläns	Dimensioner						
			Tum	B	A	C	D	E		
05004644-08			1/2"	22,8	54,0	38,1	8,75	8,7		
05004644-12			3/4"	25,9	65,0	47,6	10,75	11,1		
05004644-16			1"	29,2	70,0	52,4	10,75	13,1		
05004644-20			1.1/4"	36,3	79,0	58,7	12,00	15,1		
05004644-24			1.1/2"	41,1	94,0	69,8	13,50	17,9		
05004644-32			2"	48,2	102,0	77,8	13,50	21,4		
05004644-40			2.1/2"	54,1	114,0	88,9	13,50	25,4		
05004644-48			3"	65,3	135,0	106,4	16,75	31,0		
05004644-56			3.1/2"	70,0	152,0	120,65	17,00	34,85		
05004644-64			4"	75,0	160,0	130,2	17,00	38,9		

Flänshalvor 6000 PSI (code 62), SAE J518/ISO 6162-2

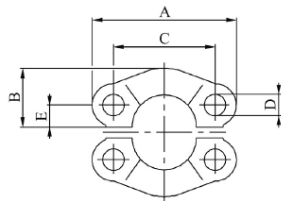

Art.nr.			Fläns	Dimensioner						
			Tum	B	A	C	D	E		
05003425-08			1/2"	23,6	56,0	40,5	8,75	9,1		
05003425-12			3/4"	30,0	71,0	50,8	11,00	11,9		
05003425-16			1"	34,8	81,0	57,1	13,00	13,9		
05003425-20			1.1/4"	38,6	95,0	66,7	15,00	15,9		
05003425-24			1.1/2"	47,5	113,0	79,4	17,00	18,3		
05003425-32			2"	56,9	133,0	96,8	21,00	22,2		

Halfläns 3000 PSI (code 61), SAE J518/ ISO 6162-1

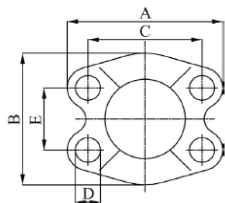

Art.nr.			Fläns	Dimensioner						
			Tum	B	A	C	D	E		
058310-12-00			3/4"	51,8	65,0	47,6	10,75	22,2		
058310-16-00			1"	58,4	70,0	52,4	10,75	26,2		
058310-20-00			1.1/4"	72,6	79,0	58,7	12,00	30,2		
058310-24-00			1.1/2"	82,2	94,0	69,8	13,50	35,7		
058310-32-00			2"	96,4	102,0	77,8	13,50	42,9		
058310-40-00			2.1/2"	108,2	114,0	88,9	13,50	50,8		
058310-48-00			3"	130,6	135,0	106,4	16,75	61,9		
058310-56-00			3.1/2"	139,0	152,0	120,6	17,00	69,8		
058310-64-00			4"	152,0	162,0	130,2	17,00	77,8		

Halfläns 6000 PSI (code 62), SAE J518/ ISO 6162-2

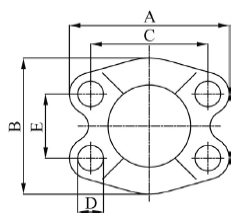

Art.nr.			Fläns	Dimensioner						
			Tum	B	A	C	D	E		
058610-12-00			3/4"	60,0	72,0	50,8	10,5	23,8		
058610-16-00			1"	70,0	81,0	57,2	13,0	27,8		
058610-20-00			1.1/4"	78,0	96,0	66,7	15,0	31,8		
058610-24-00			1.1/2"	96,0	113,0	79,4	17,0	36,5		
058610-32-00			2"	114,0	134,0	96,8	21,0	44,4		

SPIRALFIT Rak Supercat fläns

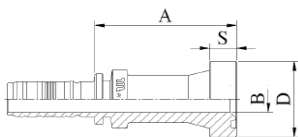

Art.nr.	Slangdim.		Fläns Tum	Dimensioner					
	DN	Tum		B	A	D	S		
6776-12-12	19	3/4"	3/4"	14,5	75,0	41,5	14,3		
6776-16-12	19	3/4"	1"	19,5	80,5	47,7	14,3		
6776-16-16	25	1"	1"	19,5	80,0	47,7	14,3		
6776-20-16	25	1"	1.1/4"	26,0	84,0	54,0	14,3		
6776-20-20	31	1.1/4"	1.1/4"	26,0	80,5	54,0	14,3		
6776-24-20	31	1.1/4"	1.1/2"	32,0	84,0	63,6	14,3		
6776-24-24	38	1.1/2"	1.1/2"	32,0	84,5	63,6	14,3		
6776-32-24	38	1.1/2"	2"	42,0	107,5	79,6	14,3		
6776-24-32	51	2"	1.1/2"	32,0	95,5	63,6	14,3		
6776-32-32	51	2"	2"	42,0	110,5	79,3	14,3		

SPIRALFIT 90° Supercat fläns

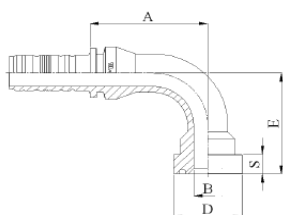

Art.nr.	Slangdim.		Fläns Tum	Dimensioner					
	DN	Tum		B	A	D	E	S	
6777-12-12	19	3/4"	3/4"	16,0	76,0	41,5	68,5	14,3	
6777-16-12	19	3/4"	1"	19,5	76,0	47,7	69,5	14,3	
6777-16-16	25	1"	1"	19,5	82,0	47,7	73,5	14,3	
6777-20-16	25	1"	1.1/4"	26,0	82,0	54,0	78,5	14,3	
6777-20-20	31	1.1/4"	1.1/4"	26,0	94,0	54,0	82,0	14,3	
6777-24-20	31	1.1/4"	1.1/2"	32,0	85,0	63,7	92,0	14,3	
6777-24-24	38	1.1/2"	1.1/2"	32,0	98,0	63,7	96,0	14,3	
6777-32-24	38	1.1/2"	2"	42,0	98,0	79,3	112,0	14,3	
6777-32-32	51	2"	2"	42,0	136,0	79,3	133,5	14,3	

Long drop på förfrågan, kontakta Kundservice

OBS! Alternativa vinkelställningar på förfrågan, kontakta Kundservice

SPIRALFIT 45° Supercat fläns

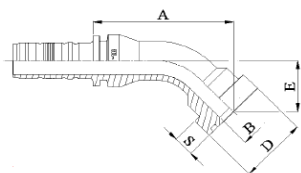

Art.nr.	Slangdim.		Fläns Tum	Dimensioner					
	DN	Tum		B	A	D	E	S	
6778-12-12	19	3/4"	3/4"	16,0	91,5	41,5	34,5	14,3	
6778-16-12	19	3/4"	1"	19,5	92,0	47,7	35,5	14,3	
6778-16-16	25	1"	1"	19,5	98,0	47,7	36,5	14,3	
6778-20-16	25	1"	1.1/4"	26,0	101,0	54,0	40,5	14,3	
6778-20-20	31	1.1/4"	1.1/4"	26,0	109,0	54,0	40,0	14,3	
6778-24-20	31	1.1/4"	1.1/2"	32,0	106,0	63,7	46,0	14,3	
6778-24-24	38	1.1/2"	1.1/2"	32,0	111,0	63,7	45,5	14,3	
6778-32-24	38	1.1/2"	2"	42,0	122,0	79,3	56,5	14,3	
6778-32-32	51	2"	2"	42,0	150,5	79,3	61,5	14,3	

Pushlock Rak inv. BSP, 60° kona, BS5200/ ISO 12151-6

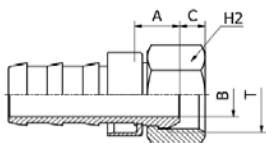

Art.nr.	Slangdim.		Gänga	Dimensioner						
	DN	Tum	T	B	A	C	H2		Mutter	
350-04-04	6	1/4"	1/4"-19	4,0	12,5	5,8	19,0		SL	
350-06-06	10	3/8"	3/8"-19	7,0	15,0	6,2	22,0		SL	
350-08-08	12	1/2"	1/2"-14	9,5	16,5	6,5	27,0		SL	
350-12-12	19	3/4"	3/4"-14	16,0	18,0	9,0	32,0		SL	

Muttertyp: SL = Slip-on

Pushlock Rak utv. BSP, 60° kona, BS5200/ ISO 8434-6

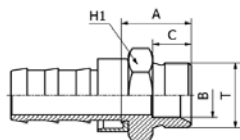

Art.nr.	Slangdim.		Gänga	Dimensioner						
	DN	Tum	T	B	A	C	H1			
351-04-04	6	1/4"	1/4"-19	5,0	20,5	11,0	19,0			
351-06-06	10	3/8"	3/8"-19	8,0	23,0	12,0	22,0			
351-08-08	12	1/2"	1/2"-14	11,0	27,0	14,0	27,0			
351-12-12	19	3/4"	3/4"-14	17,0	30,5	16,0	32,0			

Pushlock 90° inv. BSP, 60° kona, BS5200/ ISO 12151-6

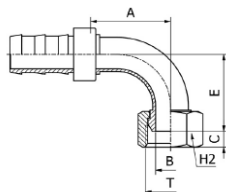

Art.nr.	Slangdim.		Gänga	Dimensioner						
	DN	Tum	T	B	A	C	E	H2	Mutter	
7001-04-04	6	1/4"	1/4"-19	4,0	26,0	5,8	24,0	19,0	SL	
7001-06-06	10	3/8"	3/8"-19	7,0	35,0	6,2	30,5	22,0	SL	
7001-08-08	12	1/2"	1/2"-14	9,5	38,0	6,5	38,5	27,0	SL	
7001-12-12	19	3/4"	3/4"-14	16,0	48,5	9,0	46,5	32,0	SL	

Muttertyp: SL = Slip-on

45° koppling (art.nr. 7000) och andra dimensioner på förfrågan.

ROTOFIT vridbar förbindning



Teknisk data					
Storlek			Arbetsstryck		
			MF2000	Interlock Plus	Spiralfit
DN	Dash	Tum	MPa	MPa	MPa
6	-04	1/4"	42	-	-
10	-06	3/8"	42	-	-
12	-08	1/2"	42	-	-
16	-10	5/8"	42	-	-
19	-12	3/4"	35	42	42
25	-16	1"	35	42	42
31	-20	1.1/4"	35	42	42
38	-24	1.1/2"	28	42	42
51	-32	2"	21	-	-
63	-40	2.1/2"	14	-	-

Produktbeskrivning

- > Vridbar förbindning konstruerad för att eliminera vridbelastning hos slangar p.g.a externt moment
- > Förhindrar att förbindningar lossnar
- > Fullflödes konstruktion minimerar tryckfall
- > Stort antal kulor minimerar friktion vid vridningar

Rotationsvinkel: Upp till 40°

Rotationsfrekvens: Upp till 15 vridningar per minut

Material: Kropp i stål med härdade ytor vid de mest utsatta punkterna
Kulor i 100Cr6 härdade och tätningar av NBR eller Polyuretan
(På förfrågan Viton, EPDM eller alternativt material)

Arbets temperatur: Från -30° till +110° C
För andra temperaturområden kan kopplingen monteras med speciella tätningar

Säkerhetsfaktor: 4:1 för dynamiskt tryck

Impulstryck: 500.000 cykler vid 120% av angivet tryck (frekvens 1 Hz)

Testmetod: ISO 18899

ROTOFIT inv. BSP med o-ring, BS5200/ ISO 12151-6

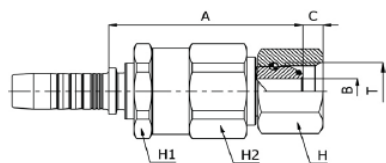

Art.nr.	Slangdim.		Gänga T	Arb.tr MPa	Dimensioner						
	DN	Tum			B	A	C	H	H1	H2	Mutter
4590-04-01	6	1/4"	1/4"-19	42	4,3	58,0	4,1	19,0	24,0	24,0	ST
4590-06-01	10	3/8"	3/8"-19	42	7,0	59,4	5,9	22,0	27,0	27,0	ST
4590-08-01	12	1/2"	1/2"-14	42	9,3	62,4	6,5	27,0	32,0	32,0	ST
4590-12-01	19	3/4"	3/4"-14	35	15,0	70,8	8,5	32,0	41,0	41,0	ST
4590-16-01	25	1"	1"-11	35	19,8	81,0	10,6	38,0	50,0	50,0	ST

Muttertyp: ST = Stiftad

ROTOFIT utv. BSP, 60° kona, BS5200/ ISO 8434-6

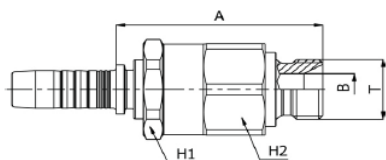

Art.nr.	Slangdim.		Gänga T	Arb.tr MPa	Dimensioner						
	DN	Tum			B	A	H1	H2			
4590-04-02	6	1/4"	1/4"-19	42	4,7	57,7	24,0	24,0			
4590-06-02	10	3/8"	3/8"-19	42	8,0	58,2	27,0	27,0			
4590-08-02	12	1/2"	1/2"-14	42	11,0	61,6	32,0	32,0			
4590-12-02	19	3/4"	3/4"-14	35	16,7	71,0	41,0	41,0			
4590-16-02	25	1"	1"-11	35	22,2	83,0	50,0	50,0			
4590-20-02	31	1.1/4"	1.1/4"-11	35	28,6	91,9	60,0	60,0			
4590-24-02	38	1.1/2"	1.1/2"-11	28	33,3	105,1	70,0	70,0			

Andra typer och utförande på förfrågan, kontakta Kundservice

ROTOFIT invändig JIC-gänga, 37° kona

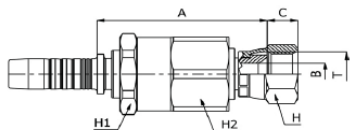

Art.nr.	Slangdim.		Gänga T	Arb.tr MPa	Dimensioner						
	DN	Tum			B	A	C	H	H1	H2	Mutter
4590-06-21	10	3/8"	9/16"-18	35	7,0	56,0	9,5	17,0	27,0	27,0	PR
4590-08-21	12	1/2"	3/4"-16	35	9,3	59,9	10,7	22,0	32,0	32,0	PR
4590-09-21	12	1/2"	7/8"-14	35	11,3	61,9	12,5	25,0	32,0	32,0	PR
4590-12-21	19	3/4"	1.1/16"-12	35	15,0	68,3	14,1	32,0	41,0	41,0	PR
4590-16-21	25	1"	1.5/16"-12	28	19,8	79,8	15,3	38,0	50,0	50,0	PR

Muttertyp: PR = Pressad

ROTOFIT invändig DKOL 24° kona, DIN 20066/ ISO 12151-2

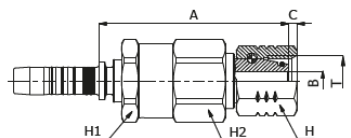

Art.nr.	Slangdim.		Gänga T	Arb.tr MPa	Dimensioner						
	DN	Tum			B	A	C	H	H1	H2	Mutter
4590-10-53	6	1/4"	M 16x1,5	35	6,0	63,2	3,0	19,0	24,0	24,0	ST
4590-12-53	10	3/8"	M 18x1,5	33	7,0	65,3	2,9	22,0	27,0	27,0	ST
4590-18-53	16	5/8"	M 26x1,5	25	12,5	72,3	2,3	32,0	36,0	36,0	ST

Muttertyp: ST = Stiftad

ROTOFIT invändig DKOS 24° kona, DIN 20066/ ISO 12151-2

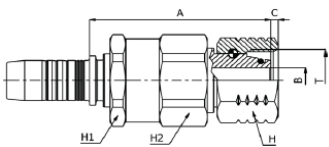

Art.nr.	Slangdim.		Gänga T	Arb.tr MPa	Dimensioner						
	DN	Tum			B	A	C	H	H1	H2	Mutter
4590-20-19	19	3/4"	M 30x2	35	12,5	79,8	3,2	36,0	41,0	41,0	ST

Muttertyp: ST = Stiftad

Andra typer och utförande på förfrågan, kontakta Kundservice